

AREA: <i>KKT-N</i>	GRID SQUARE (S): <i>201C16</i> <i>201C17</i>	GRID CO-ORDINATES: <i>E</i> <i>N</i>	INITIALS & DATE: <i>SAER</i> <i>12/11/2012</i>	FEATURE No.: <i>33516</i>
-----------------------	--	--	--	------------------------------

FEATURE TYPE (For example <u>wall</u> , staircase, bench, foundation structure, platform etc.): <i>wall</i>	Full extent visible in plan: YES / NO
--	---

1. Dimensions (in metres)	Length: <i>8.01 m</i>	Width: <i>1.02 m</i>	Height: <i>0.05 m</i>
2. Type of material(s) used	<i>mudbrick</i>		
3. Coursing (form of construction)	<i>three courses</i>		
4. Orientation	<i>E-W</i>		
5. Associated collapse	—		
6. Cut & fill feature #'s	—		
7. Repaired?	—		
8. Associated floors	—		
9. Surface treatments? E.g. plaster, paint, mouldings	—		
10. Size of one component	<i>0.40 m X 0.20 m X 0.01 m</i>		
11. Bonding material	<i>sandy silt</i>		
12. Excavated	Yes/No <i>Not excavated</i>		

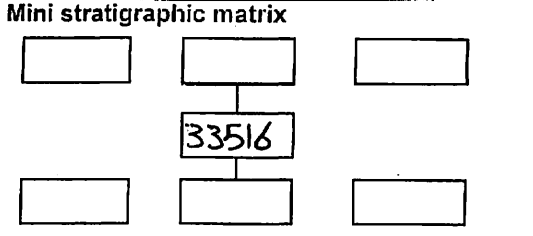

Abuts:	Same as:
Abutted by:	Associated features:
Bonded into:	
Contiguous with:	

Discussion and interpretation:
E-W mudbrick wall to the south of house (C), it consists of three courses irregular between headers and stretcher

Remember: do not just draw the architectural feature in isolation. Show how it relates to surrounding features and include details of surface treatments, repairs/modifications/damage, bonding material(s), and associated cuts. Annotate all aspects of the feature or use a Drawing Key. Measurements must be included for all aspects of the feature and surrounding features.

Sketch Plan - Include grid co-ordinates, North arrow, and elevations.

TBM 26.47
 BS 0.29
 Loc 26.76 mASL
 T FS RL
 16 2.68 24.08 mASL

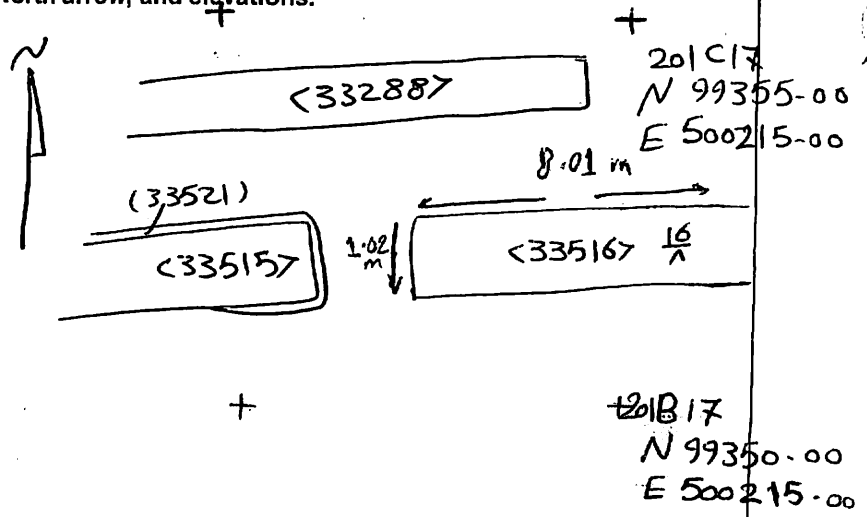

Profile Sketch - State direction the elevation of the feature being drawn is facing e.g. 'West Facing Elevation of Feature If feature was drawn in section then include the grid co-ordinates and elevations.

Drawing No.'s: 2012-1	Photo No.'s: 512796
Space No.:	Structure No.:
Matrix Group:	Matrix Phase: 6
Samples taken:	