

GIZA PLATEAU MAPPING PROJECT

54

Grid Square(s) KI-E22	Area MVT-E	Context Type deposit	Central Coords	Context 33618
DEPOSIT				CUT
1. Compaction	1. loose mod			1. Shape in plan
2. Colour	2. mid yellowish grey			2. Corners
3. Composition/Particle Size (Over 10%)	3. mud Brick frags mixed with sand			3. Dimension/Depth
4. Inclusions (Under 10%) occa / mod / freq	4. OCCA pottery sherd, V-OCCA Basalt frags			4. Break of slope-top
5. Thickness and extent	5. 1.74m (N-S) x 2.00m (E-W) x 0.24m thickness			5. Sides
6. Top and bottom boundaries	6. Clear top and bottom			6. Break of slope-base
7. Other comments	7. -			7. Base
8. Method and conditions	8. Trowel, sunny			8. Orientation

Type of feature: **mud Brick collapse**

Stratigraphic Matrix

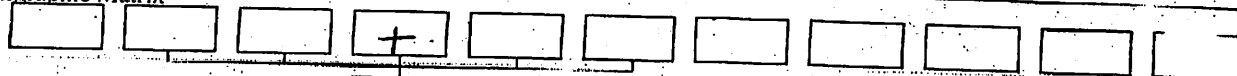

This context is

33618

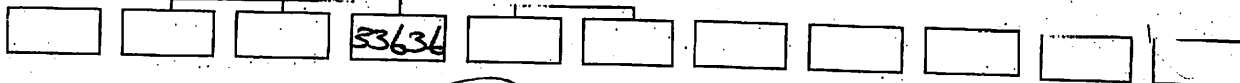

Your interpretation:

Internal

External

Structural

Other (specify)

Your discussion:

*mud Brick tumble possibly from the southern wall of
Came way wall <33361>. This mud Brick tumble
located to the south of wall <33361>*

Placement in square

Sondage F (Southern Extension)

*Note: only EXcavated in southern Extension
of sondage F*

Context same as:

See contexts:

Site Book Refs:

Matrix phase:

Initials and date

HMM, AZZ 15 II 2012

Checked Interpretation:

Provisional period

Group/Phase

Initials and date

WNL of

Context Number
(33618)

GPMP
2012

Ceramics
2012-914

Bag Numbers
Objects
2012-908

Environmental Samples & Type

Exotics

Charcoal

Bones

Other

Lithics

Photographs

512919, 512920

Drawings

Plans
(33618)

Sections

Top Elevation
18.59

Bottom Elevations
18.01

Sketch Plan

TBM 19.75
BS 1.09
Loc 20.84

R1

- * 18.59
- * 18.51
- * 18.38
- * 18.01

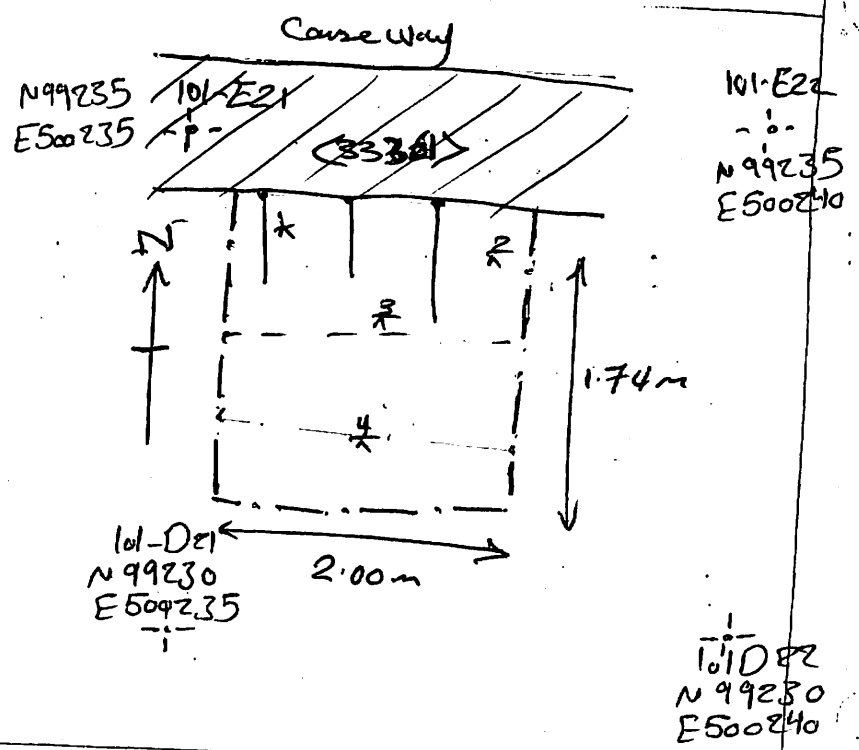

101-D22
N99230
E500240