

AREA: MVT-E	GRID SQUARE (S): 101-J22	GRID CO-ORDINATES: E N	INITIALS & DATE: HRA 14 II 2012	FEATURE No.: <33621>
----------------	-----------------------------	------------------------------	---------------------------------------	-------------------------

FEATURE TYPE (For example wall, staircase, bench, foundation structure, platform etc.): <i>curved wall</i>	Full extent visible in plan: <i>YES / NO</i>
---	---

1. Dimensions (in metres)	Length: <i>(NW-SE) 2.60 M</i>	Width: <i>0.20 M</i>	Height: <i>0.19 M</i>
---------------------------	-------------------------------	----------------------	-----------------------

2. Type of material(s) used	<i>Mudbrick - silt.</i>
-----------------------------	-------------------------

3. Coursing (form of construction)	<i>2 are coursing / stretchers</i>
------------------------------------	---

4. Orientation	<i>semi-circular N/S.</i>
----------------	---------------------------

5. Associated collapse	<i>—</i>
------------------------	----------

6. Cut & fill feature #'s	<i>— (33626) + (33625).</i>
---------------------------	-----------------------------

7. Repaired?	<i>—</i>
--------------	----------

8. Associated floors	<i>(33625)</i>
----------------------	----------------

9. Surface treatments? E.g. plaster, paint, mouldings	<i>length 0.30 M / width 0.20 M / Height 0.12 M</i>
---	---

10. Size of one component	<i>0.30 M length x 0.20 M width x 0.12 M height</i>
---------------------------	---

11. Bonding material	<i>sandy silt</i>
----------------------	-------------------

12. Excavated	Yes/No <i>✓</i>
---------------	--------------------

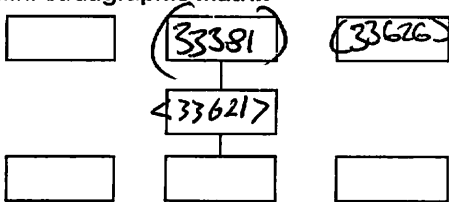
Mini stratigraphic matrix 	Abuts: <32907> Same as: Abutted by: Associated features: Bonded into: (33620) Contiguous with:
--	---

Discussion and interpretation:

Curved wall represented semi circular shape maybe it is bin to the east of north-south mudbrick wall <32907>

DISTURBANCE DIMENSIONS MAY INDICATE FULL ORIGINAL (SEE RECORDS)

File 2 J

Remember: do not just draw the architectural feature in isolation. Show how it relates to surrounding features and include details of surface treatments, repairs/modifications/damage, bonding material(s), and associated cuts. Annotate all aspects of the feature or use a Drawing Key. Measurements must be included for all aspects of the feature and surrounding features.

Sketch Plan - Include grid co-ordinates, North arrow, and elevations.

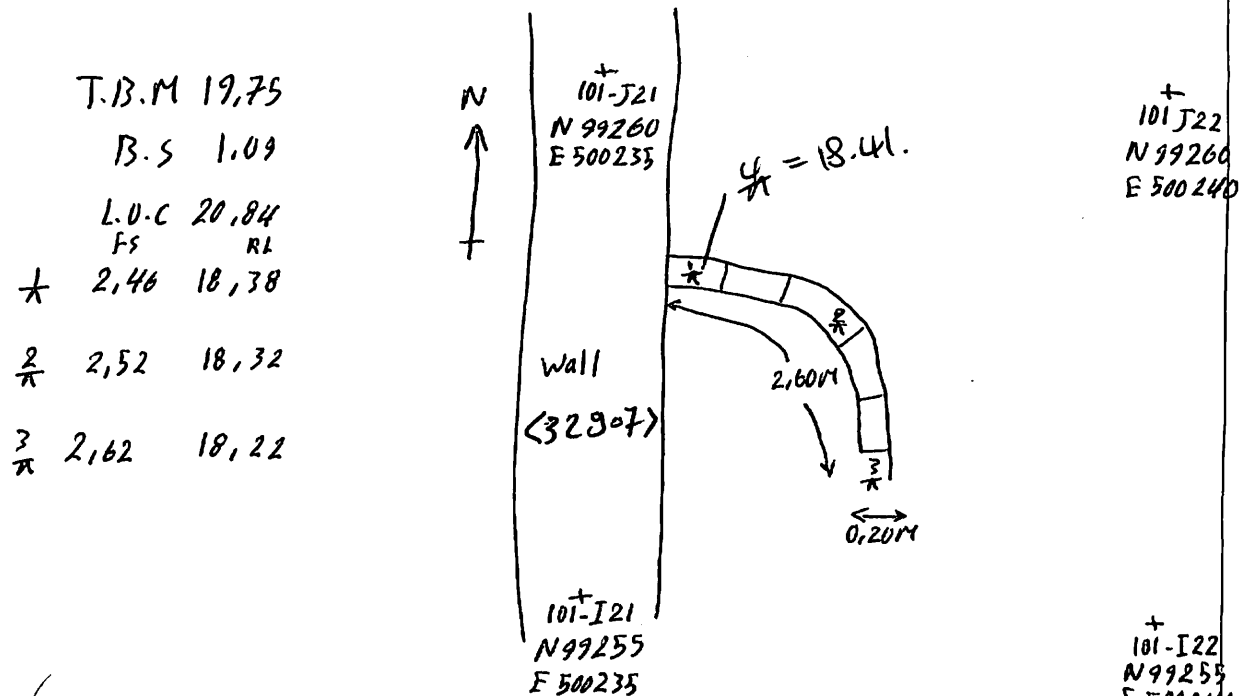

Profile Sketch - State direction the elevation of the feature being drawn is facing e.g. 'West Facing Elevation of Feature If feature was drawn in section then include the grid co-ordinates and elevations.

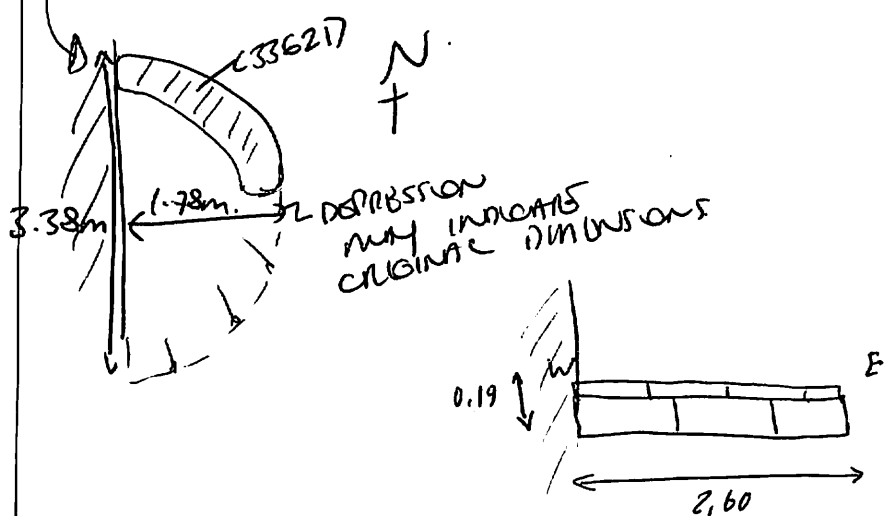

Drawing No.'s: 336217 2012-86	Photo No.'s: 512931 to 933
Space No.:	Structure No.:
Matrix Group:	Matrix Phase:
Samples taken:	