

AREA: MFB	GRID SQUARE (S): 01-M20 N20	GRID CO-ORDINATES: E N	INITIALS & DATE: 18/17 AMF	FEATURE No.: 33652
--------------	-----------------------------------	------------------------------	-------------------------------	-----------------------

FEATURE TYPE (For example wall, staircase, bench, foundation structure, platform etc.): STAIRCASE	Full extent visible in plan: YES / <input checked="" type="radio"/> NO
--	---

1. Dimensions (in metres)	Length: 1.78m (N-S)	Width: 0.60m to S 0.49m to N	Height: 0.62m
---------------------------	------------------------	------------------------------------	------------------

2. Type of material(s) used	SUM + RG MD-BRICK
-----------------------------	-------------------

3. Coursing (form of construction)	5 STEPS - HEADERS. (RG COURSED)
------------------------------------	---------------------------------

4. Orientation	N-S
----------------	-----

5. Associated collapse	33732
------------------------	-------

6. Cut & fill feature #'s	UNSEEN
---------------------------	--------

7. Repaired?	u
--------------	---

8. Associated floors	u
----------------------	---

9. Surface treatments? E.g. plaster, paint, mouldings	PLASTER - 33648
---	-----------------

10. Size of one component	(A) 310m x 160m x 90m (B) 380m x 180m x ?
---------------------------	--

11. Bonding material	MD GRAY-BROWN SM. AND GRAVEL MD STRONG SALT w/ COCA-MON
----------------------	--

12. Excavated	Yes/NO
---------------	--------

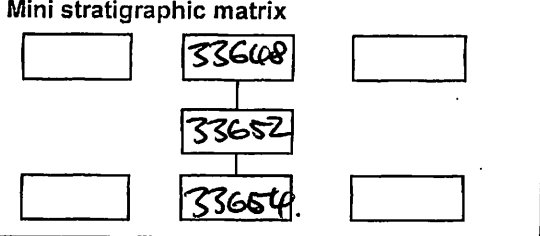

Abuts: Same as:  
 Abutted by:  
 Bonded into:  
 Contiguous with: 33634

Associated features:  
33649

Discussion and interpretation:  
 MB STEPS - AS PART OF GROUP 18068.

Remember: do not just draw the architectural feature in isolation. Show how it relates to surrounding features and include details of surface treatments, repairs/modifications/damage, bonding material(s), and associated cuts. Annotate all aspects of the feature or use a Drawing Key. Measurements must be included for all aspects of the feature and surrounding features.

Sketch Plan - Include grid co-ordinates, North arrow, and elevations.

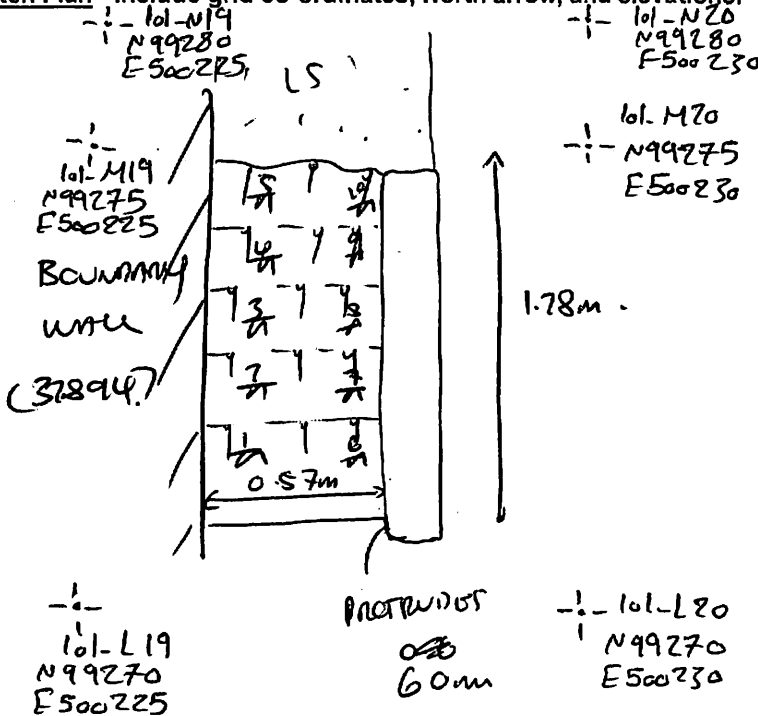

π	N	Elevation
1	18.57	6.18.58
2	18.66	7.18.66
3	18.75	8.18.75
4	18.84	9.18.84
5	19.00	10.19.01

Profile Sketch - State direction the elevation of the feature being drawn is facing e.g. 'West Facing Elevation of Feature .... If feature was drawn in section then include the grid co-ordinates and elevations.

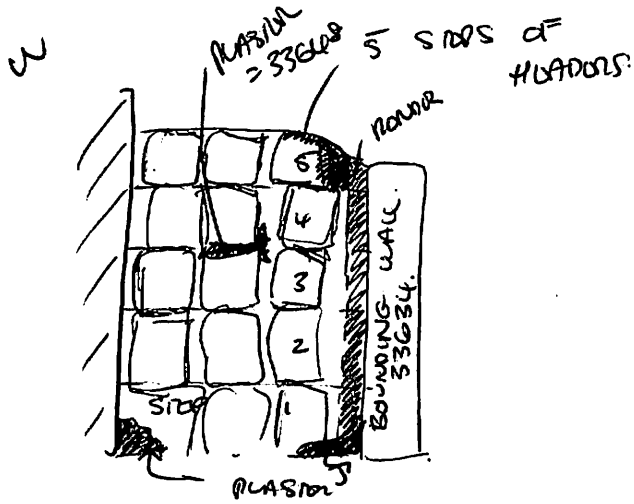

S. FACING PROFILE

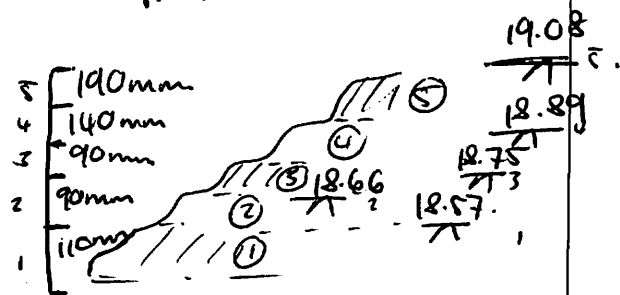

Drawing No.'s: 2012	Photo No.'s:
Space No.: 11203	Structure No.: 15169.
Matrix Group: 18068.	Matrix Phase:
Samples taken:	