

AREA: KKT-N	GRID SQUARE (S): 201 C13	GRID CO-ORDINATES: E N	INITIALS & DATE: SAER 22ii2012	FEATURE No.: 33760
-----------------------	------------------------------------	------------------------------	--	------------------------------

FEATURE TYPE (For example wall, staircase, bench, foundation structure, platform etc.): doorjamb	Full extent visible in plan: <input checked="" type="radio"/> YES / NO
--	---

1. Dimensions (in metres)	Length: 0.90m	Width: 0.16m	Height: 0.02m
---------------------------	-------------------------	------------------------	-------------------------

2. Type of material(s) used	mudbrick
-----------------------------	-----------------

3. Coursing (form of construction)	one course
------------------------------------	-------------------

4. Orientation	N-S
----------------	------------

5. Associated collapse	-
------------------------	----------

6. Cut & fill feature #'s	-
---------------------------	----------

7. Repaired?	-
--------------	----------

8. Associated floors	-
----------------------	----------

9. Surface treatments? E.g. <u>plaster</u> , paint, mouldings	33504
---	--------------

10. Size of one component	0.42m X 0.16m X 0.02m
---------------------------	------------------------------

11. Bonding material	Sandy silt
----------------------	-------------------

12. Excavated	Yes <input checked="" type="radio"/> No <input type="radio"/> Not excavated
---------------	--

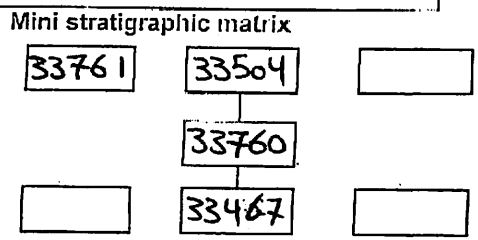

Abuts: **<33467>** Same as:
 Abutted by: **<33761>** Associated features:
 Bonded into:
 Contiguous with:

Discussion and interpretation:
N-S mudbrick door jamb abuts N-S mudbrick wall <33467> and abutted by mudbrick blocking event <33760> it is consist of one course and coated with crushed desert tafala plaster (33504)

Remember: do not just draw the architectural feature in isolation. Show how it relates to surrounding features and include details of surface treatments, repairs/modifications/damage, bonding material(s), and associated cuts. Annotate all aspects of the feature or use a Drawing Key. Measurements must be included for all aspects of the feature and surrounding features.

Sketch Plan - Include grid co-ordinates, North arrow, and elevations.

TBM 26.47
 BS 1.92
 Loc 28.39
 FS RL
 152 2.88 25.51

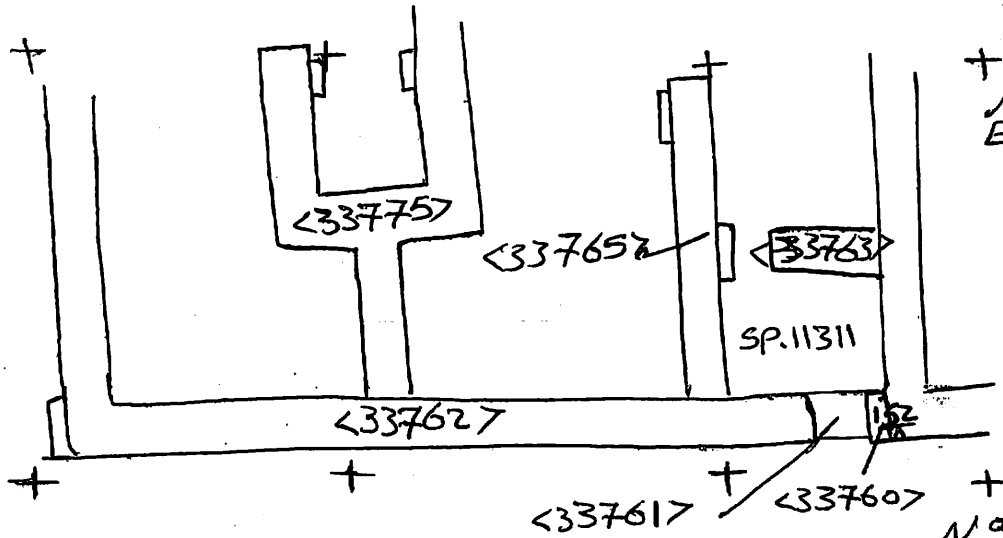

201 C13
 N 99355.00
 E 500195.00

N 99350.00
 E 500195.00.

Profile Sketch - State direction the elevation of the feature being drawn is facing e.g. 'West Facing Elevation of Feature If feature was drawn in section then include the grid co-ordinates and elevations.

Drawing No.'s: 2012-4	Photo No.'s: 512402
Space No.: 11313	Structure No.: house (A)
Matrix Group:	Matrix Phase: 4b
Samples taken:	