

AREA: KKT.N	GRID SQUARE (S): E1C11 E1D11	GRID CO-ORDINATES: E N	INITIALS & DATE: MFMH 26.11.2012.	FEATURE No.: 33776
-----------------------	--	--	---	------------------------------

FEATURE TYPE (For example wall, staircase, bench, foundation structure, platform etc.): wall	Full extent visible in plan: (YES) / NO
--	---

1. Dimensions (in metres)	Length: 1.45 m	Width: 0.70 m	Height: 0.05
2. Type of material(s) used	mudbrick		
3. Coursing (form of construction)	two Coarses .		
4. Orientation	N-S		
5. Associated collapse	—		
6. Cut & fill feature #'s	—		
7. Repaired?	—		
8. Associated floors	—		
9. Surface treatments? E.g. plaster, paint, mouldings	plastered by (33798).		
10. Size of one component	0.40 m by 0.20 m		
11. Bonding material	sandy silt		
12. Excavated	Yes (No)		

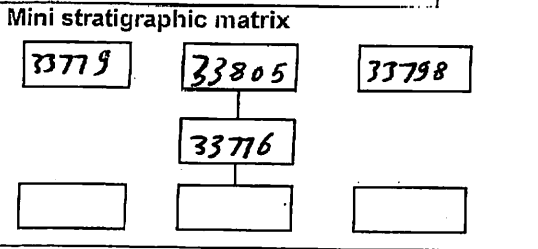

Abuts: Same as:
 Abutted by: <33779> Associated features:
 Bonded into: <33775>
 Contiguous with:

Discussion and interpretation:
 it is a mudbrick wall (N-S), it measures 1.45 m by 0.70 m, it consists of two coarses, the eastern one is stretchers, The western one is headers. it is bonded into the wall <33775> and abuted by the door tank <33779>. it is plastered by (33805), (33798). it is located between the spaces (11322), (11321).

Remember: do not just draw the architectural feature in isolation. Show how it relates to surrounding features and include details of surface treatments, repairs/modifications/damage, bonding material(s), and associated cuts. Annotate all aspects of the feature or use a Drawing Key. Measurements must be included for all aspects of the feature and surrounding features.

Sketch Plan - Include grid co-ordinates, North arrow, and elevations.

TBM: 26.47
 B.S 1.92 B.S: 2.42
 Loc 28.39 Loc: 28.89

Fs RL

$\frac{123}{*}$ 2.59 26.30
 $\frac{196}{*}$ 2.21 26.18
 $\frac{199}{*}$ 2.27 26.12

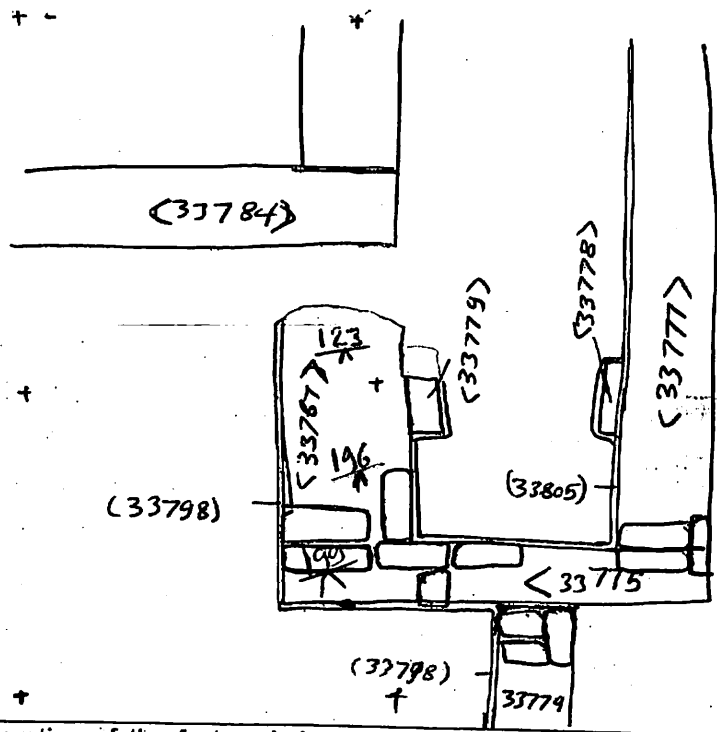

N. 99360.00
 E. 500190.00

N. 99350.00
 E. 500190.00

Profile Sketch - State direction the elevation of the feature being drawn is facing e.g. 'West Facing Elevation of Feature If feature was drawn in section then include the grid co-ordinates and elevations.

Drawing No.'s: 2012-4	Photo No.'s: 513109-513110
Space No.: 11322, 11321	Structure No.: house(A)
Matrix Group:	Matrix Phase: 4b
Samples taken:	