

AREA: KKT.N	GRID SQUARE (S): 201-DN	GRID CO-ORDINATES: E N	INITIALS & DATE: HAHA 22 ii 2012	FEATURE No.: 33784									
FEATURE TYPE (For example wall, staircase, bench, foundation structure, platform etc.): Wall			Full extent visible in plan: <input checked="" type="radio"/> YES / NO										
1. Dimensions (in metres)	Length: 1.30M	Width: 0.65M	Height: 0.06M										
2. Type of material(s) used	mud brick												
3. Coursing (form of construction)	Two courses												
4. Orientation	E-W												
5. Associated collapse	---												
6. Cut & fill feature #'s	---												
7. Repaired?	---												
8. Associated floors	---												
9. Surface treatments? E.g. plaster, paint, mouldings	(33798)												
10. Size of one component	0.40m by 0.20m b												
11. Bonding material	sandy silt												
12. Excavated	Yes/No Not EXCavated												
Mini stratigraphic matrix		Abuts: <33785> Same as:											
<table border="1"> <tr> <td></td> <td></td> <td></td> </tr> <tr> <td></td> <td>33784</td> <td></td> </tr> <tr> <td></td> <td>33785</td> <td></td> </tr> </table>						33784			33785		Abutted by: Associated features:		
	33784												
	33785												
		Bonded into:											
		Contiguous with:											
Discussion and interpretation:													
<p>Wall <33784> is made of mud brick the top of this wall consists of 2 courses The northern side is header and the southern side is stretcher. The wall abuts wall <33785>, it's coated by plaster (33786) it's E-W orientated. This wall is the southern wall to space (11323) and the northern wall to space (11321).</p>													

Remember: do not just draw the architectural feature in isolation. Show how it relates to surrounding features and include details of surface treatments, repairs/modifications/damage, bonding material(s), and associated cuts. Annotate all aspects of the feature or use a Drawing Key. Measurements must be included for all aspects of the feature and surrounding features.

Sketch Plan - Include grid co-ordinates, North arrow, and elevations.



TBM ; 26.47

B.S ; 2.42

LOC ; 28.89

N 19936000
E 15001800

	F.S	RL
$\frac{113}{x}$	2.56	26.33
$\frac{117}{x}$	2.45	26.44
$\frac{138}{x}$	2.53	26.36
$\frac{139}{x}$	2.54	26.35

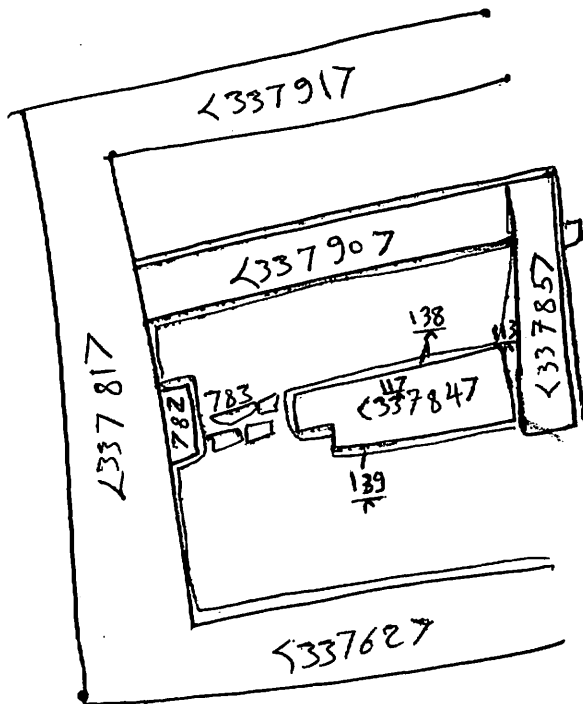

N 19936000
+ E 1500185

Profile Sketch - State direction the elevation of the feature being drawn is facing e.g. 'West Facing Elevation of Feature If feature was drawn in section then include the grid co-ordinates and elevations.

Drawing No.'s: 2012-4	Photo No.'s: 513110-513111-513114
Space No.: 11321	Structure No.: House A
Matrix Group:	Matrix Phase: 4b
Samples taken:	