

AREA: KKT-N	GRID SQUARE (S): 201 E11	GRID CO-ORDINATES: E N	INITIALS & DATE: MFMH 25 ii 2012	FEATURE No.: 33786
-----------------------	------------------------------------	------------------------------	------------------------------------------------------	------------------------------

FEATURE TYPE (For example wall, staircase, bench, foundation structure, platform etc.): door JAMB	Full extent visible in plan: <input checked="" type="radio"/> YES / NO
-------------------------------------------------------------------------------------------------------------	---------------------------------------------------------------------------

1. Dimensions (in metres)	Length: 0.65 m	Width: 0.30 m	Height: 0.05 m
2. Type of material(s) used	mudbrick		
3. Coursing (form of construction)	two courses		
4. Orientation	N-S		
5. Associated collapse	—		
6. Cut & fill feature #'s	—		
7. Repaired?	—		
8. Associated floors	—		
9. Surface treatments? E.g. plaster, paint, mouldings	—		
10. Size of one component	0.90 m by 0.20 m		
11. Bonding material	Sandy silt		
12. Excavated	<input checked="" type="radio"/> Yes / <input type="radio"/> No		

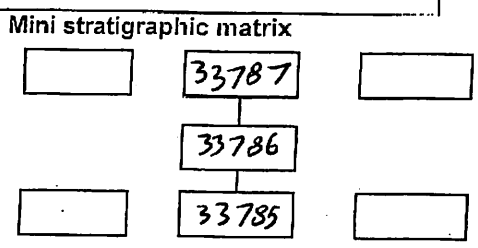

Abuts: **<33785>** Same as:

Abutted by: **<33789>** Associated features:

Bonded into:

Contiguous with:

Discussion and interpretation:

It is a mudbrick doorjamb (N-S). It measures 0.65 m by 0.30 m. It consists of two courses, the northern one is header (one unit), and the southern face is headers. It is located between (11320, 11322).

It seems to be stuffed by a lime stone ^{spaces} fragments to support it. It consists the only entrance of the space (11320).

Remember: do not just draw the architectural feature in isolation. Show how it relates to surrounding features and include details of surface treatments, repairs/modifications/damage, bonding material(s), and associated cuts. Annotate all aspects of the feature or use a Drawing Key. Measurements must be included for all aspects of the feature and surrounding features.

Sketch Plan - Include grid co-ordinates, North arrow, and elevations.

TBM 26.47
 B.S. 1.92
 Loc 28.39

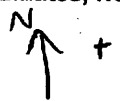

N 99365.00
 + E 500185

Fs. RL.
 61 1.94 26.45

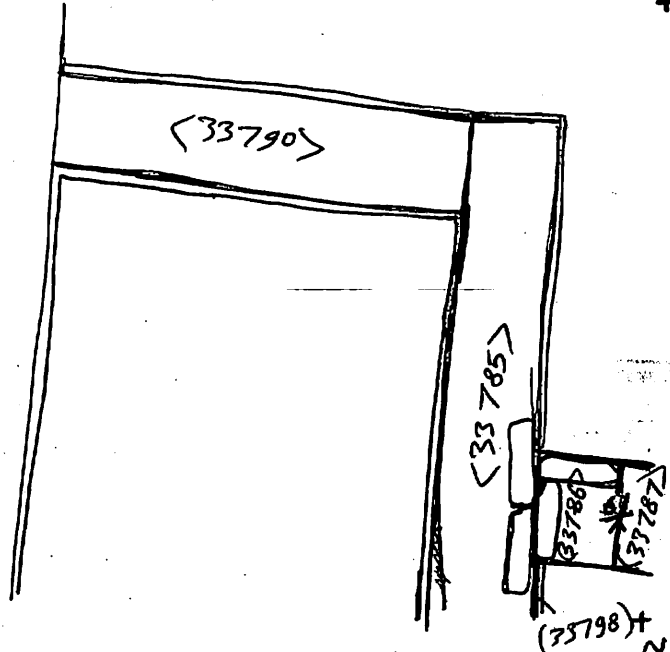

N. 99360.00
 E. 500185.00

Profile Sketch - State direction the elevation of the feature being drawn is facing e.g. 'West Facing Elevation of Feature If feature was drawn in section then include the grid co-ordinates and elevations.

Drawing No.'s: 2012-4	Photo No.'s: 513112 - 513119
Space No.: 11320, 11322	Structure No.: house (A)
Matrix Group:	Matrix Phase: 4b
Samples taken:	