

AREA: <b>KKT-N</b>	GRID SQUARE (S): <b>E11 E12</b>	GRID CO-ORDINATES: <b>E N</b>	INITIALS & DATE: <b>MFMH 25/11/2012</b>	FEATURE No.: <b>33787</b>
-----------------------	--	--------------------------------------	--	------------------------------

FEATURE TYPE (For example wall, staircase, bench, foundation structure, platform etc.): <b>Threshold</b>	Full extent visible in plan: <input checked="" type="radio"/> YES / NO
---	---

1. Dimensions (in metres)	Length: <b>0.70 m</b>	Width: <b>0.50 m</b>	Height: <b>0.05 m</b>
2. Type of material(s) used	<b>mudbrick</b>		
3. Coursing (form of construction)	<b>Two courses</b>		
4. Orientation	<b>N-S</b>		
5. Associated collapse	—		
6. Cut & fill feature #'s	—		
7. Repaired?	—		
8. Associated floors	—		
9. Surface treatments? E.g. plaster, paint, mouldings	—		
10. Size of one component	<b>0.40 m by 0.20 m</b>		
11. Bonding material	<b>Sandy silt</b>		
12. Excavated	Yes/No <input checked="" type="radio"/> No		

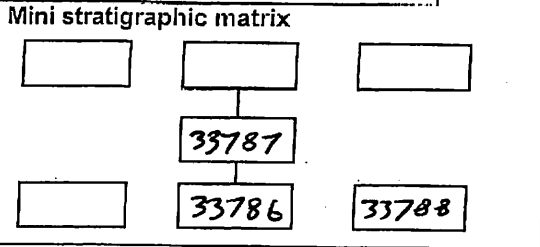

Abuts: **(33786, 33788)** Same as:

Abutted by: Associated features:

Bonded into:

Contiguous with:

Discussion and interpretation:

It is a threshold of mudbrick (N-S), it measures 0.70m by 0.50m, it consists of two courses, the northern one is stretchers, the southern one is headers. It is located between the spaces (11320, 11322). We notice that, the northern ~~one~~ face is eroded.

Remember: do not just draw the architectural feature in isolation. Show how it relates to surrounding features and include details of surface treatments, repairs/modifications/damage, bonding material(s), and associated cuts. Annotate all aspects of the feature or use a Drawing Key. Measurements must be included for all aspects of the feature and surrounding features.

Sketch Plan - Include grid co-ordinates, North arrow, and elevations.

TBM 26.47  
BS 1.92  
Loc. 28.39

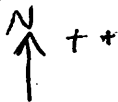

+ N 99365.00  
E 500185.00

Fs. RL.

61 1.94 26.45

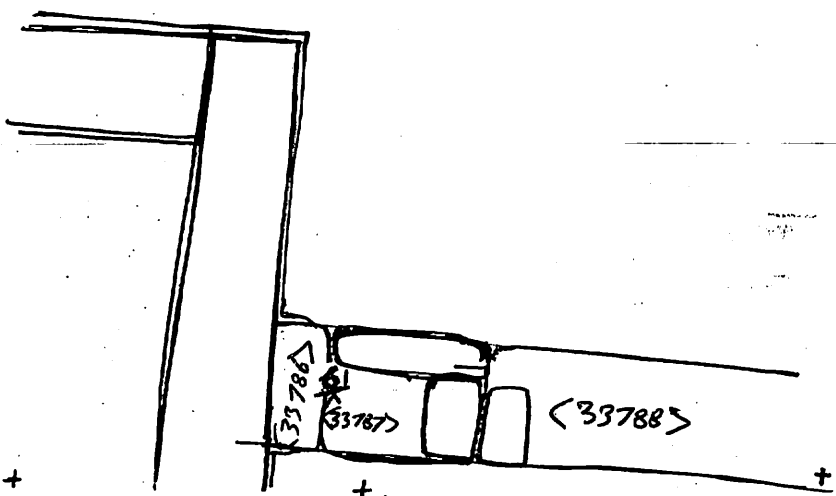

+ N 99360.00  
E 500185.00

Profile Sketch - State direction the elevation of the feature being drawn is facing e.g. 'West Facing Elevation of Feature .... If feature was drawn in section then include the grid co-ordinates and elevations.

Drawing No.'s: 2012-4	Photo No.'s: 513112
Space No.: 11320, 11322	Structure No.: house (A)
Matrix Group:	Matrix Phase: 6
Samples taken:	