

AREA: KKT.N	GRID SQUARE (S): 201E11	GRID CO-ORDINATES: E N	INITIALS & DATE: HAAA.AFAM 22 ii 2012	FEATURE No.: 33790
-----------------------	-----------------------------------	------------------------------	---	------------------------------

FEATURE TYPE (For example wall, staircase, bench, foundation structure, platform etc.): Wall	Full extent visible in plan: <input checked="" type="radio"/> YES / NO
--	---

1. Dimensions (in metres)	Length: 2.20M	Width: 0.60M	Height: 0.12M
2. Type of material(s) used	Mud brick		
3. Coursing (form of construction)	Two courses		
4. Orientation	E - W		
5. Associated collapse	---		
6. Cut & fill-feature #'s	---		
7. Repaired?	---		
8. Associated floors	---		
9. Surface treatments? E.g. plaster, paint, mouldings	-		
10. Size of one component	0.40M long by 0.20M width		
11. Bonding material	Sandy silt		
12. Excavated	Yes/No Not Excavated		

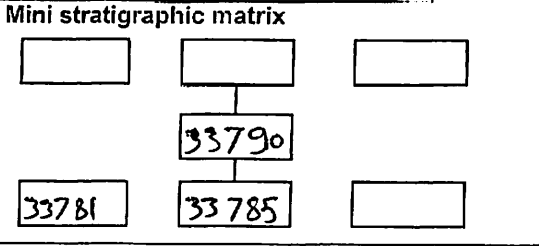

Abuts: <33781> <33785> Same as:

Abutted by: Associated features:

Bonded into:

Contiguous with:

Discussion and interpretation:
 wall < 33790 > is made of mudbrick, it is E to W orientated.
 The top of this wall consists of 2 courses the northern side stretcher the southern side is header. this wall is abuted 2 walls < 33781 > and wall < 33785 >. it coated by 1 plaster (33796)
 This wall is the southern wall to space (11324) and the northern wall to space (11323).

Remember: do not just draw the architectural feature in isolation. Show how it relates to surrounding features and include details of surface treatments, repairs/modifications/damage, bonding material(s), and associated cuts. Annotate all aspects of the feature or use a Drawing Key. Measurements must be included for all aspects of the feature and surrounding features.

Sketch Plan - Include grid co-ordinates, North arrow, and elevations.

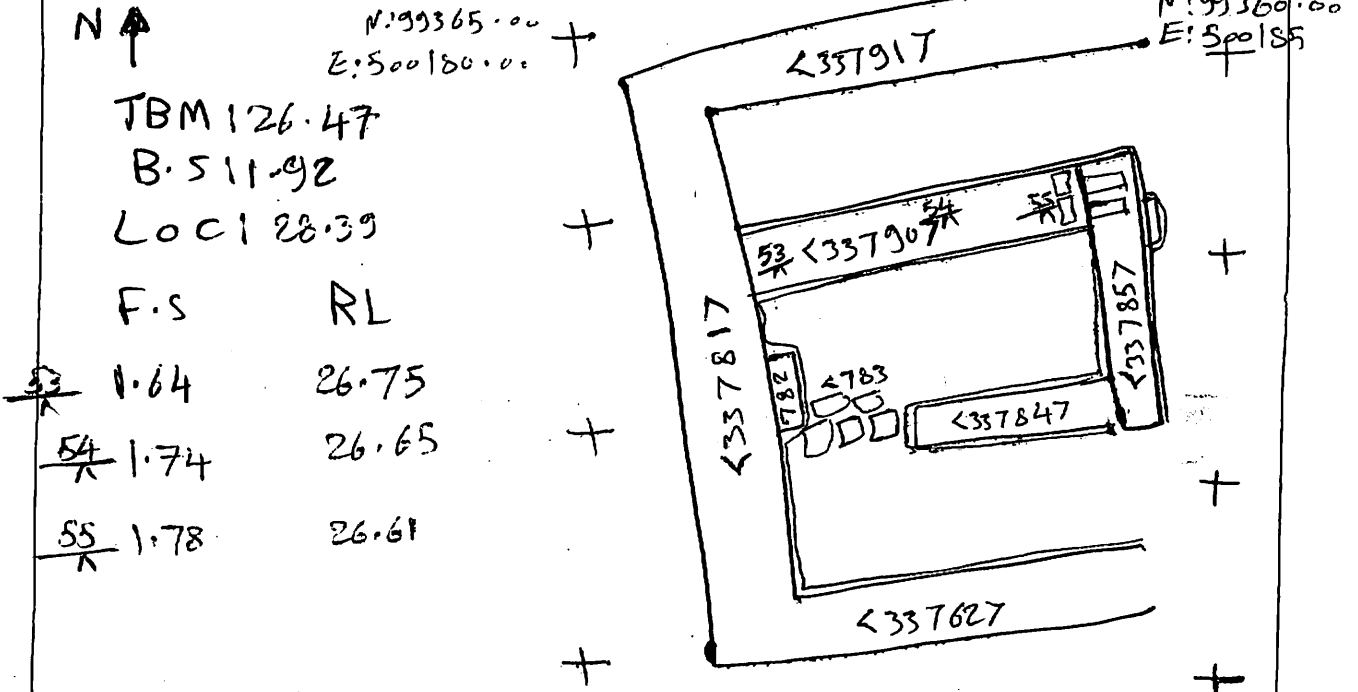

Profile Sketch - State direction the elevation of the feature being drawn is facing e.g. 'West Facing Elevation of Feature If feature was drawn in section then include the grid co-ordinates and elevations.

Drawing No.'s: 2012-4	Photo No.'s: 513114
Space No.: 11323, 11324	Structure No.: House A
Matrix Group:	Matrix Phase: 4b
Samples taken:	