

AREA: 14T - E +	GRID SQUARE (S): 43 H 44	GRID CO-ORDINATES: E N	INITIALS & DATE: HR IC AKoA 26/2/2012	FEATURE No.: 33812
--------------------	--------------------------------	------------------------------	--	-----------------------

FEATURE TYPE (For example <u>wall</u> staircase, bench, foundation structure, platform etc.):	Full extent visible in plan: <input checked="" type="checkbox"/> YES / NO
---	--

1. Dimensions (in metres)	Length: 3.30 m E/W	Width: 1.00m N/S	Height: 0.07 m
2. Type of material(s) used	mud brick		
3. Coursing (form of construction)	one course?		
4. Orientation	North - South		
5. Associated collapse	None		
6. Cut & fill feature #'s	None		
7. Repaired?	None		
8. Associated floors	None		
9. Surface treatments? E.g. plaster, paint, mouldings	None		
10. Size of one component	not clear		
11. Bonding material	silt		
12. Excavated	<input checked="" type="checkbox"/> Yes / No		

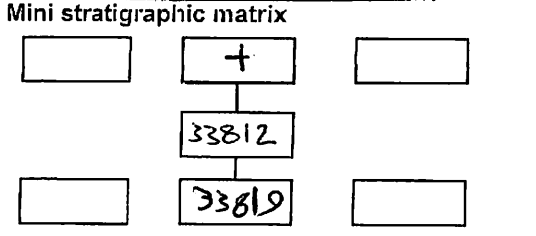

Abuts: Same as:

Abutted by: Associated features:

Bonded into:

Contiguous with:

Discussion and interpretation:

This part of possible massive brick wall <33812> which truncated by the boundaries of trench (125) but the last course was survived. It not completely clear, maybe the western part of that wall truncated by the basin, when excavated the part of that wall I found the western edge of that wall covered the line of yellow plaster coated the western face of east north-south mud brick wall <33423>. I think that line of yellow plaster still expanded under the wall <33812> also in the part outside the trench. That means may be after wall <33423> destroyed the wall <33812> and it's used as a corridor, maybe wall <33423> older than wall <33812>

Remember: do not just draw the architectural feature in isolation. Show how it relates to surrounding features and include details of surface treatments, repairs/modifications/damage, bonding material(s), and associated cuts. Annotate all aspects of the feature or use a Drawing Key. Measurements must be included for all aspects of the feature and surrounding features.

**Sketch Plan** - Include grid co-ordinates, North arrow, and elevations.

T3m 16.69 B-50.78 1.0-c17.47

π	ES	R.L
1	1.44	16.03
2	1.47	16.00
3	1.44	16.03
4	1.44	16.03
5	1.52	15.95
6	1.48	15.99
7	1.52	15.89
8	1.60	15.87
9	1.51	15.96
10	1.44	16.03
11	1.60	15.87
12	1.59	15.88
13	1.61	15.86
14	1.62	15.85
15	1.64	15.83
16	1.63	15.84
17	1.64	15.83

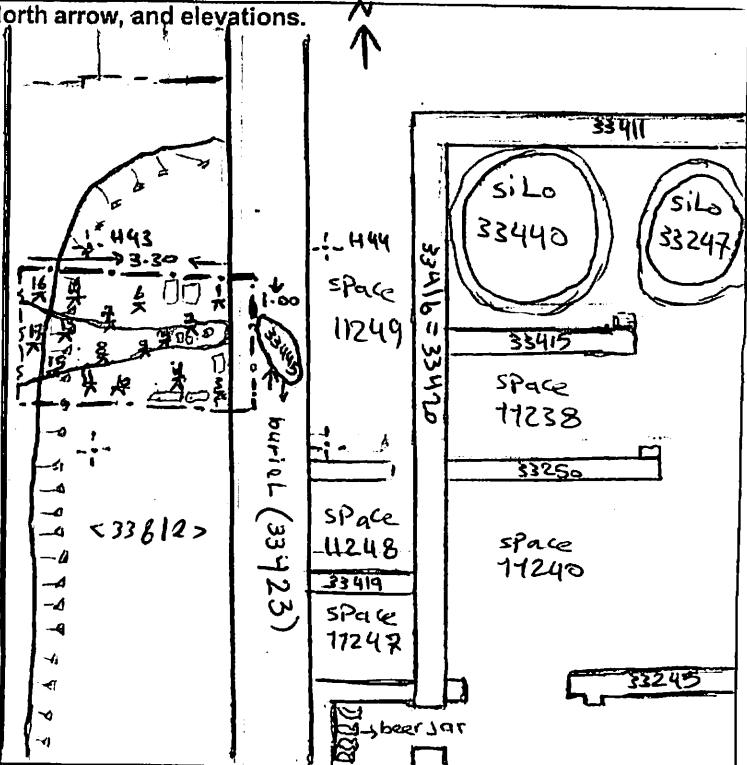

**Profile Sketch** - State direction the elevation of the feature being drawn is facing e.g. 'West Facing Elevation of Feature .... If feature was drawn in section then include the grid co-ordinates and elevations.

Drawing No.'s: 2012 - 33872

Photo No.'s: 2012 (104086, 104087)

Space No.:

Structure No.:

Matrix Group:

Matrix Phase:

Samples taken: