

AREA: KKT.N	GRID SQUARE (S): 201D10 201D9	GRID CO-ORDINATES: E N	INITIALS & DATE: AFAM 4/11/2012	FEATURE No.: 33882
FEATURE TYPE (For example wall, staircase, bench, foundation structure, platform etc.): wall			Full extent visible in plan: <u>YES</u> / NO	
1. Dimensions (in metres)	Length: 5.68 m	Width: 1.09 m	Height: 0.03 m	
2. Type of material(s) used	mudbrick			
3. Coursing (form of construction)	3 courses The northern side header. the southern header in between stretcher			
4. Orientation	E to W			
5. Associated collapse	-			
6. Cut & fill feature #'s	-			
7. Repaired?	-			
8. Associated floors	-			
9. Surface treatments? E.g. plaster, paint, mouldings	-			
10. Size of one component	0.40 m x 0.19 m			
11. Bonding material	sandy silt			
12. Excavated	Yes/No			
Mini stratigraphic matrix 		Abuts: <33877> Same as: Abutted by: <33884> <33883> Associated features: Bonded into: Contiguous with:		
Discussion and interpretation: wall <33882> is East to west mudbrick wall. The top of this wall consists of 3 courses, the northern side is header, the southern side is header too. which located in between is stretcher. This wall is the southern wall to space 11329 and the northern wall to space 11328. abuts wall <33877>. abuted by Two walls <33883> and <33884>.				

Remember: do not just draw the architectural feature in isolation. Show how it relates to surrounding features and include details of surface treatments, repairs/modifications/damage, bonding material(s), and associated cuts. Annotate all aspects of the feature or use a Drawing Key. Measurements must be included for all aspects of the feature and surrounding features.

Sketch Plan - Include grid co-ordinates, North arrow, and elevations.

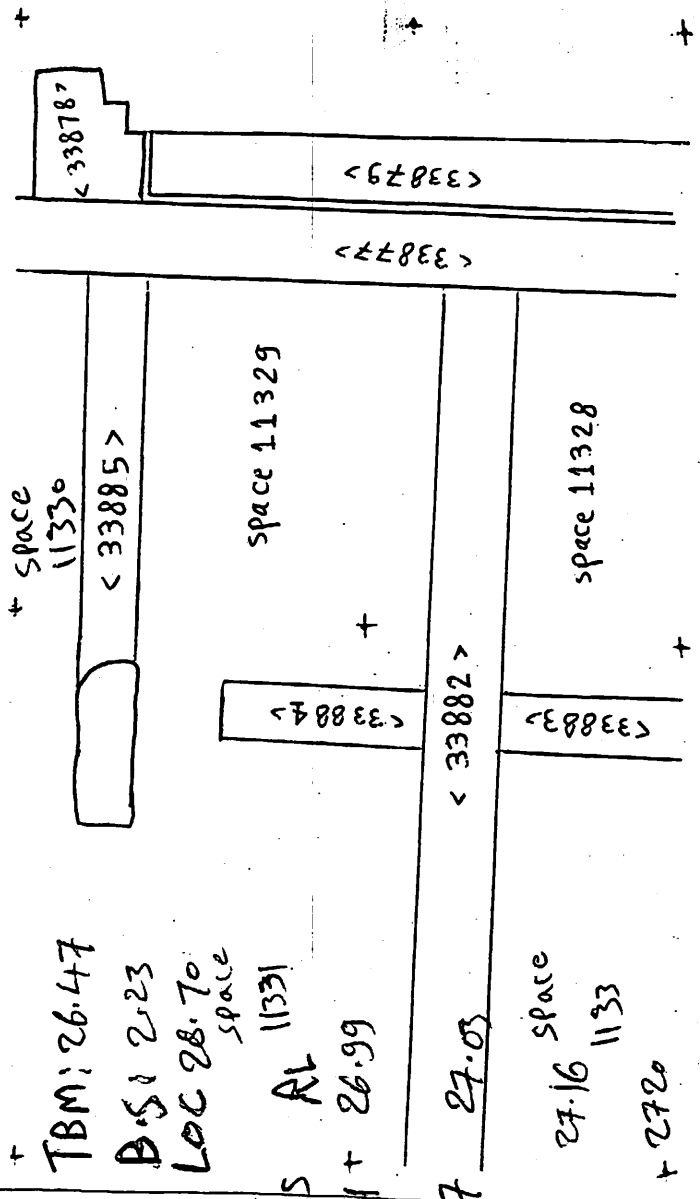

Profile Sketch - State direction the elevation of the feature being drawn is facing e.g. 'West Facing Elevation of Feature If feature was drawn in section then include the grid co-ordinates and elevations.

Drawing No.'s:	2912-18	Photo No.'s:	513220-513221
Space No.:	11329-11328 11331-11332	Structure No.:	magasin
Matrix Group:		Matrix Phase:	4b
Samples taken:			