

AREA: kkt-E+	GRID SQUARE (S): H45,46	GRID CO-ORDINATES: E N	INITIALS & DATE: AKOA 11 March 2012	FEATURE No.: 34005									
FEATURE TYPE (For example wall, staircase, bench, foundation structure, platform etc.): threshold			Full extent visible in plan: YES / NO										
1. Dimensions (in metres)		Length: 0.62m	Width: 0.30m	Height: —									
2. Type of material(s) used													
3. Coursing (form of construction)													
4. Orientation east-west													
5. Associated collapse													
6. Cut & fill feature #'s													
7. Repaired?													
8. Associated floors													
9. Surface treatments? E.g. plaster, paint, mouldings													
10. Size of one component													
11. Bonding material													
12. Excavated		Yes/No											
Mini stratigraphic matrix <table border="0" style="width: 100%;"> <tr> <td style="border: 1px solid black; padding: 2px;">34044</td> <td style="border: 1px solid black; padding: 2px;">34043</td> <td style="border: 1px solid black; width: 40px; height: 20px;"></td> </tr> <tr> <td></td> <td style="border: 1px solid black; padding: 2px;">34005</td> <td></td> </tr> <tr> <td style="border: 1px solid black; padding: 2px;">33250</td> <td style="border: 1px solid black; padding: 2px;">33414</td> <td style="border: 1px solid black; width: 40px; height: 20px;"></td> </tr> </table>			34044	34043			34005		33250	33414		Abuts: Same as: Abutted by: Associated features: Bonded into: Contiguous with:	
34044	34043												
	34005												
33250	33414												
Discussion and interpretation: east-west tiny mark brick threshold (34005), in southern entrance of silos room (and spaces 11237, 11238)													

Remember: do not just draw the architectural feature in isolation. Show how it relates to surrounding features and include details of surface treatments, repairs/modifications/damage, bonding material(s), and associated cuts. Annotate all aspects of the feature or use a Drawing Key. Measurements must be included for all aspects of the feature and surrounding features.

Sketch Plan - Include grid co-ordinates, North arrow, and elevations.

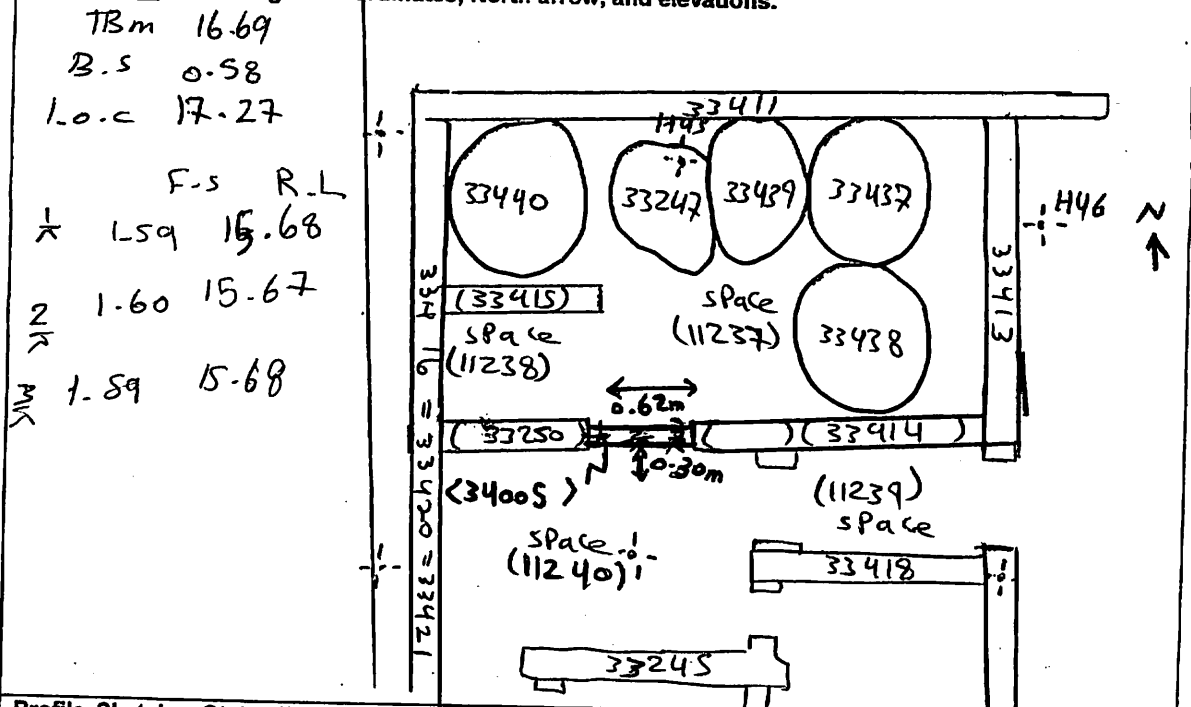

Profile Sketch - State direction the elevation of the feature being drawn is facing e.g. 'West Facing Elevation of Feature If feature was drawn in section then include the grid co-ordinates and elevations.

Drawing No.'s:	Photo No.'s:
Space No.: 11237 > 11240	Structure No.:
Matrix Group:	Matrix Phase:
Samples taken:	