

AREA: 1cdt-ε+	GRID SQUARE (S): G47	GRID CO-ORDINATES: E N	INITIALS & DATE: AKO A 10 March 2012	FEATURE No.: 34010														
FEATURE TYPE (For example wall, staircase, bench, foundation structure, platform etc.):			Full extent visible in plan: YES / NO															
1. Dimensions (in metres)	Length: 1.38m	Width: 0.20m	Height: 0.20m															
2. Type of material(s) used																		
3. Coursing (form of construction)																		
4. Orientation	east-west																	
5. Associated collapse																		
6. Cut & fill feature #'s																		
7. Repaired?																		
8. Associated floors																		
9. Surface treatments? E.g. plaster, paint, mouldings																		
10. Size of one component																		
11. Bonding material																		
12. Excavated	Yes/No																	
Mini stratigraphic matrix <table border="1" style="margin-left: 20px;"> <tr> <td style="width: 40px; height: 20px;"></td> <td style="width: 40px; height: 20px; text-align: center;">34012</td> <td style="width: 40px; height: 20px;"></td> </tr> <tr> <td></td> <td style="text-align: center;"> </td> <td></td> </tr> <tr> <td></td> <td style="text-align: center;">34010</td> <td></td> </tr> <tr> <td></td> <td style="text-align: center;"> </td> <td></td> </tr> <tr> <td></td> <td style="text-align: center;">33256</td> <td></td> </tr> </table>		34012						34010						33256		Abuts: 33256	Same as:	
	34012																	
	34010																	
	33256																	
	Abutted by: 34012	Associated features:																
	Bonded into:																	
	Contiguous with:																	
Discussion and interpretation: east-west tiny mark brick wall (34010), forms the northern limit of space (11250).																		

Remember: do not just draw the architectural feature in isolation. Show how it relates to surrounding features and include details of surface treatments, repairs/modifications/damage, bonding material(s), and associated cuts. Annotate all aspects of the feature or use a Drawing Key. Measurements must be included for all aspects of the feature and surrounding features.

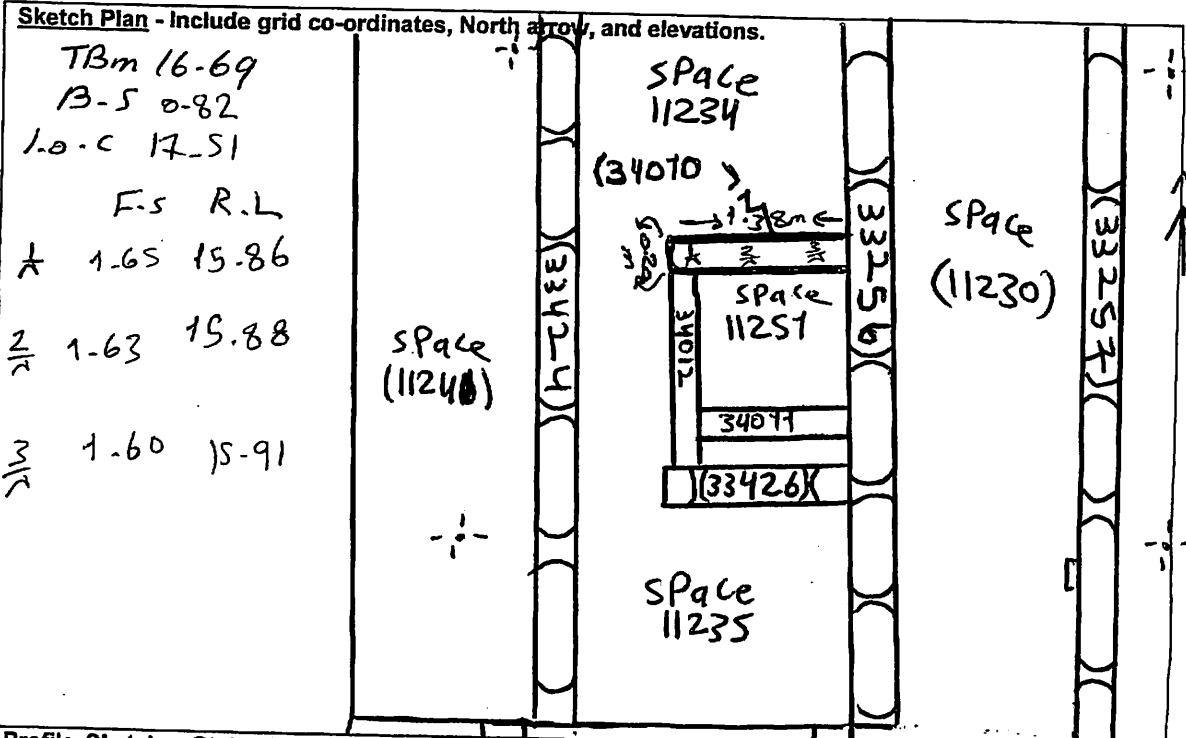

Profile Sketch - State direction the elevation of the feature being drawn is facing e.g. 'West Facing'. Elevation of Feature If feature was drawn in section then include the grid co-ordinates and elevations.

Drawing No.'s:	Photo No.'s:
Space No.: (11234), (11251)	Structure No.:
Matrix Group:	Matrix Phase:
Samples taken:	