

| | | | | | | | | | | | | | |
|---|--------------------------|------------------------------|--|-----------------------|--|--|-------|--|-------|-------|--|---|--|
| AREA: 122E7 | GRID SQUARE (S): H147 | GRID CO-ORDINATES: E N | INITIALS & DATE: AKA 18 March 2012 | FEATURE No.: 34016 | | | | | | | | | |
| FEATURE TYPE (For example wall, staircase, bench, foundation structure, platform etc.): threshold | | | Full extent visible in plan: YES / NO | | | | | | | | | | |
| 1. Dimensions (in metres) | | Length: 0.68m | Width: 0.14m | Height: — | | | | | | | | | |
| 2. Type of material(s) used | | | | | | | | | | | | | |
| 3. Coursing (form of construction) | | | | | | | | | | | | | |
| 4. Orientation east-west | | | | | | | | | | | | | |
| 5. Associated collapse | | | | | | | | | | | | | |
| 6. Cut & fill feature #'s | | | | | | | | | | | | | |
| 7. Repaired? | | | | | | | | | | | | | |
| 8. Associated floors | | | | | | | | | | | | | |
| 9. Surface treatments? E.g. plaster, paint, mouldings | | | | | | | | | | | | | |
| 10. Size of one component | | | | | | | | | | | | | |
| 11. Bonding material | | | | | | | | | | | | | |
| 12. Excavated Yes/No | | | | | | | | | | | | | |
| Mini stratigraphic matrix <table border="0"> <tr> <td style="border: 1px solid black; padding: 2px;">34030</td> <td style="border: 1px solid black; padding: 2px;">33857</td> <td style="border: 1px solid black; width: 40px; height: 20px;"></td> </tr> <tr> <td></td> <td style="border: 1px solid black; padding: 2px;">34016</td> <td></td> </tr> <tr> <td style="border: 1px solid black; padding: 2px;">33412</td> <td style="border: 1px solid black; padding: 2px;">33410</td> <td style="border: 1px solid black; width: 40px; height: 20px;"></td> </tr> </table> | | | 34030 | 33857 | | | 34016 | | 33412 | 33410 | | Abuts: Same as: Abutted by: Associated features: Bonded into: Contiguous with: | |
| 34030 | 33857 | | | | | | | | | | | | |
| | 34016 | | | | | | | | | | | | |
| 33412 | 33410 | | | | | | | | | | | | |
| Discussion and interpretation: east-west mud brick threshold in entrance between spaces (11232, 11233). | | | | | | | | | | | | | |

Remember: do not just draw the architectural feature in isolation. Show how it relates to surrounding features and include details of surface treatments, repairs/modifications/damage, bonding material(s), and associated cuts. Annotate all aspects of the feature or use a Drawing Key. Measurements must be included for all aspects of the feature and surrounding features.

Sketch Plan - Include grid co-ordinates, North arrow, and elevations.

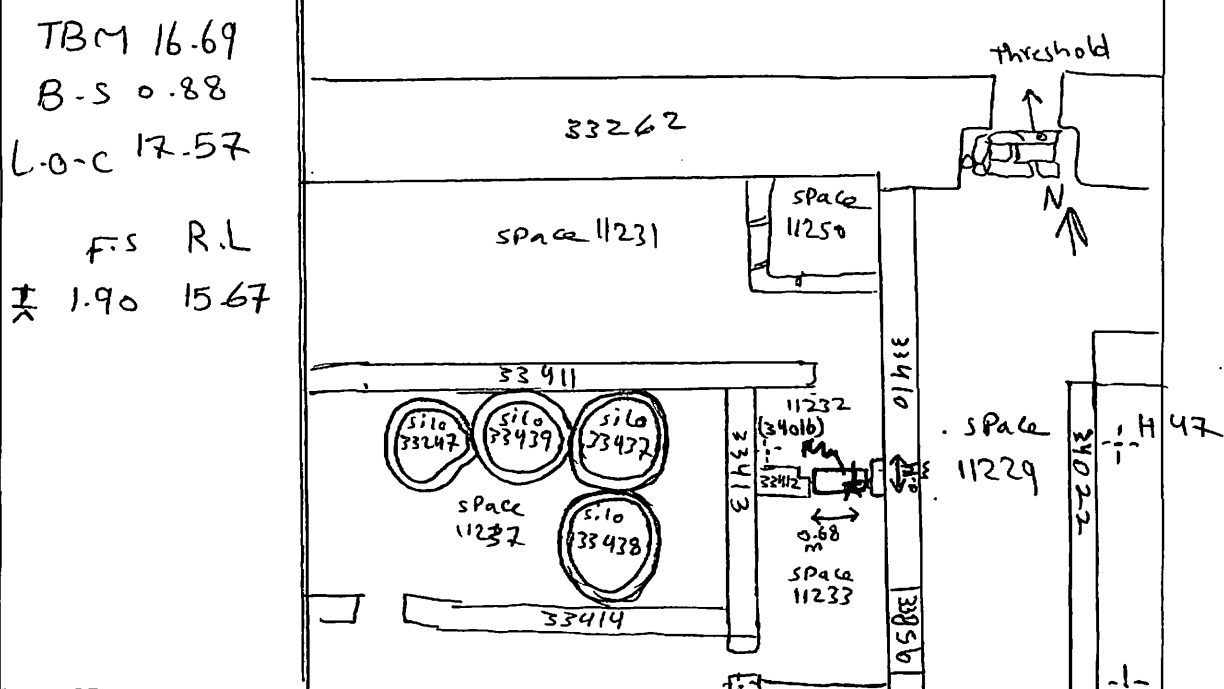

Profile Sketch - State direction the elevation of the feature being drawn is facing e.g. 'West Facing Elevation of Feature If feature was drawn in section then include the grid co-ordinates and elevations.

| | |
|--------------------------|----------------|
| Drawing No.'s: | Photo No.'s: |
| Space No.: 11232 - 11233 | Structure No.: |
| Matrix Group: | Matrix Phase: |
| Samples taken: | |