

AREA: kkt-6+	GRID SQUARE (S): J47	GRID CO-ORDINATES: E N	INITIALS & DATE: AKoA 11 March 2012	FEATURE No.: 34037									
FEATURE TYPE (For example wall, staircase, bench, foundation structure, platform etc.):			Full extent visible in plan: YES / NO										
1. Dimensions (in metres)	Length: 3.57 m	Width: 0.15 m	Height: 0.76 m										
2. Type of material(s) used													
3. Coursing (form of construction)													
4. Orientation	east-west												
5. Associated collapse													
6. Cut & fill feature #'s													
7. Repaired?													
8. Associated floors													
9. Surface treatments? E.g. plaster, paint, mouldings													
10. Size of one component													
11. Bonding material													
12. Excavated	Yes/No												
Mini stratigraphic matrix	<table border="1"> <tr> <td></td> <td>33842</td> <td></td> </tr> <tr> <td></td> <td>34037</td> <td></td> </tr> <tr> <td></td> <td>34029</td> <td></td> </tr> </table>			33842			34037			34029		Abuts:	Same as:
	33842												
	34037												
	34029												
			Abutted by:	Associated features:									
			Bonded into:										
			Contiguous with:										
Discussion and interpretation:													
<p>East-west <sup>Tiny</sup> marl brick wall (34037). Forms the northern limit of space (11337), also the southern limit of space (11338), it not fully extent visible in plan</p>													

Remember: do not just draw the architectural feature in isolation. Show how it relates to surrounding features and include details of surface treatments, repairs/modifications/damage, bonding material(s), and associated cuts. Annotate all aspects of the feature or use a Drawing Key. Measurements must be included for all aspects of the feature and surrounding features.

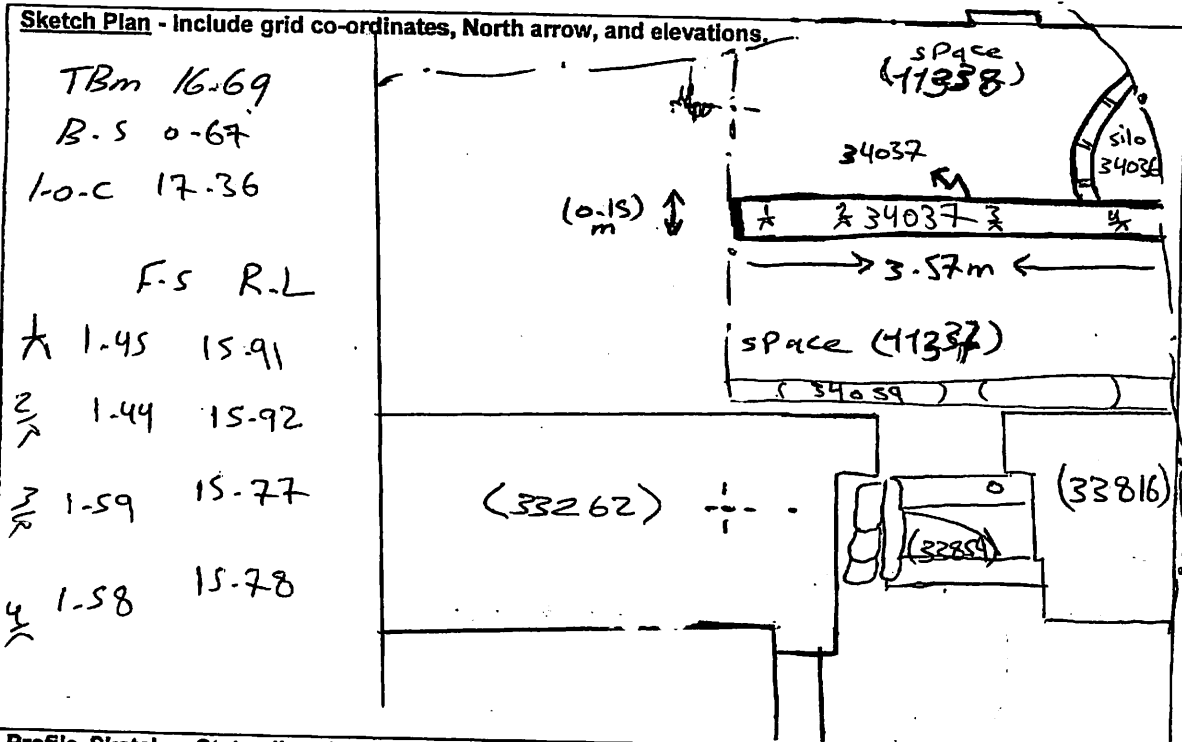

**Profile Sketch** - State direction the elevation of the feature being drawn is facing e.g. 'West Facing Elevation of Feature .... If feature was drawn in section then include the grid co-ordinates and elevations.

Drawing No.'s:	Photo No.'s:
Space No.: 11256, 11257	Structure No.:
Matrix Group:	Matrix Phase:
Samples taken:	