

GPMP 2012

Site: SAPS 2/EFM Area: KICT-F.	GRID SQUARE(S) 201-B30, 201-B31	ARCHITECTURE THRESHOLD.	FEATURE 34086						
1. Material	1) SUN DRIED BRICK - TYPE UNKNOWN								
2. Size of materials	2) 0.40m (L) x 0.22m (W) FROM PLAN 2007-221-50								
3. Finish	3) SQUARED. AVERAGE								
4. Coursing/bond	4) TWO STRETCHERS SITUATED NEXT TO TWO HEADERS.								
5. Form	5) THRESHOLD								
6. Direction of faces	6) ✓								
7. Orientation	7) NE/SW								
8. Dimensions	8) L: 0.82m								
9. Associated collapse	W: 0.42m								
10. Founds, cuts & fills	D: UNKNOWN								
11. Repaired	9) UNKNOWN								
12. Associated floors	10) NO CUT RECORDED ON THE PLANS								
13. Plastered	11) UNKNOWN								
14. Wall core	12) UNKNOWN								
15. Types of brick (%)	13) UNKNOWN								
16. Composition of bricks	14) NONE		16) UNKNOWN						
17. Dimensions of bricks (sample of three)	15) 100% SUN DRIED BRICK		17) SEE # 2.						
Stratigraphic Matrix			Abuts Above Abutted by Below Bonded into Contiguous with						
INTERPRETATION	Enclosing	<u>Internal</u>	External						
Reason for decay	UNEXCAVATED								
Indications of original dimensions	SUN DRIED BRICK CONSTRUCTED THRESHOLD AT								
Indications of original functions	THE ACCESS POINT BETWEEN SPACE 11365 AND 11366 IN STRUCTURE 15249.								
IN 2007 THIS FEATURE WAS NOT ASSIGNED A NUMBER AND WAS DIGITIZED AS PART OF WALL (28800). THIS WAS CHANGED AS PART OF AERA'S DATA ENHANCEMENT PROJECT. IT WAS GIVEN A FEATURE NUMBER & DIGITIZED AS A SEPARATE FEATURE.									
Associated contexts: WALL (28800) & WALL (28807)									
Context Same As: ✓									
Drawing Nos: 2007-220, 2007-221									
Photographs (feature in plan, elevation, materials used, surface treatment e.g. plaster, paint etc.)		Finds		Samples (flotation, wet sieve, materials used e.g. bricks, stone, wood, bonding material etc.)					
Photograph No.	Description	Description	Artefact no.	Sample No.	Description				
/		/		/					
						Phase: 3		GROUP 18163	
						Checked		Initials DCJ	
						Date 05 SEPT 2012			

(34086)

Sketch Drawings (in plan and in profile)

Remember: do not just draw the architectural feature in isolation. Show how it relates to surrounding features and include details of surface treatments, repairs/modifications/damage, bonding material(s), and associated cuts. Annotate all aspects of the feature or use a Drawing Key. Measurements must be included for all aspects of the feature and surrounding features.

Sketch Plan - Include grid co-ordinates, North arrow, and elevations.

201-B31

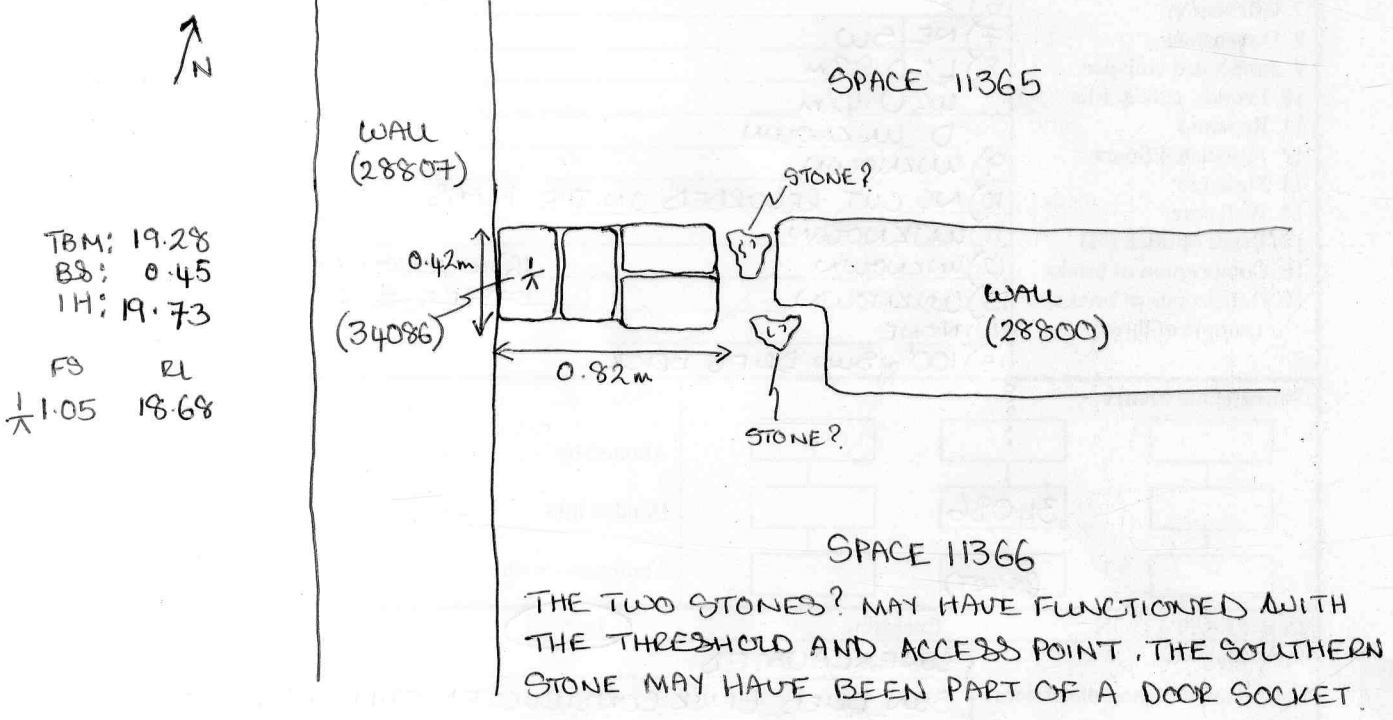

Profile Sketch

- State direction the elevation of the feature being drawn is facing e.g. 'West Facing Elevation of Feature
- If feature was drawn in section then include the grid co-ordinates and elevations.