

GPMP GIZA

Site: <del>SAPS-2 / #777</del> Area: KLT-A1 / KLT-F		GRID SQUARE(S) 101-T30	ARCHITECTURE	FEATURE 34094
1. Material	1) MUD BRICK			
2. Size of materials	2) —			
3. Finish	3) WALL POSSIBLY REGULAR COURSING			
4. Coursing/bond	4) TWO ROWS OF HEADERS			
5. Form	5) WALL			
6. Direction of faces	6) NORTH, EAST, AND WEST			
7. Orientation	7) NW/SE			
8. Dimensions	8) 1.63m (L) X 0.89m (W) HEIGHT UNKNOWN			
9. Associated collapse	9) UNKNOWN			
10. Foundations, cuts & fills	10) UNKNOWN			
11. Repaired	11) UNKNOWN			
12. Associated floors	12) UNKNOWN			
13. Plastered	13) NONE VISIBLE ON PLAN 2008-135			
14. Wall core	14) NO			
15. Types of brick (%)	15) 100% MUDBRICK TYPE OF BRICKS UNKNOWN			
16. Composition of bricks	16) UNKNOWN			
17. Dimensions of bricks (sample of three)	17) UNKNOWN			
Stratigraphic Matrix		NOT EXCAVATED		
		Abuts ? Above Abutted by ? Below Bonded into ? Contiguous with (21921) POSSIBLY		
INTERPRETATION		Enclosing Internal External Reason for decay: FEATURE NUMBER ASSIGNED DURING AERA Indications of original dimensions: DATA CURATION PROJECT. PREVIOUSLY LUMPED Indications of original functions: IN KLT-F TOGETHER WITH WALL (21921)		
REMAINS OF A MUDBRICK WALL THE NW LIMIT OF WHICH FORMED ONE SIDE OF AN ACCESS POINT TO SPACE 11396 - SELIM HASSAN ROOM 181. RELATIONSHIP TO WALL (21921) IS UNKNOWN				
Associated contexts: (21921)				
Context Same As: —				
Drawing Nos: 2008-135				
Photographs (feature in plan, elevation, materials used, surface treatment e.g. plaster, paint etc.)		Finds		Samples (flotation, wet sieve, materials used e.g. bricks, stone, wood, bonding material etc.)
Photograph No.	Description	Description	Artefact no.	Sample No. Description
510920	THIS PHOTO IS OF WALL (21921) BUT (34094) CAN BE SEEN IN IT			
		Phase:	Checked	Initials DCJ Date 07 DEC 2012

(34094)

**Sketch Drawings (in plan and in profile)**

Remember: do not just draw the architectural feature in isolation. Show how it relates to surrounding features and include details of surface treatments, repairs/modifications/damage, bonding material(s), and associated cuts. Annotate all aspects of the feature or use a Drawing Key. Measurements must be included for all aspects of the feature and surrounding features.

**Sketch Plan** - Include grid co-ordinates, North arrow, and elevations.

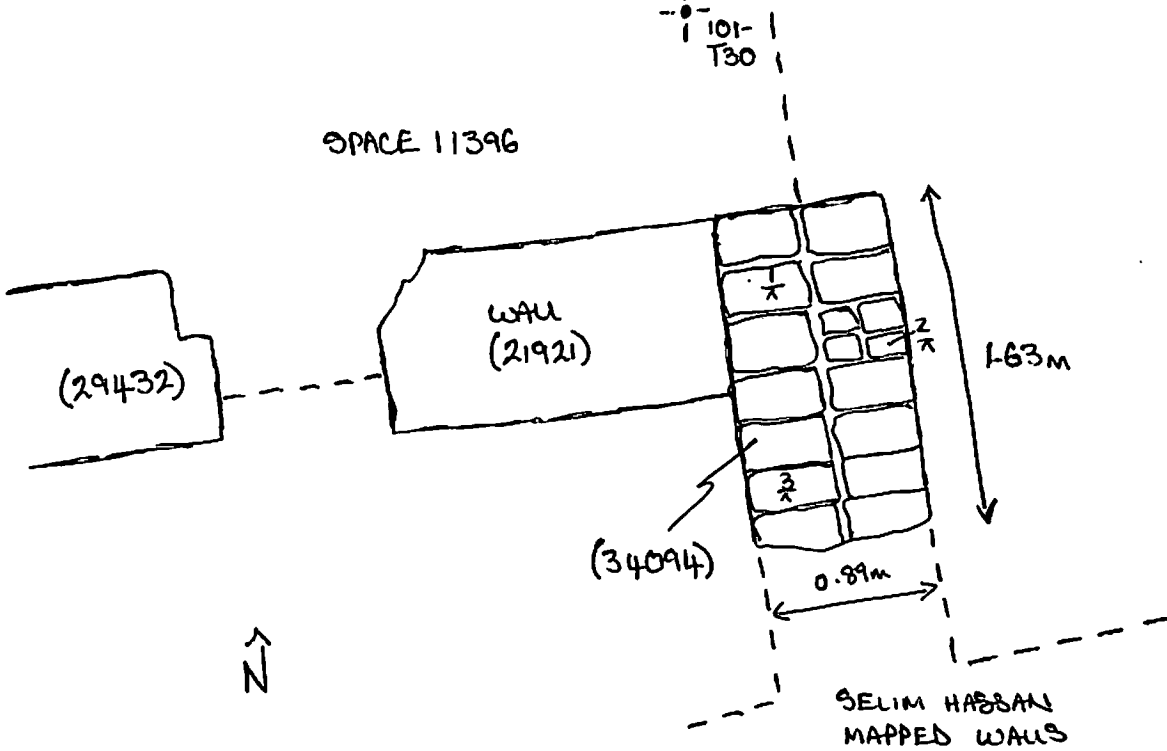

**Profile Sketch**

- State direction the elevation of the feature being drawn is facing e.g. 'West Facing Elevation of Feature ...'
- If feature was drawn in section then include the grid co-ordinates and elevations.

TBM: 18.54  
BS: 1.81  
IH: 20.35

FS	RL
1/x 2.37	17.98
2/x 2.41	17.94
3/x 2.42	17.93