

GPMP GIZA

Site: SAPSZ/LETT Area: KKT-A1	GRID SQUARE(S) 101-S27	ARCHITECTURE	FEATURE 34095									
1. Material	1) LIMESTONE											
2. Size of materials	2) UNKNOWN											
3. Finish	3) ROUGH FACE											
4. Coursing/bond	4) IRREGULAR											
5. Form	5) WALL											
6. Direction of faces	6) NORTH, SOUTH, EAST											
7. Orientation	7) N/S E/W											
8. Dimensions	8) 1.10m (L) x (0.65m (W)) HEIGHT UNKNOWN											
9. Associated collapse	9) UNKNOWN											
10. Finds, cuts & fills	10) "											
11. Repaired	11) "											
12. Associated floors	12) POSSIBLY (30434) IN SPACE 11387											
13. Plastered	13) POSSIBLY WITH (34108) WHICH WAS ON (29286)											
14. Wall core	14) NO											
15. Types of brick (%)	15) 100% STONE - LIMESTONE ?											
16. Composition of bricks	16) -											
17. Dimensions of bricks (sample of three)	17) -											
Stratigraphic Matrix		Abuts	Above									
<table border="1"> <tr><td> </td><td> </td><td> </td></tr> <tr><td> </td><td>34095</td><td> </td></tr> <tr><td> </td><td> </td><td> </td></tr> </table>						34095					Abutted by	Below
	34095											
		Bonded into	(29286)									
		Contiguous with										
INTERPRETATION		Enclosing	Internal									
Reason for decay		NOT EXCAVATED										
Indications of original dimensions		FEATURE NUMBER ASSIGNED DURING AERA										
Indications of original functions		DATA CURATION PROJECT. PREVIOUSLY LUMPED TOGETHER WITH WALL (29286)										
E/W WALL BONDED INTO (29286). ITS EASTERN LIMIT FORMED ONE SIDE OF THE ACCESS POINT BETWEEN SPACES 11386 AND 11387 IN FIELDSTONE STRUCTURE 15253.												
Associated contexts: (29286) (30238)												
Context Same As: (29286)												
Drawing Nos: 2008-68, 2008-9												
<u>Photographs</u> (feature in plan, elevation, materials used, surface treatment e.g. plaster, paint etc.)		<u>Finds</u>										
		Description	Artefact no.									
Photograph No.	Description											
510842	GENERAL SHOT OF SQ 101-S27.											
		<u>Samples</u> (flotation, wet sieve, materials used e.g. bricks, stone, wood, bonding material etc.)										
		Sample No.	Description									
		Phase:	Checked									
			Initials DCJ Date 07 DEC 2012									

(34095)

Sketch Drawings (in plan and in profile)

Remember: do not just draw the architectural feature in isolation. Show how it relates to surrounding features and include details of surface treatments, repairs/modifications/damage, bonding material(s), and associated cuts. Annotate all aspects of the feature or use a Drawing Key. Measurements must be included for all aspects of the feature and surrounding features.

Sketch Plan - Include grid co-ordinates, North arrow, and elevations.

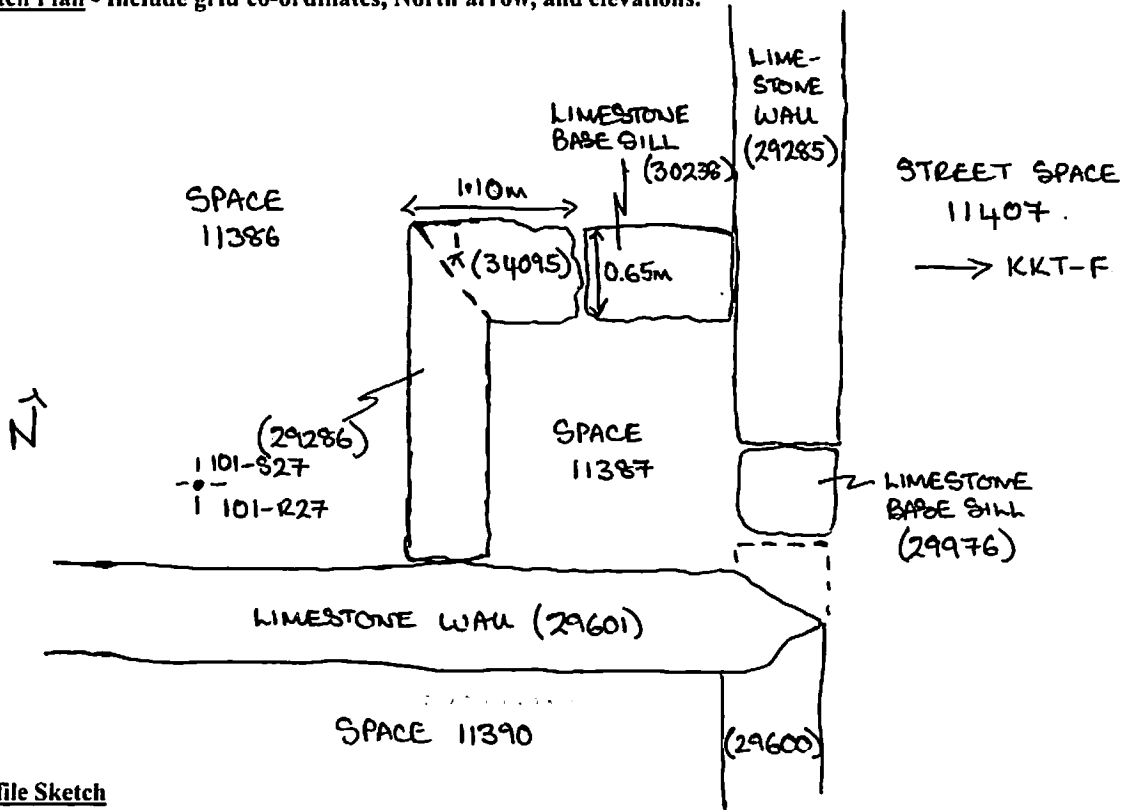

Profile Sketch

- State direction the elevation of the feature being drawn is facing e.g. 'West Facing Elevation of Feature ...
- If feature was drawn in section then include the grid co-ordinates and elevations.

TBM: 18.54
BS: 2.87
IH: 21.41

	FS	RL
$\frac{1}{\pi}$	3.17	18.24

→ FROM DRAWING 2008-9

NO LEVELS ON THE WALL IN DRAWING
2008-68