

GPMP GIZA

Site: <b>SAPSZ/ LTM</b> Area: <b>MVT-E.</b>	GRID SQUARE(S) <b>101-I20, 101-J20</b>	ARCHITECTURE	FEATURE <b>34120</b>
1. Material	<b>1) MUDBRICK</b>		
2. Size of materials	<b>2) UNKNOWN</b>		
3. Finish	<b>3) APPEARS ON PLAN TO BE REGULAR COURSING</b>		
4. Coursing/bond	<b>4) PARTIAL ROW OF STRETCHERS ON EASTERN SIDE,</b>		
5. Form	<b>" " " HEADERS " WESTERN "</b>		
6. Direction of faces	<b>5) WALL</b>		
7. Orientation	<b>6) E/W</b>		
8. Dimensions	<b>7) N/S</b>		
9. Associated collapse	<b>8) 2.61m (L) X 0.61m (W) HEIGHT UNKNOWN</b>		
10. Founds, cuts & fills	<b>9) POSSIBLY (33376)</b>		
11. Repaired	<b>10) UNKNOWN</b>		
12. Associated floors	<b>11) "</b>		
13. Plastered	<b>12) "</b>		
14. Wall core	<b>13) "</b>		
15. Types of brick (%)	<b>14) "</b>		
16. Composition of bricks	<b>15) "</b>		
17. Dimensions of bricks (sample of three)	<b>16) "</b>		
	<b>17) UNKNOWN</b>		
Stratigraphic Matrix			Abuts Above Abutted by Below Bonded into Contiguous with
INTERPRETATION	<b>Enclosing</b> Internal External		
Reason for decay	<b>NOT EXCAVATED</b>		
Indications of original dimensions	<b>NUMBER ASSIGNED DURING AERA DATA</b>		
Indications of original functions	<b>CURATION PROJECT. PREVIOUSLY LUMPED</b>		
<b>TOGETHER WITH (33376).</b>			
<b>REMAINS OF A N/S WALL. RELATIONSHIP TO WALL (34119) &amp; (33375) UNKNOWN.</b>			
Associated contexts: <b>(34119)</b> .			
Context Same As: <b>/</b>			
Drawing Nos: <b>2012-91, 2012-24</b>			
<b>Photographs</b> (feature in plan, elevation, materials used, surface treatment e.g. plaster, paint etc.)		<b>Finds</b>	
		Description	Artefact no.
Photograph No.	Description	/	
		<b>Samples</b> (flotation, wet sieve, materials used e.g. bricks, stone, wood, bonding material etc.)	
		Sample No.	Description
		/	
		Phase:	Checked
		Initials <b>DCJ</b> Date <b>08 JAN 2013</b>	

(34120)

**Sketch Drawings (in plan and in profile)**

Remember: do not just draw the architectural feature in isolation. Show how it relates to surrounding features and include details of surface treatments, repairs/modifications/damage, bonding material(s), and associated cuts. Annotate all aspects of the feature or use a Drawing Key. Measurements must be included for all aspects of the feature and surrounding features.

**Sketch Plan** - Include grid co-ordinates, North arrow, and elevations.

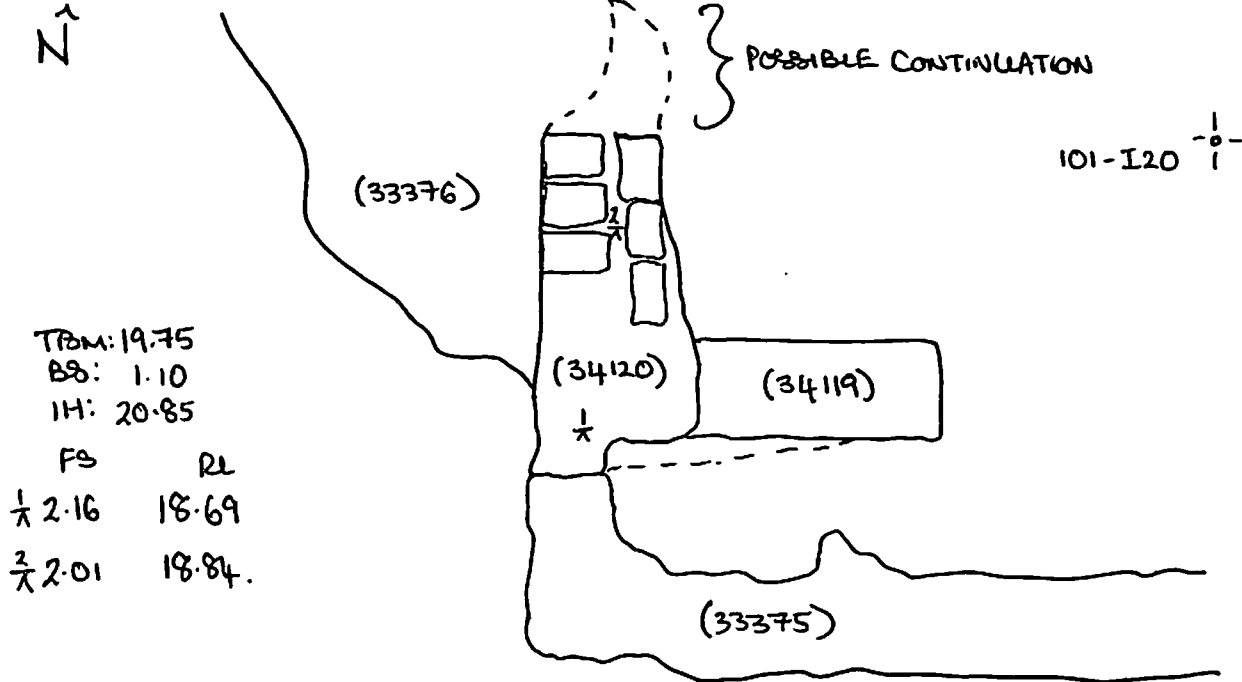

**Profile Sketch**

- State direction the elevation of the feature being drawn is facing e.g. 'West Facing Elevation of Feature ...
- If feature was drawn in section then include the grid co-ordinates and elevations.