

GIZA PLATEAU MAPPING PROJECT

Grid Square(s) 101-X29	Area KYT-F	Context Type DEPOSIT	Central Coords	Context 34227
DEPOSIT				CUT
<ol style="list-style-type: none"> 1. Compaction 2. Colour 3. Composition/Particle Size (Over 10%) 4. Inclusions (Under 10%) occa / mod / freq 5. Thickness and extent 6. Top and bottom boundaries 7. Other comments 8. Method and conditions 				<ol style="list-style-type: none"> 1. Shape in plan 2. Corners 3. Dimension/Depth 4. Break of slope-top 5. Sides 6. Break of slope-base 7. Base 8. Orientation 9. Inclination of axis 10. Truncated (if known) 11. Fill #s 12. Other comments
				5) 0.41m (L) X 0.04m THICK.
				Draw profile overleaf

Type of feature: **SURFACE TREATMENT.**

Stratigraphic Matrix

<input type="checkbox"/>	<input type="checkbox"/>	<input type="checkbox"/>	<input type="checkbox"/>	<input type="checkbox"/>	<input type="checkbox"/>	<input type="checkbox"/>	<input type="checkbox"/>	<input type="checkbox"/>	<input type="checkbox"/>	<input type="checkbox"/>
			34227							
<input type="checkbox"/>	<input type="checkbox"/>	<input type="checkbox"/>	<input type="checkbox"/>	<input type="checkbox"/>	<input type="checkbox"/>	<input type="checkbox"/>	<input type="checkbox"/>	<input type="checkbox"/>	<input type="checkbox"/>	<input type="checkbox"/>

Your interpretation: Internal External ? Structural Other (specify)

Your discussion: **NOT EXCAVATED - NUMBER ASSIGNED DURING DATA CURATION PROJECT.**

**SURFACE TREATMENT (MATERIAL UNKNOWN) ON THE
NW FACING ELEVATION OF WALL (34226).**

Placement in square

Context same as:	See contexts:
Site Book Refs:	Matrix phase: Initials and date DCS 03 FEB 2013.

Checked Interpretation:

Provisional period	Group/Phase	Initials and date
--------------------	-------------	-------------------

Context Number 34227

GPMP 2013

Bag Numbers

Ceramics

Objects

Environmental Samples & Type

Exotics

Charcoal

Other

Bones

Lithics

Photographs

Drawings

Plans 2005-1418 .

Sections

Top Elevation

Bottom Elevations

Sketch Plan NOT TO SCALE

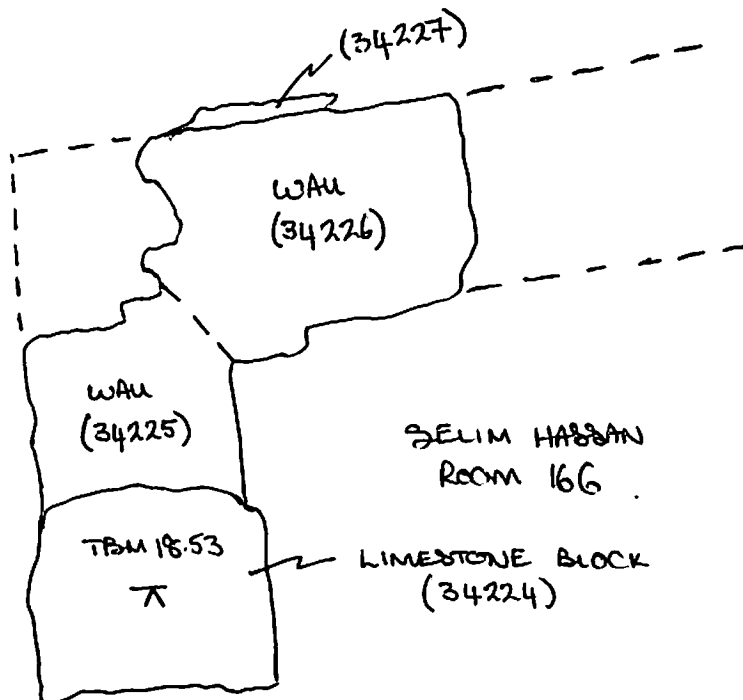

101-X29.