

GPMP GIZA

Site: SAPS 2 / LFM Area: KKT, KKT-E.	GRID SQUARE(S) 101- Y35	ARCHITECTURE	FEATURE 34249.
1. Material	1) LIMESTONE.		
2. Size of materials	2) 0.32m (L) X 0.31m (W).		
3. Finish	3) WORKED STONE.		
4. Coursing/bond	4) N/A.		
5. Form	5) BASE SILL (THRESHOLD).		
6. Direction of faces	6) N/A		
7. Orientation	7) NW/SE.		
8. Dimensions	8) SEE #2.		
9. Associated collapse	9) NONE.		
10. Founds, cuts & fills	10) CUT [33005] ON UPPER SURFACE.		
11. Repaired	11) NO		
12. Associated floors	12) NONE.		
13. Plastered	13) NO		
14. Wall core	14) "		
15. Types of brick (%)	15) N/A		
16. Composition of bricks	16) N/A.		
17. Dimensions of bricks (sample of three)	17) SEE #2.		
Stratigraphic Matrix			Abuts (33004) Above Abutted by Below Bonded into Contiguous with (33004) [33005]
INTERPRETATION	Enclosing	<u>Internal</u>	External
Reason for decay	NOT EXCAVATED - NUMBER ASSIGNED DURING		
Indications of original dimensions	DATA CURATION PROJECT.		
Indications of original functions			
SEMI-SQUARE WORKED PIECE OF LIMESTONE AT THE WESTERN END OF LIMESTONE (33004). HAD A RECTANGULAR SHALLOW CUT [33005] ON THE SOUTHERN SIDE THAT MAY HAVE ONCE HELD A WOODEN UPRIGHT PART OF THE BASE SILL THRESHOLD ARRANGEMENT AT THE EASTERN END OF STREET SPACE 11373.			
Associated contexts: (33004) [33005]			
Context Same As: /			
Drawing Nos: 2011-217.			
Photographs (feature in plan, elevation, materials used, surface treatment e.g. plaster, paint etc.)		Finds	
		Description	Artefact no
Photograph No. Description		Samples (flotation, wet sieve, materials used e.g. bricks, stone, wood, bonding material etc.)	
Sample No. Description			
613371		/	
918421			
918422			
918423			
613372	OF CUT		
613373	[33005]	Phase:	Checked
			Initials DCS Date

(34249)

Sketch Drawings (in plan and in profile)

Remember: do not just draw the architectural feature in isolation. Show how it relates to surrounding features and include details of surface treatments, repairs/modifications/damage, bonding material(s), and associated cuts. Annotate all aspects of the feature or use a Drawing Key. Measurements must be included for all aspects of the feature and surrounding features.

Sketch Plan - Include grid co-ordinates, North arrow, and elevations.

NOT TO SCALE \hat{N}

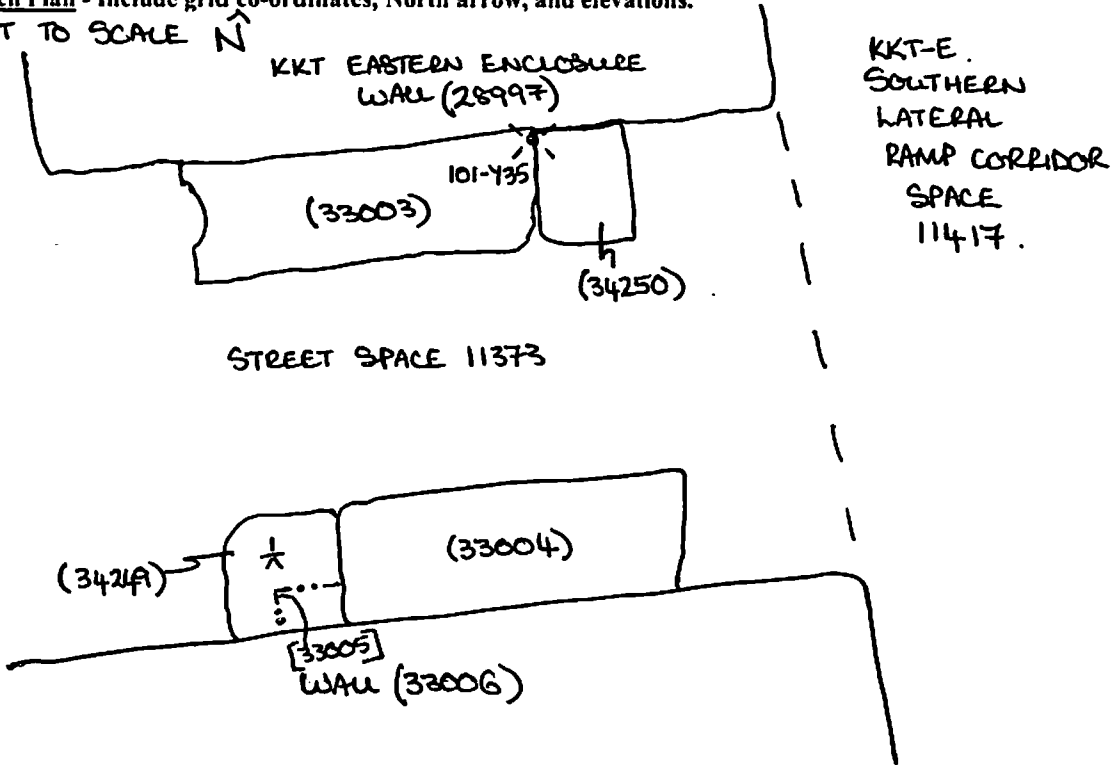

Profile Sketch

- State direction the elevation of the feature being drawn is facing e.g. 'West Facing Elevation of Feature
- If feature was drawn in section then include the grid co-ordinates and elevations.

TBM: 17.68

BS: 1.19

IH: 18.87

FS	RL
1/2 2.14	16.73