

GPMG GIZA

Site: SAPS2/LTA1 Area: KKT-N	GRID SQUARE(S) 201-E32	ARCHITECTURE	FEATURE 34295
1. Material	1) MUDBRICK		
2. Size of materials	2) 0.34m (L) X 0.19m (W)		
3. Finish	3) REGULAR		
4. Coursing/bond	4) 2 ROWS OF HEADERS		
5. Form	5) WALL		
6. Direction of faces	6) NE/SW		
7. Orientation	7) NW/SE		
8. Dimensions	8) 1.98m (L) X 0.73m (W)		
9. Associated collapse	9) UNKNOWN		
10. Founds, cuts & fills	10) "		
11. Repaired	11) WITH (28400)		
12. Associated floors	12) UNKNOWN		
13. Plastered	13) "		
14. Wall core	14) "		
15. Types of brick (%)	15) "		
16. Composition of bricks	16) "		
17. Dimensions of bricks (sample of three)	17) SEE #2.		
Stratigraphic Matrix			Abuts Above Abutted by Below Bonded into Contiguous with (28370)(28400)
INTERPRETATION	(Enclosing) Internal External		
Reason for decay	NOT EXCAVATED - NUMBER ASSIGNED DURING DATA		
Indications of original dimensions	CREATION PROJECT.		
Indications of original functions			
REMAINS OF THE EASTERN WALL OF STRUCTURE 15258, BOUNDARY WALL FOR SPACE 11534 & 11535 IN STRUCTURE 15258 & STREET SPACE 11374.			
Associated contexts:			
Context Same As: <input checked="" type="checkbox"/>			
Drawing Nos: 2007-207			
Photographs (feature in plan, elevation, materials used, surface treatment e.g. plaster, paint etc.) Photograph No. Description	Finds Description Artefact no.		Samples (flotation, wet sieve materials used e.g. bricks, stone, wood, bonding material etc.) Sample No. Description
	Phase:		

(34295)

Sketch Drawings (in plan and in profile)

Remember: do not just draw the architectural feature in isolation. Show how it relates to surrounding features and include details of surface treatments, repairs/modifications/damage, bonding material(s), and associated cuts. Annotate all aspects of the feature or use a Drawing Key. Measurements must be included for all aspects of the feature and surrounding features.

Sketch Plan - Include grid co-ordinates, North arrow, and elevations.

NOT TO SCALE \uparrow

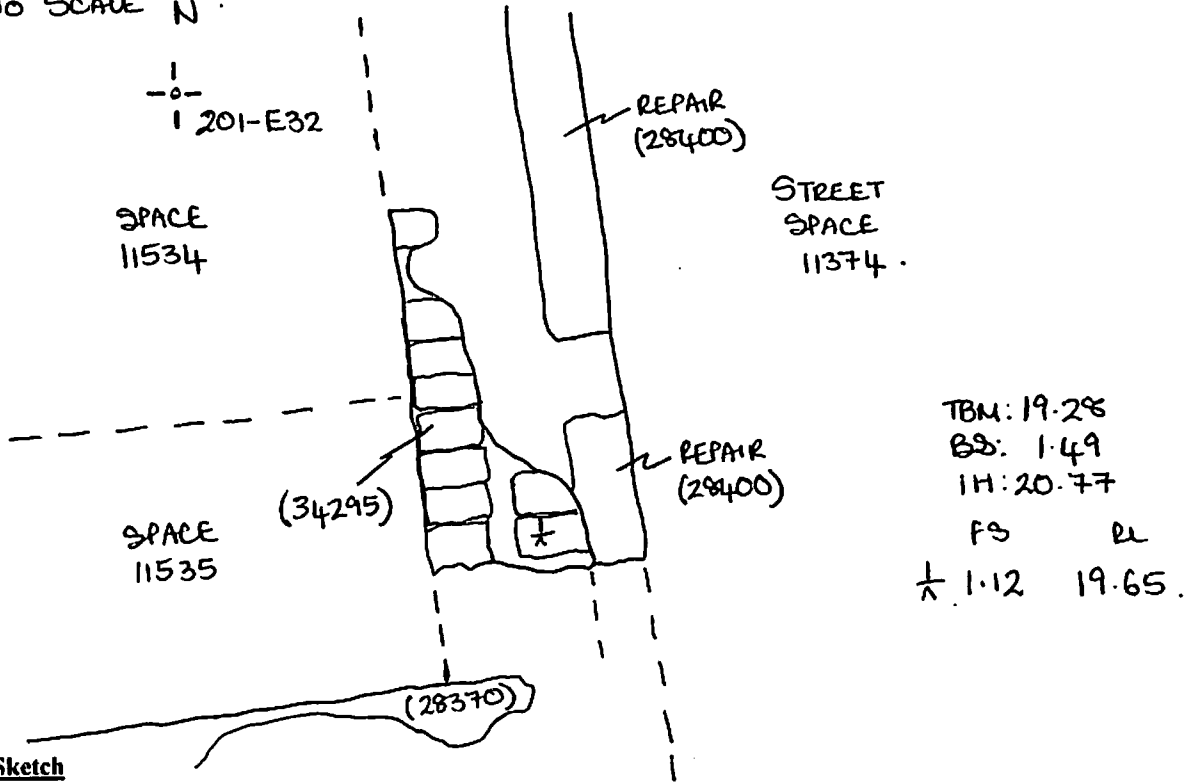

Profile Sketch

- State direction the elevation of the feature being drawn is facing e.g. 'West Facing Elevation of Feature
- If feature was drawn in section then include the grid co-ordinates and elevations.