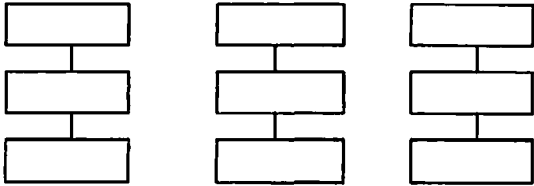

GPMP GIZA

Site: SAFS 2/ LTA4 Area: KKT-N	GRID SQUARE(S) 201-F31	ARCHITECTURE	FEATURE 34297
-----------------------------------	---------------------------	--------------	------------------

1. Material	1) MUDBRICK
2. Size of materials	2) 0.39m (L) X 0.18m (W) FROM PLAN
3. Finish	3) REGULAR
4. Coursing/bond	4) ONE ROW OF HEADERS (EAST) & ONE ROW OF STRETCHERS (WEST)
5. Form	5) WALL
6. Direction of faces	6) NE/SW
7. Orientation	7) NW/SE
8. Dimensions	8) 3m (L) X 0.65m (W).
9. Associated collapse	9) UNKNOWN
10. Founds, cuts & fills	10) "
11. Repaired	11) WITH (28373) & (28385)
12. Associated floors	12) UNKNOWN
13. Plastered	13) "
14. Wall core	14) "
15. Types of brick (%)	15) "
16. Composition of bricks	16) "
17. Dimensions of bricks (sample of three)	17) SEE #2.

Stratigraphic Matrix 	Abuts	Above
	Abutted by	Below
	Bonded into	
	Contiguous with (28392) (34298)	

INTERPRETATION	Enclosing	Internal	External
Reason for decay	NOT EXCAVATED - NUMBER ASSIGNED DURING DATA CURATION PROJECT.		
Indications of original dimensions			
Indications of original functions			

REMAINS OF THE ORIGINAL WALL THAT BOUNDED SPACE 11536, 11534
IN STRUCTURE 15258

Associated contexts:	
Context Same As:	
Drawing Nos:	2007-185

Photographs (feature in plan, elevation, materials used, surface treatment e.g. plaster, paint etc.)	Finds		Samples (flotation, wet sieve, materials used e.g. bricks, stone, wood, bonding material etc.)	
	Description	Artefact no.	Sample No.	Description
Photograph No.	Description			
		Phase:	Checked	Initials DCJ Date 03 APRIL 2013.

(34297)

Sketch Drawings (in plan and in profile)

Remember: do not just draw the architectural feature in isolation. Show how it relates to surrounding features and include details of surface treatments, repairs/modifications/damage, bonding material(s), and associated cuts. Annotate all aspects of the feature or use a Drawing Key. Measurements must be included for all aspects of the feature and surrounding features.

Sketch Plan - Include grid co-ordinates, North arrow, and elevations.

NOT TO SCALE N ↑

201-F31. 1/0

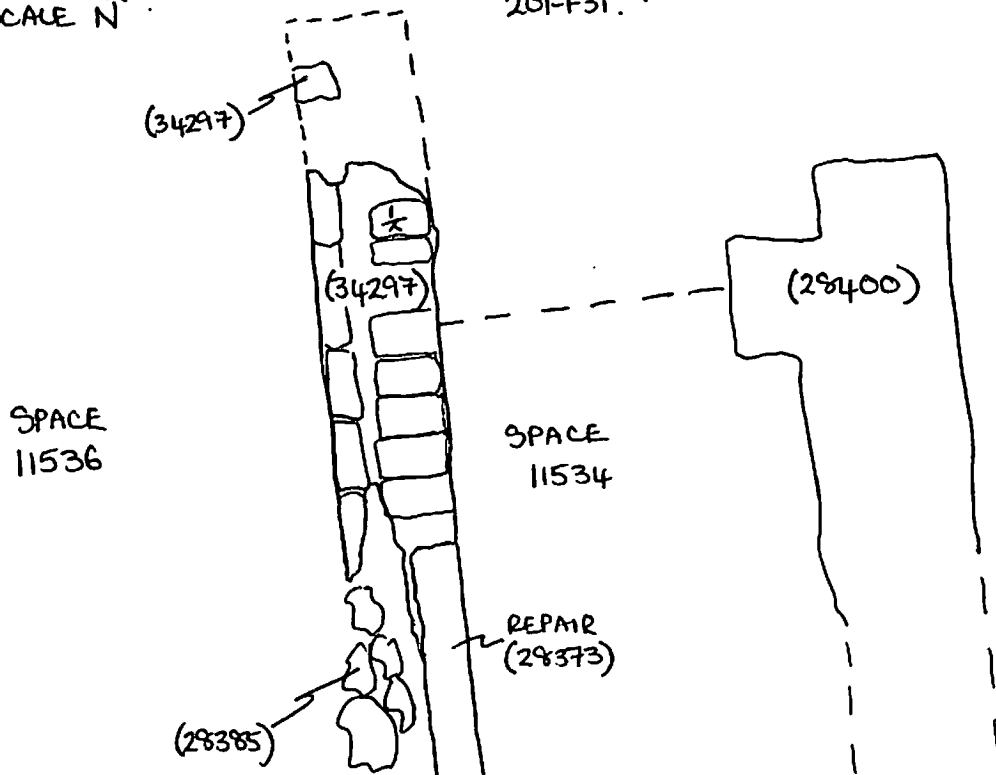

Profile Sketch

- State direction the elevation of the feature being drawn is facing e.g. 'West Facing Elevation of Feature ...
- If feature was drawn in section then include the grid co-ordinates and elevations.

TBM: 21.38

BS: 1.27

IH: 22.65

FS RL

1/2 2.10 20.55