

GPMP GIZA

Site: <b>SAPS 2 / LFM</b> Area: <b>KKT-N</b>		GRID SQUARE(S) <b>201-E31</b>	ARCHITECTURE	FEATURE <b>34300</b>									
1. Material	<b>1) MUDBRICK</b>												
2. Size of materials	<b>2) 0.18m (L) x 0.08m (W) FROM PLAN</b>												
3. Finish	<b>3) REGULAR</b>												
4. Coursing/bond	<b>4) 2 PARALLEL ROWS OF STRETCHERS &amp; A ROW OF HEADERS</b>												
5. Form	<b>5) WALL REPAIR</b>												
6. Direction of faces	<b>6) E/W</b>												
7. Orientation	<b>7) N/S</b>												
8. Dimensions	<b>8) 2.41m (L) x 0.18m (W)</b>												
9. Associated collapse	<b>9) UNKNOWN</b>												
10. Founds, cuts & fills	<b>10) "</b>												
11. Repaired	<b>11) N/A</b>												
12. Associated floors	<b>12) UNKNOWN</b>												
13. Plastered	<b>13) "</b>												
14. Wall core	<b>14) "</b>												
15. Types of brick (%)	<b>15) UNKNOWN BUT POSSIBLY THE LITTLE BROWN BUENT BRICKS</b>												
16. Composition of bricks	<b>16) UNKNOWN</b>												
17. Dimensions of bricks (sample of three)	<b>17) SEE #2.</b>												
Stratigraphic Matrix		Abuts		Above									
<table border="1"> <tr><td> </td><td> </td><td> </td></tr> <tr><td> </td><td>34300</td><td> </td></tr> <tr><td> </td><td> </td><td> </td></tr> </table>						34300					Abutted by		Below
	34300												
		Bonded into											
		Contiguous with		<b>(28372)(28371)</b>									
INTERPRETATION		Enclosing		<u>Internal</u>									
Reason for decay		External											
Indications of original dimensions		<b>NOT EXCAVATED - NUMBER ASSIGNED DURING DATA CURATION PROJECT.</b>											
Indications of original functions													
<b>REMAINS OF THE REPAIR TO WALL (28371)</b>													
<b>SPACE 11541 &amp; 11535, STRUCTURE 15258</b>													
Associated contexts:													
Context Same As:													
Drawing Nos: <b>2007-186</b>													
<b>Photographs</b> (feature in plan, elevation, materials used, surface treatment e.g. plaster, paint etc.)		<b>Finds</b>		<b>Samples</b> (flotation, wet sieve, materials used e.g. bricks, stone, wood, bonding material etc.)									
Photograph No.	Description	Description	Artefact no.	Sample No. Description									
		Phase:	Checked	Initials <b>DCS</b> Date <b>03 APRIL 2013</b>									

(34300)

Sketch Drawings (in plan and in profile)

Remember: do not just draw the architectural feature in isolation. Show how it relates to surrounding features and include details of surface treatments, repairs/modifications/damage, bonding material(s), and associated cuts. Annotate all aspects of the feature or use a Drawing Key. Measurements must be included for all aspects of the feature and surrounding features.

Sketch Plan - Include grid co-ordinates, North arrow, and elevations.

NOT TO SCALE  $\hat{N}$

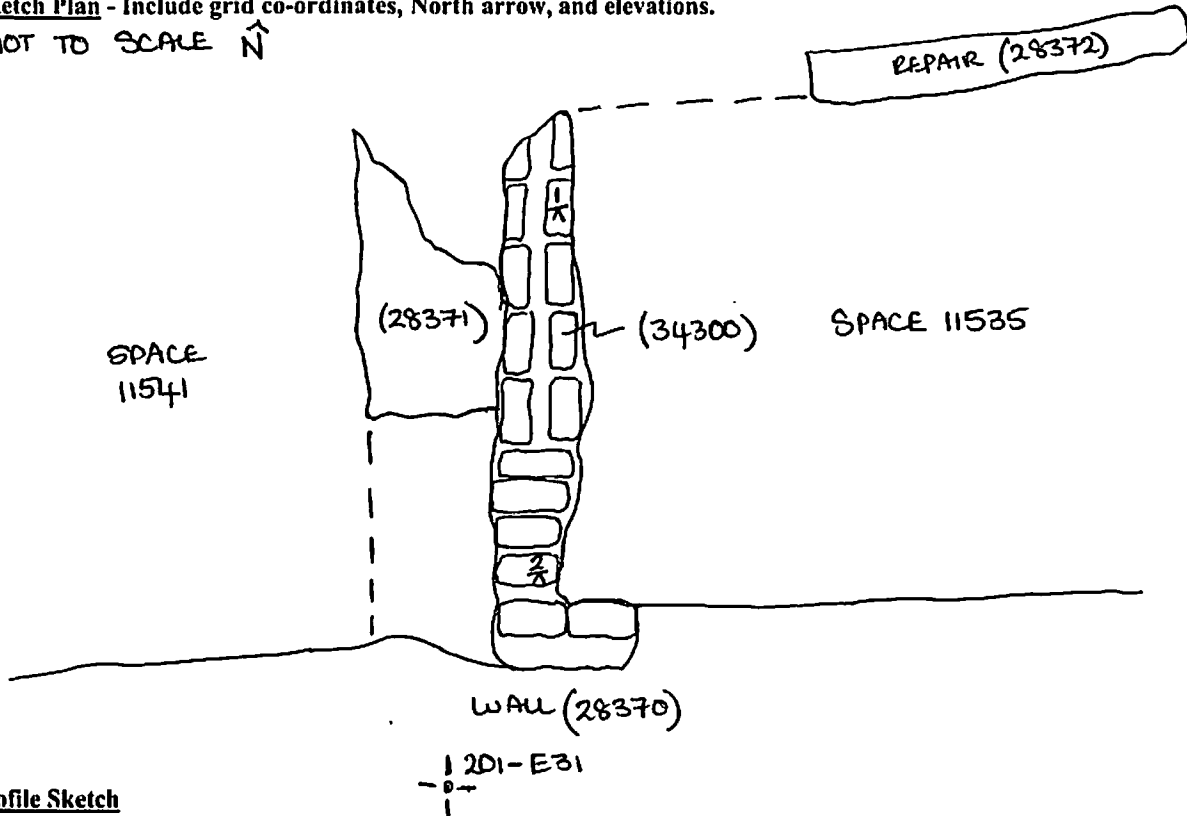

Profile Sketch

- State direction the elevation of the feature being drawn is facing e.g. 'West Facing Elevation of Feature ....
- If feature was drawn in section then include the grid co-ordinates and elevations.

TBM: 21.38  
BS: 1.24  
14: 22.62  
FS      RL  
+ 2.59    2.03  
2    2.74    19.88 .