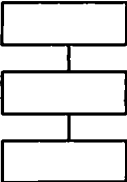
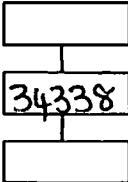
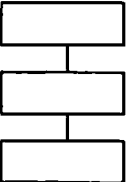

GPMP GIZA

Site: SATS-2/LTA4 Area: KKT-N	GRID SQUARE(S) 201-E26	ARCHITECTURE	FEATURE 34338
1. Material	1) UNKNOWN		
2. Size of materials	2) "		
3. Finish	3) "		
4. Coursing/bond	4) N/A		
5. Form	5) WALL CORE.		
6. Direction of faces	6) -		
7. Orientation	7) NE/SW		
8. Dimensions	8) 2.78m (L) x 0.12m (W)		
9. Associated collapse	9) UNKNOWN		
10. Founds, cuts & fills	10) "		
11. Repaired	11) "		
12. Associated floors	12) "		
13. Plastered	13) N/A		
14. Wall core	14) "		
15. Types of brick (%)	15) UNKNOWN		
16. Composition of bricks	16) "		
17. Dimensions of bricks (sample of three)	17) "		
Stratigraphic Matrix <div style="display: flex; justify-content: space-around; align-items: center;"> <div style="text-align: center;">  </div> <div style="text-align: center;">  </div> <div style="text-align: center;">  </div> </div>		Abuts Above Abutted by Below Bonded into Contiguous with	
INTERPRETATION		Enclosing Internal External	
Reason for decay	NOT EXCAVATED - NUMBER ASSIGNED DURING DATA CURATION PROJECT. DRAWN BUT NOT NUMBERED.		
Indications of original dimensions			
Indications of original functions			
WALL CORE FOR EITHER REPAIR (34337) OR ORIGINAL WALL (27637) SPACE: 11549, 11551 STRUCTURE: 15256			
Associated contexts:			
Context Same As: (34339)			
Drawing Nos: 2007-37			
Photographs <small>(feature in plan, elevation, materials used, surface treatment e.g. plaster, paint etc.)</small>	Finds		Samples <small>(notation, wet sieve, materials used e.g. bricks, stone, wood, bonding material etc.)</small>
Photograph No.	Description	Description	Artefact no.
		Phase:	Checked
			Initials DCS Date 13 APRIL 2013

(34338)

Sketch Drawings (in plan and in profile)

Remember: do not just draw the architectural feature in isolation. Show how it relates to surrounding features and include details of surface treatments, repairs/modifications/damage, bonding material(s), and associated cuts. Annotate all aspects of the feature or use a Drawing Key. Measurements must be included for all aspects of the feature and surrounding features.

Sketch Plan - Include grid co-ordinates, North arrow, and elevations.

NOT TO SCALE \uparrow

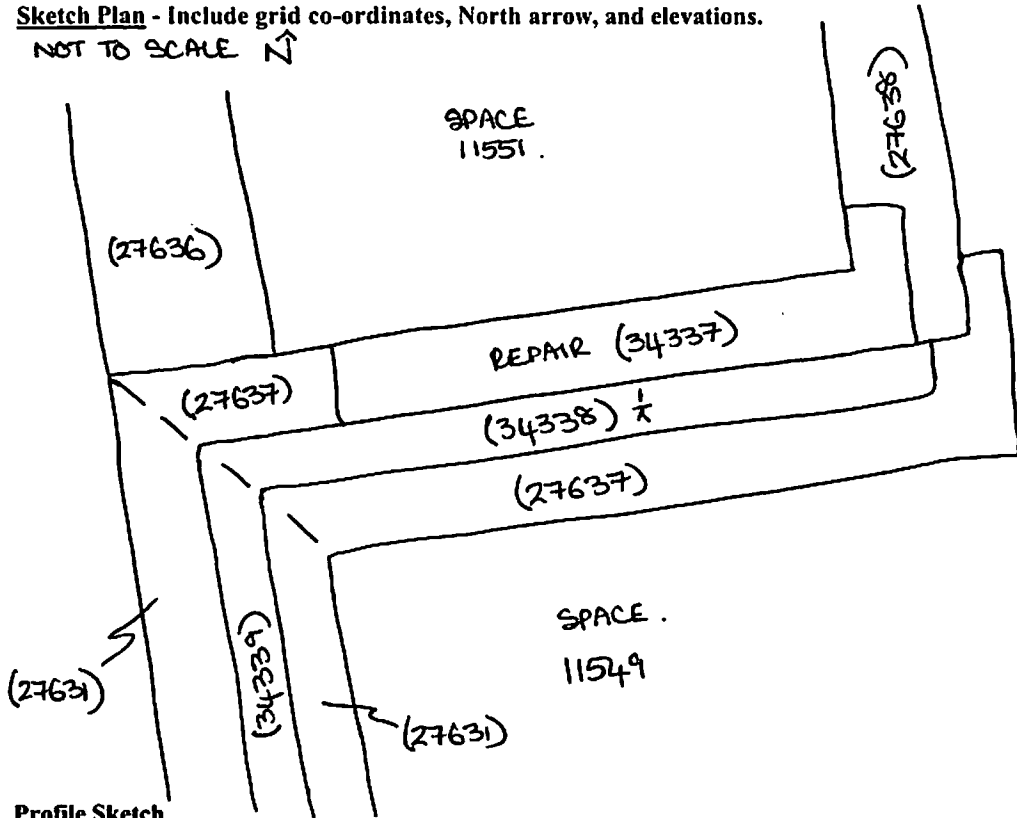

TBM: 23.26
BB: 0.56
IH: 23.82
FS RL
1/2 2.13 21.69

201-E26
- 0 -

Profile Sketch

- State direction the elevation of the feature being drawn is facing e.g. 'West Facing Elevation of Feature'
- If feature was drawn in section then include the grid co-ordinates and elevations.