

GPMP GIZA

Site: <b>SAPS 2 / LFM</b> Area: <b>IKLT-N</b>	GRID SQUARE(S) <b>201-E25</b>	ARCHITECTURE	FEATURE <b>34340</b>
1. Material	1) UNKNOWN BUT APPEARS MIXED FROM PLAN		
2. Size of materials	2) 0.07m (L) X 0.05m (W) LARGEST PIECE.		
3. Finish	3) IRREGULAR		
4. Coursing/bond	4) "		
5. Form	5) WALL CORE.		
6. Direction of faces	6) N/A		
7. Orientation	7) NW/SE.		
8. Dimensions	8) 1.15m (L) X 0.31m (W).		
9. Associated collapse	9) UNKNOWN		
10. Founds, cuts & fills	10) "		
11. Repaired	11) "		
12. Associated floors	12) "		
13. Plastered	13) NO		
14. Wall core	14) N/A		
15. Types of brick (%)	15) UNKNOWN		
16. Composition of bricks	16) "		
17. Dimensions of bricks (sample of three)	17) "		
Stratigraphic Matrix			Abuts Above Abutted by Below Bonded into Contiguous with
INTERPRETATION	Enclosing	<u>Internal</u>	External
Reason for decay	NOT EXCAVATED - NUMBER ASSIGNED DURING DATA		
Indications of original dimensions	CURATION PROJECT		
Indications of original functions			
CORE OF EITHER REPAIR WALL (29699) OR ORIGINAL WALL (29697)			
8 (29700)			
SPACE: 11553, 11555			
STRUCTURE: 15256			
Associated contexts:			
Context Same As:			
Drawing Nos: 2008-18			
<u>Photographs</u> (feature in plan, elevation, materials used, surface treatment e.g. plaster, paint etc.) Photograph No.      Description	<u>Finds</u> Description      Artefact no.		<u>Samples</u> (Notation, wet sieve, materials used e.g. bricks, stone, wood, bonding material etc.) Sample No.      Description
	Phase:		Checked      Initials DCJ Date 14 APRIL 2013

34340

Sketch Drawings (in plan and in profile)

Remember: do not just draw the architectural feature in isolation. Show how it relates to surrounding features and include details of surface treatments, repairs/modifications/damage, bonding material(s), and associated cuts. Annotate all aspects of the feature or use a Drawing Key. Measurements must be included for all aspects of the feature and surrounding features.

Sketch Plan - Include grid co-ordinates, North arrow, and elevations.

NOT TO SCALE  $\uparrow$

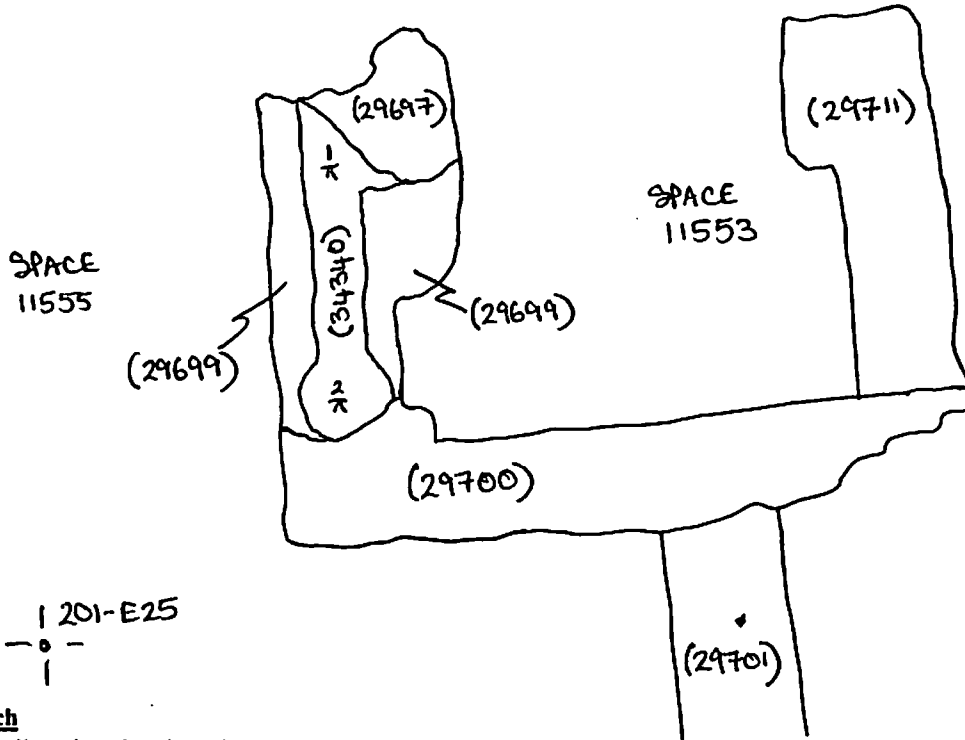

Profile Sketch

- State direction the elevation of the feature being drawn is facing e.g. 'West Facing Elevation of Feature ....
- If feature was drawn in section then include the grid co-ordinates and elevations.

REDUCED LEVEL ONLY RECORDED ON PLAN

$\frac{1}{\pi}$  22.20

$\frac{2}{\pi}$  22.10 .