

CPMP GIZA

Site: SAPS 27-ETM Area: KKT-N		GRID SQUARE(S) 201-F25	ARCHITECTURE	FEATURE 34342									
1. Material	1) MIXED FRAGMENTS ON PLAN												
2. Size of materials	2) 0.12m (L) X 0.06m (W) FROM PLAN LARGEST PIECE												
3. Finish	3) IRREGULAR												
4. Coursing/bond	4) UNKNOWN												
5. Form	5) WALL CORE												
6. Direction of faces	6) N/A												
7. Orientation	7) NW/SE												
8. Dimensions	8) 1.31m (L) X 0.25m (W)												
9. Associated collapse	9) UNKNOWN												
10. Founds, cuts & fills	10) "												
11. Repaired	11) "												
12. Associated floors	12) "												
13. Plastered	13) NO												
14. Wall core	14) N/A												
15. Types of brick (%)	15) UNKNOWN												
16. Composition of bricks	16) "												
17. Dimensions of bricks (sample of three)	17) "												
Stratigraphic Matrix		Abuts		Above									
<table border="1"> <tr><td> </td><td> </td><td> </td></tr> <tr><td> </td><td>34342</td><td> </td></tr> <tr><td> </td><td> </td><td> </td></tr> </table>						34342					Abutted by		Below
	34342												
		Bonded into											
		Contiguous with											
INTERPRETATION													
		Enclosing		<u>Internal</u>									
				External									
Reason for decay		NOT EXCAVATED - NUMBER ASSIGNED DURING DATA CURATION PROJECT.											
Indications of original dimensions													
Indications of original functions													
CORE OF REPAIR WALL (29333)													
SPACE: 11556													
STRUCTURE: 15256													
Associated contexts:													
Context Same As:													
Drawing Nos: 2008-5													
<u>Photographs</u> (feature in plan, elevation, materials used, surface treatment e.g. plaster, paint etc.)		<u>Finds</u>		<u>Samples</u> (notation, wet sieve, materials used e.g. bricks, stone, wood, bonding material etc.)									
Photograph No.	Description	Description	Artefact no.	Sample No. Description									
		Phase:	Checked	Initials DCJ Date 14 APRIL 2013									

(34342)

Sketch Drawings (in plan and in profile)

Remember: do not just draw the architectural feature in isolation. Show how it relates to surrounding features and include details of surface treatments, repairs/modifications/damage, bonding material(s), and associated cuts. Annotate all aspects of the feature or use a Drawing Key. Measurements must be included for all aspects of the feature and surrounding features.

Sketch Plan - Include grid co-ordinates, North arrow, and elevations.

NOT TO SCALE \hat{N}

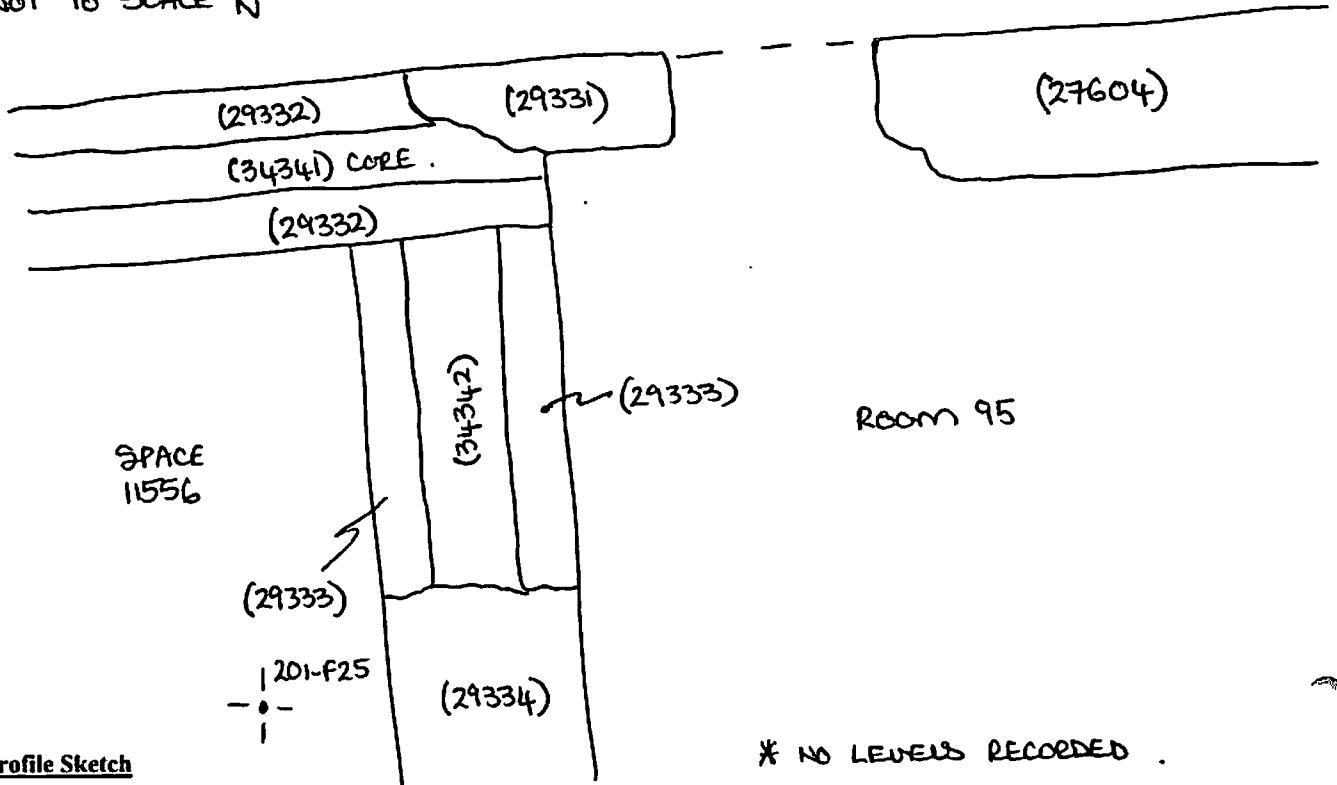

Profile Sketch

- State direction the elevation of the feature being drawn is facing e.g. 'West Facing Elevation of Feature
- If feature was drawn in section then include the grid co-ordinates and elevations.