

GPMP GIZA

Site: SAPS 2/LTM Area: KKT-N	GRID SQUARE(S) 201-D24, 201-E24	ARCHITECTURE	FEATURE 34344
1. Material	1) MIXED		
2. Size of materials	2) 0.13m (h) X 0.11m (w) LARGEST PIECE ON PLAN		
3. Finish	3) IRREGULAR		
4. Coursing/bond	4) UNKNOWN		
5. Form	5) WALL CORE		
6. Direction of faces	6) N/A		
7. Orientation	7) NW/SE		
8. Dimensions	8) 3.42m (h) X 0.68m (w)		
9. Associated collapse	9) UNKNOWN		
10. Founds, cuts & fills	10) "		
11. Repaired	11) "		
12. Associated floors	12) "		
13. Plastered	13) NO		
14. Wall core	14) N/A		
15. Types of brick (%)	15) UNKNOWN		
16. Composition of bricks	16) "		
17. Dimensions of bricks (sample of three)	17) "		
Stratigraphic Matrix			Abuts Above Abutted by Below Bonded into Contiguous with
INTERPRETATION	Enclosing	Internal	External
Reason for decay	NOT EXCAVATED - NUMBER ASSIGNED DURING DATA		
Indications of original dimensions	CREATION PROJECT.		
Indications of original functions			
CORE OF EITHER REPAIR WALL (29676) OR ORIGINAL WALL (29351)			
SPACE: 11557, 11558, 11559, 11554, 11555			
STRUCTURE: 15255, 15256			
Associated contexts: (34343) POSSIBLY			
Context Same As: ✓			
Drawing Nos: 2008-17, 2008-20			
Photographs (feature in plan, elevation, materials used, surface treatment e.g. plaster, paint etc.)	Finds		Samples (notation, wet sieve, materials used e.g. bricks, stone, wood, bonding material etc.)
Photograph No. Description	Description	Artefact no.	Sample No. Description
	Phase:	Checked	Initials DCS Date 15 APRIL 2013

34344 .

Sketch Drawings (in plan and in profile)

Remember: do not just draw the architectural feature in isolation. Show how it relates to surrounding features and include details of surface treatments, repairs/modifications/damage, bonding material(s), and associated cuts. Annotate all aspects of the feature or use a Drawing Key. Measurements must be included for all aspects of the feature and surrounding features.

Sketch Plan - Include grid co-ordinates, North arrow, and elevations.

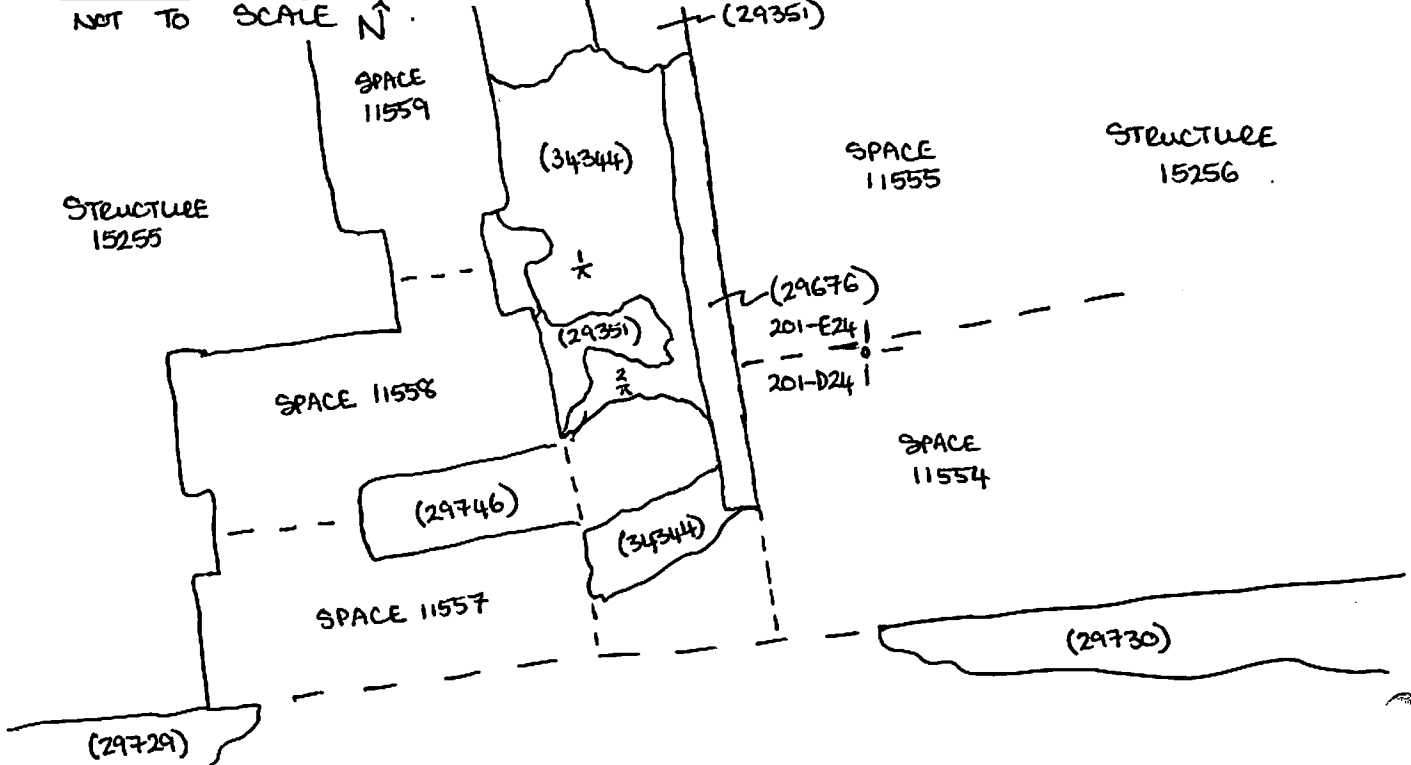

Profile Sketch

- State direction the elevation of the feature being drawn is facing e.g. 'West Facing Elevation of Feature
- If feature was drawn in section then include the grid co-ordinates and elevations.

ONLY REDUCED LEVELS RECORDED ON PLAN.

$\frac{1}{1}$ 22.38

$\frac{2}{2}$ 22.21