

GPMP GIZA

Site: SAPS 2/L7M Area: KKT-N	GRID SQUARE(S) 201-D24	ARCHITECTURE	FEATURE 34347
1. Material	1) MUDBRICK		
2. Size of materials	2) 0.18m X 0.18m FROM PLAN		
3. Finish	3) REGULAR		
4. Coursing/bond	4) REMAINS OF TWO HEADERS SIDE-BY-SIDE		
5. Form	5) BLOCKING OR THRESHOLD BASE SILL		
6. Direction of faces	6) NW/SE		
7. Orientation	7) NE/SW		
8. Dimensions	8) 0.27m (L) X 0.18m (W)		
9. Associated collapse	9) UNKNOWN		
10. Founds, cuts & fills	10) "		
11. Repaired	11) POSSIBLY BY (29729) IF THIS WAS A BLOCKING		
12. Associated floors	12) UNKNOWN		
13. Plastered	13) "		
14. Wall core	14) "		
15. Types of brick (%)	15) "		
16. Composition of bricks	16) "		
17. Dimensions of bricks (sample of three)	17) SEE # 2		
Stratigraphic Matrix			Abuts Above Abutted by Below Bonded into Contiguous with
INTERPRETATION	Enclosing	<u>Internal</u>	External
Reason for decay	NOT EXCAVATED - NUMBER ASSIGNED DURING		
Indications of original dimensions	DATA CURATION PROJECT.		
Indications of original functions	PREVIOUSLY LUMPED WITH REPAIR WALL (29729)		
EITHER THE BLOCKING, OR THRESHOLD OF BASE SILL AT THE SE ENTRANCE TO STRUCTURE 15255.			
SPACE 11557, 10953			
Associated contexts:			
Context Same As:			
Drawing Nos: 2008-20			
Photographs (feature in plan, elevation, materials used, surface treatment e.g. plaster, paint etc.) Photograph No. Description	Finds Description Artefact no.		Samples (notation, wet sieve, materials used e.g. bricks, stone, wood, bonding material etc.) Sample No. Description
	Phase:		

34347

Sketch Drawings (in plan and in profile)

Remember: do not just draw the architectural feature in isolation. Show how it relates to surrounding features and include details of surface treatments, repairs/modifications/damage, bonding material(s), and associated cuts. Annotate all aspects of the feature or use a Drawing Key. Measurements must be included for all aspects of the feature and surrounding features.

Sketch Plan - Include grid co-ordinates, North arrow, and elevations.

NOT TO SCALE \uparrow

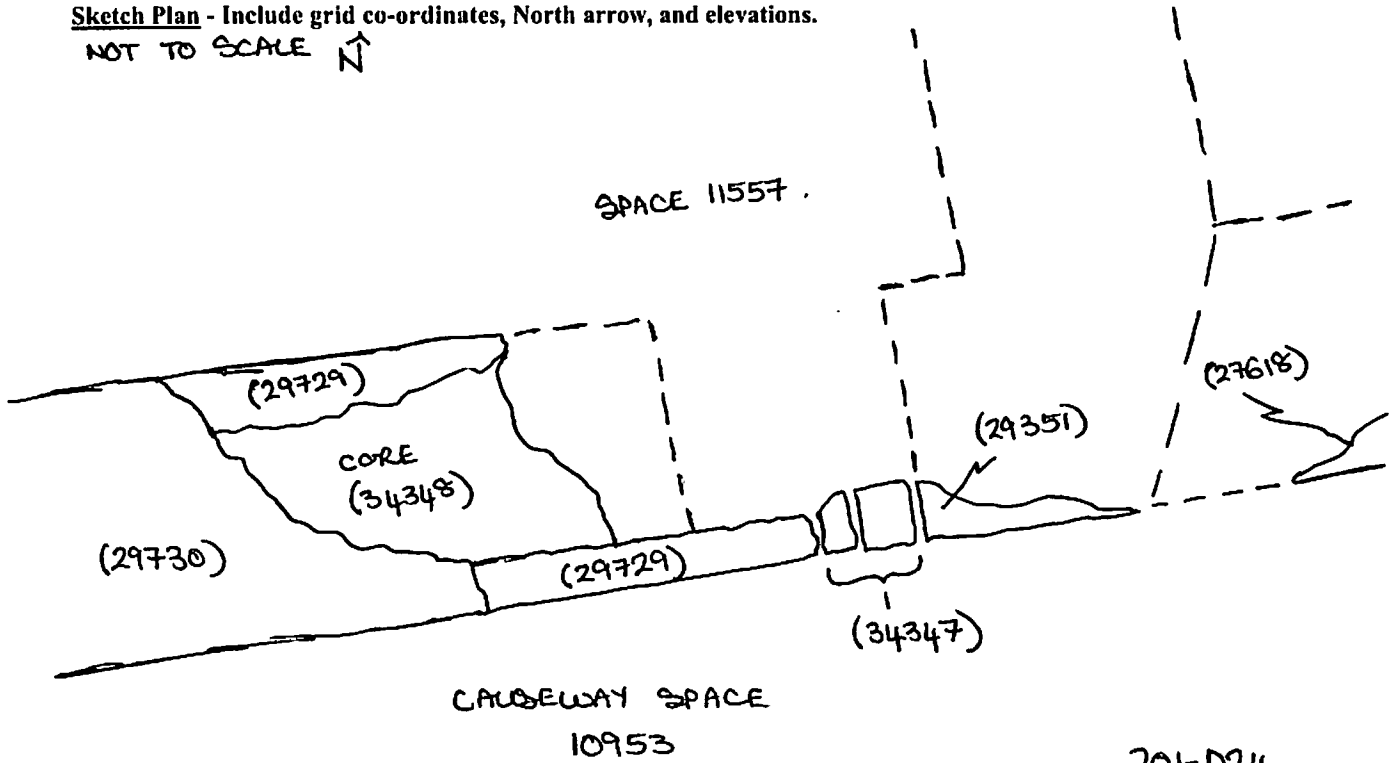

Profile Sketch

- State direction the elevation of the feature being drawn is facing e.g. 'West Facing Elevation of Feature'
- If feature was drawn in section then include the grid co-ordinates and elevations.

NO LEVELS ON PLAN.

201-D24

