

GPMP GIZA

| | | | | |
|--|--|---|--------------|--|
| Site: SATS 27 LTM Area: KKT-N | | GRID SQUARE(S) 201-G22 | ARCHITECTURE | FEATURE 34356 |
| 1. Material | 1) UNKNOWN - 2 PIECES OF LIMESTONE DRAWN. | | | |
| 2. Size of materials | 2) 0.20m (L) X 0.18m (W) LARGEST OF THE 2 PIECES | | | |
| 3. Finish | 3) UNKNOWN | | | |
| 4. Coursing/bond | 4) " | | | |
| 5. Form | 5) WALL CORE | | | |
| 6. Direction of faces | 6) N/A | | | |
| 7. Orientation | 7) NE/SW | | | |
| 8. Dimensions | 8) 2.73m (L) X 0.55m (W) | | | |
| 9. Associated collapse | 9) UNKNOWN | | | |
| 10. Founds, cuts & fills | 10) " | | | |
| 11. Repaired | 11) " | | | |
| 12. Associated floors | 12) N/A UNKNOWN | | | |
| 13. Plastered | 13) N/A | | | |
| 14. Wall core | 14) " | | | |
| 15. Types of brick (%) | 15) UNKNOWN | | | |
| 16. Composition of bricks | 16) " | | | |
| 17. Dimensions of bricks (sample of three) | 17) " | | | |
| Stratigraphic Matrix | | Abuts | | Above |
| | | Abutted by | | Below |
| | | Bonded into | | |
| | | Contiguous with | | |
| INTERPRETATION | | Enclosing | | Internal |
| Reason for decay | | NOT EXCAVATED - NUMBER ASSIGNED DURING DATA | | |
| Indications of original dimensions | | CURATION PROJECT. | | |
| Indications of original functions | | DRAWN BUT NOT NUMBERED. | | |
| CORE OF REPAIR WALL (34355) | | | | |
| SPACE: 11212, 11567, 11568 | | | | |
| STRUCTURE: 15255 | | | | |
| Associated contexts: | | | | |
| Context Same As: | | | | |
| Drawing Nos: 2009-88 | | | | |
| Photographs (feature in plan, elevation, materials used, surface treatment e.g. plaster, paint etc.) | | Finds | | Samples (flotation, wet sieve, materials used e.g. bricks, stone, wood, bonding material etc.) |
| Photograph No. | Description | Description | Artefact no. | Sample No. Description |
| | | | | |
| | | | | |
| | | | | |
| | | | | |
| | | | | |
| | | Phase: | Checked | Initials DCJ Date 10 APRIL 2013 |

34356

Sketch Drawings (in plan and in profile)

Remember: do not just draw the architectural feature in isolation. Show how it relates to surrounding features and include details of surface treatments, repairs/modifications/damage, bonding material(s), and associated cuts. Annotate all aspects of the feature or use a Drawing Key. Measurements must be included for all aspects of the feature and surrounding features.

Sketch Plan - Include grid co-ordinates, North arrow, and elevations.

NOT TO SCALE \uparrow N

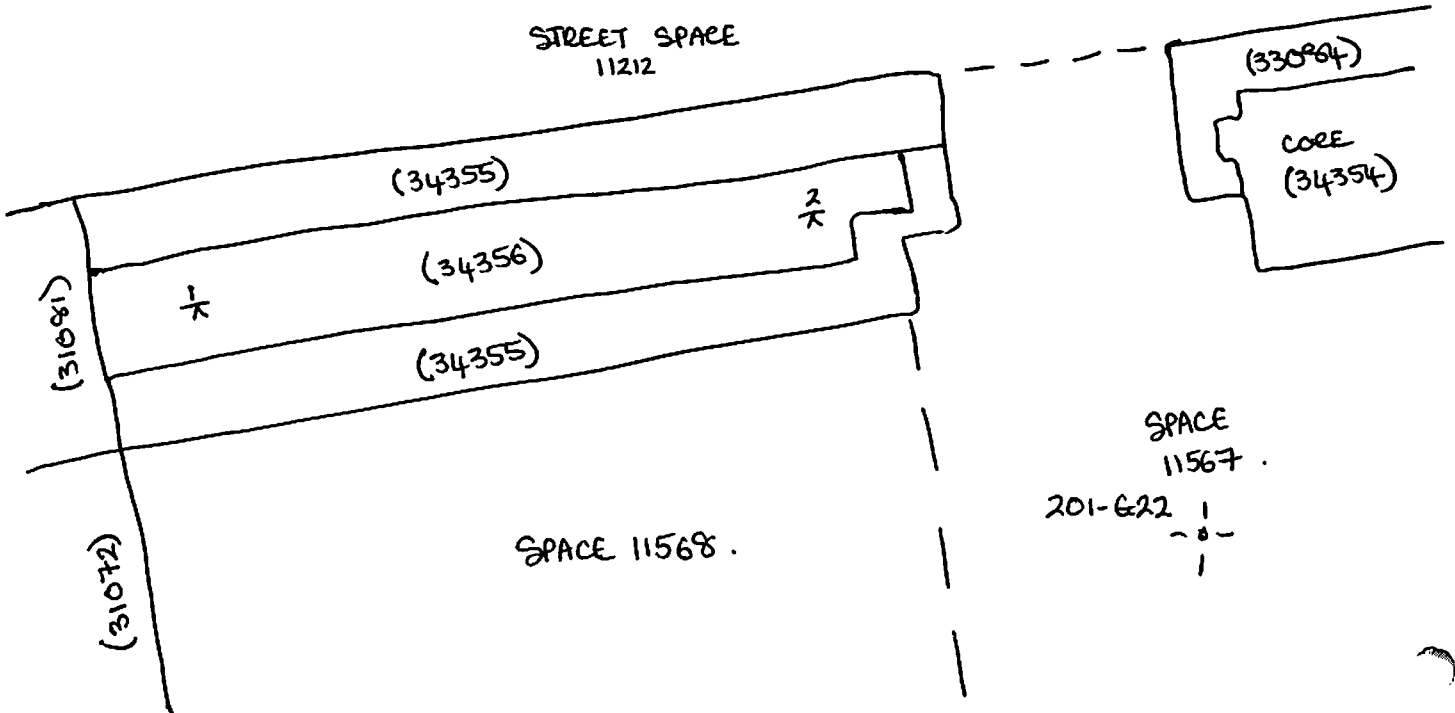

Profile Sketch

- State direction the elevation of the feature being drawn is facing e.g. 'West Facing Elevation of Feature
- If feature was drawn in section then include the grid co-ordinates and elevations.

TBM: 23.23

BS: 1.97

IH: 25.20

| | FS | RL |
|-----------------|------|-------|
| $\frac{1}{\pi}$ | 1.23 | 23.97 |
| $\frac{2}{\pi}$ | 1.36 | 23.84 |