

Locus <u>L18004</u>	Dor <u>1994</u>	Fld <u>16</u>	Sq <u>A534</u>	Loc. type <u>Pit to Floor Below</u>
Open <u>04/07/94</u>	Date	High at <u>14.02</u>	Low at <u>13.88</u>	Seals: <u>L18041</u>
Close <u>18/07/94</u>		<u>ClW</u>	<u>NL</u>	Sealed by:
Floor: type <u>Cl</u>		<u>13.73</u>	<u>ClW</u>	<u>13.65</u>
Length <u>1.9</u>	Width <u>0.8</u>	Vol	<u>13.65</u>	<u>SW</u>
Value <u>d</u>	Remove <u>18/07/94</u>	Drawn? <u>YES</u>		Loci <u>941091</u>
Photo #(1) <u>117-377</u>	Photo #(2) <u>117-378</u>			above
Written by: <u>JYS</u>	Checked by: <u>JRIZ</u>			Loci <u>181041</u>
				below
Unit	Phase	Stage	Stratum	PoM

Summary

Opened: To redefine + continue excavation of pit L9409 not closed at end of '89 season.

Limits (N) Bounded by W18010 to the North.

(S) Bounded by W9211 to the South.

(E) Bounded by W9408 to the East.

(W) Bounded by the unexcavated material below W9510 to the West.

Closed: When F18004 was revealed while removing lowest level of pit intrusion of pit L18004.

Matrix: Grey ashy material containing much pottery bone and shell with some brown fallen mudbrick material in the northern and southern ends of the locus.

Relations: L18004 is the continuation of the matrix of pit L9409 above. L18004 covers and seals L18041 below. Although L18004 is a pit, it was removed to a depth where pit intrusion no longer occurred, at which point intact F18004 was encountered. F18004 may be contaminated from above by the pit material of L18004, but is not pierced or cut, therefore F18004 seals and covers L18041 below. L18004 cuts the western mudbrick face of W9408 to the East and may cut the upper reaches of W18010 to the North and W9211 to the South, although this relationship may have occurred at a higher level in L9409. The matrix of L18004 continues into the unexcavated material below W9510 to the West, as does the make-up of F18004, which reaches W18010 to the North, the inner stone courses of W9408 to the East, and W9211 to the South.

Additional Observations/Value: Iron Age pit bottoming out on a floor reaching Phase 8 wall. Low to Medium Value.

Additional Photo #3: 117-379, 117-380



117380

Locus

L 18004

Sketch plan Scale 1:100

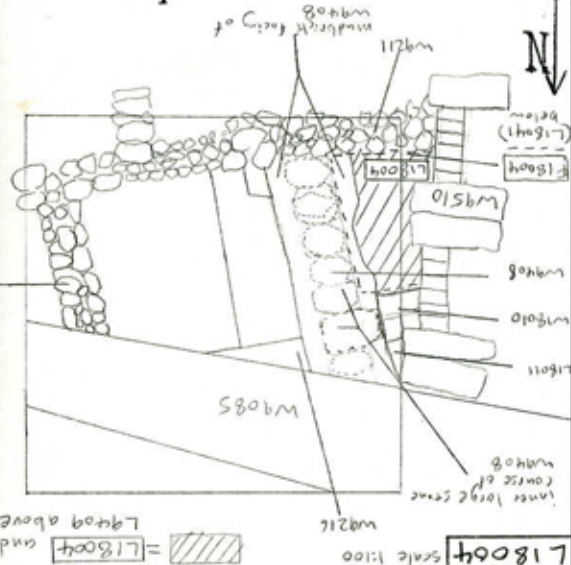

117377



117378

Section

Section