

Locus L18011	Dor 19 ₉₄	Fld G ₁	Sq A534	Loc. type Stratified Accumulation
Open Date 1.1 / 10.7 / 194	High at 1.4.00 N.W	Low at 1.3.9.3 S.W	Seals: _____	
Close Date 2.6 / 10.7 / 194	1.3.6.0 N.W	1.3.5.6 S.W	Sealed by: _____	
Floor: type _____	Length ϕ 1.5	Width ϕ 1.3	Vol _____	Loci 9,5,3,8 _____
Value 41	Remove _____	Drawn? 1101		above _____
Photo #(1) _____	Photo #(2) _____			Loci _____
Written by: J.K.S	Checked by: J.B.R			below _____

Unit _____	Phase _____	Stage _____	Stratum _____	PoM _____
------------	-------------	-------------	---------------	-----------

Summary _____

Opened: To excavate stratified accumulation previously identified as NW corner of [W9408].

Limits (N) Bounded by the unexcavated material below [W9085] to the North.

- (S) Bounded by the upper mudbrick courses of W18010 to the South
- (E) Bounded by the mudbrick facing of [W9408] to the East
- (W) Bounded by the unexcavated material below W9510 to the West.

Closed: Not closed, end of season

Matrix: Sandy orange brown mudbrick material with few small 5-10cm fieldstones, many Kurkar bits, some pottery + little shell.

Relations: [L18011] is covered by the previously excavated [L9538]. [L9538] was defined as mudbricks and later renamed [W9408]. [L18011] was not covered by these bricks however, but represents an area of stratified accumulation previously thought to be a large brick. [L18011] reaches the mudbrick exterior of [W9408] to the East, and the northern face of [W18010] to the South. The material of [L18011] continues into the unexcavated material below W9510 to the West and below W9085 to the North. It should be noted that [L18011] reaches the upper mudbrick courses, not the lower stone courses of W18010.

Additional Observations/Value: Very small locus reaching Phase 7 mudbrick walls.
Low Value.



Locus

U Wall

Sketch plan

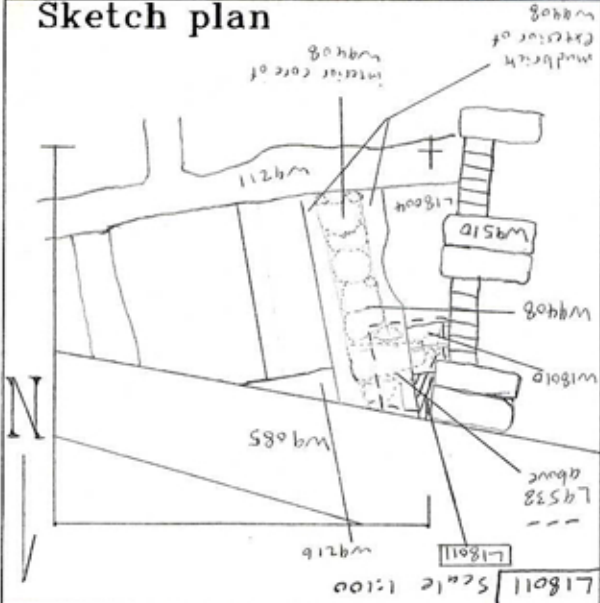

Photo

Photo

Section

Section