

Locus <u>L18026</u>	Dor <u>1994</u>	Fld <u>G</u>	Sq <u>A11/A132</u>	Loc. type <u>Floor makeup fill to install</u>
Open <u>13/07/94</u>	High at <u>13.64 S</u>	Low at <u>13.58 W</u>	Seals: <u> </u> <u> </u> <u> </u> <u> </u>	
Close <u>15/07/94</u>	<u>13.62 S</u>	<u>13.51 N</u>	Sealed by: <u>9309</u> <u> </u> <u> </u> <u> </u>	
Floor: type <u> </u>	Length <u>2.9</u>	Width <u>2.2</u>	Vol <u> </u>	Loci <u> </u> <u>18012</u> <u>18013</u> <u> </u>
Value <u>S</u>	Remove <u>15/07/94</u>	Drawn? <u>NP</u>		above <u> </u> <u> </u> <u> </u> <u> </u>
Photo #(1) <u> </u>	Photo #(2) <u> </u>			Loci <u>18035</u> <u>18036</u> <u>18048</u> <u> </u>
Written by: <u>CAB</u>	Checked by: <u>JRZ</u>			below <u> </u> <u> </u> <u> </u> <u> </u>
Unit <u> </u>	Phase <u> </u>	Stage <u> </u>	Stratur <u> </u>	PoM <u> </u>

Summary

Opened: L18012 and L18013 were collapsed into L18026. L18026 is the floor makeup of the fragments of L18012 and the continuation of the fill L18013.

Limits (N) L9168, W9262

(S) L9559

(E) L9878 and W9140

(W) W18048 and W9140

Closed: Closed L18026 when we noticed a soil change; red-brown in south, in the center we reached a white plaster "installation", to the north an ash grey soil, and to the west a row of stones

Matrix: opened L18035 for soil around "installation", L18036. Assigned W18048 to western stone matrix: Light brown sandy matrix

Relations: L18026 is covered, but not sealed by L18013 and F18012. However, L9300 covers and seals both L18013 and F18012.

To the north L18026 reaches W9262 and is cut by L9168.

To the south L18026 reaches L9559.

To the west, L18026 reaches W9140 and comes down on W18048 which is laid against W9140. W18048 is only 1 stone wide from "plan view", in the South section of pit 1968 there is another stone west of *

To the east, L18026 reaches L9878.

L18026 comes down upon the installation / floor L18036, and the area around it L18035. L18026 also comes down upon W18048, which W9140 was laid against. L18036 reaches W18048, and may be the same as the western fragment of F18012, which reaches W9140. However, due to excavation, the connection between F18012 and L18036 was destroyed. L18035 is the area around the installation L18036 (which reaches W18048) to the north south and east of the installation L18036 (see top p). L18026 covers, but does not seal L18036 and L18035.

* W18048 which may be evidence that 18048 was originally 2 stones wide; if so, W9140 may cut and is founded on part of W18048.

Additional Observations/Value: L18026 is of low value other than being sealed by L9300 and being the fill to the interesting installation L18036.

Locus Basket List			
Bask. No.	Sq. Comments	Req. Ele.	CIC Ele
180378	AI/AJ33 pottery.	13.69	13.69
180379	AI/AJ33 pottery.	13.69	13.5
180380	AI/AJ33 shell.	13.69	13.5
180381	AI/AJ33 bone.	13.69	13.52
180382	AI/AJ33 shell.	13.69	13.52
180459	AI32 pottery. mb? 1 MYC? 1 Hellenic	13.68	13.53
180461	AI32 flint.	13.68	13.53
180482	AI/AJ32 pottery - from locus center ar 1 PHL or MB?. 1 LMP. 1 dithos.	13.65	13.51

Locus
L18026

Sketch plan 1:100

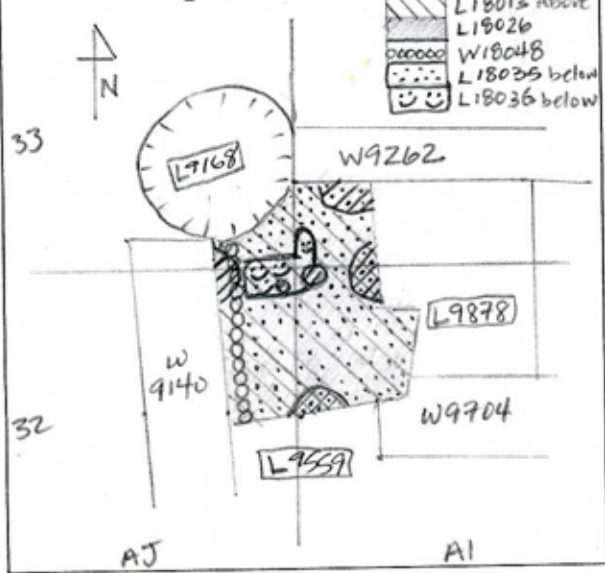

Photo

Photo

Section

Section