

Locus L 18030	Dor 1994	Fld 15	Sq 111119313	Loc. type Floor Make up, Fill to floor
Open 13/17/54	High 14.65	at 1E	Low 14.57	at 1W
Close 20/17/54	High 14.42	at 1E	Low 14.40	at 1W
Floor: type CIF	Length 3.7	Width 2.9	Vol []	Drawn? y, e, s
Value 1A	Remove 210/17/54			
Photo #(1) 117-314	Photo #(2) 117-315			
Written by: RJC	Checked by: JRIZ			
Loci 18000	18006	18010	18014	18018
above	18022	18026	18030	18034
Loci 18043	18044	18045	18046	
below				

Unit	Phase	Stage	Stratum	PoM
-------------	--------------	--------------	----------------	------------

Summary

Opened: L18030 was opened as F18000 was closed directly on top.

Limits (N) Debris below W9560 and W9282

(S) Debris below L9278 and W9425

(E) East Balk

(W) F9976

Closed: L18030 was closed when patchy floor surface material was uncovered throughout the locus and when L18030 was seen in section to be coming on mudbrick wall W18045

Matrix: The soil was a dark brown silty sand not clumpy and with a larger quantity of rock and scattered rubble. A human mandible was found although there remained no further evidence of a human skeleton. The pottery sherds were quite larger than from F18000. The matrix of F9962 is very similar to that of F18030

Relations: F18030 is a patchy collection of floor debris. F18030 is covered but not sealed by L18000 and L18006.

To the North L18030 continues into the debris below W9560.

To the South L18030 continues into the debris below W9278.

To the West L18030 may continue into L9973 as they seem to have a similar matrix. L18030 does not seem to extend into L9976 south of L9973 as the matrices are different; it is also different from *

To the East L18030 reaches the Eastern balk

Pit 18022 cuts L18030.

Most of F18030 is a very patchy floor level and was not much in evidence after the morning light had passed. Its clear patches were grey to white and were found mainly in the NE part of L18030

F18030 In N.W. corner is reaching W9957 as a heavy cobble concentration this is in the region directly beneath L9962. This section of F18030 probably cuts, and does cover, mudbrick W18045 below W9957.

*L9962 north of L9973. The relationship of F18030 to L9962 and L9976 is uncertain

Additional Observations/Value: The value of F18030 is not very high as it is questionable as to the real relations between patches.

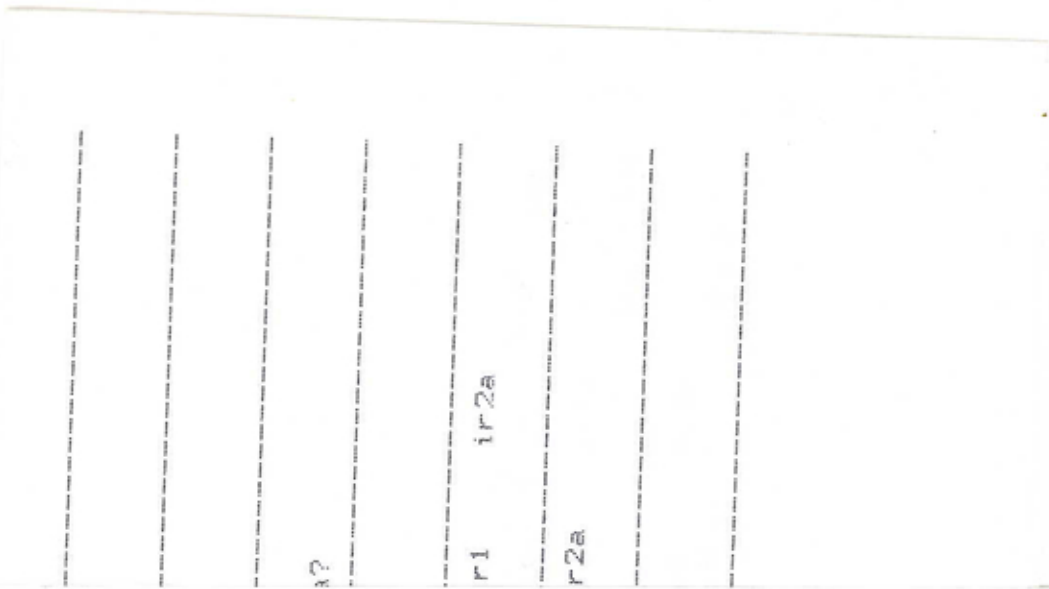

r1
ir2a
r2a

Locus
L 181030

Sketch plan

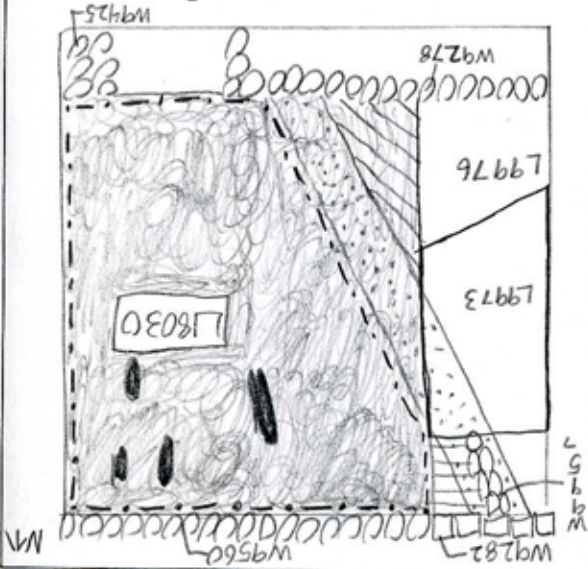

Photo

Photo

Section

Section

- ▨ = 18046
 - ▨ = 18045
 - - - = 18044
 - ▨ = 18043
 - ▨ = 18030
 - = F18030
- = L9973