

Locus L 18038	Dor 1994	Fld G	Sq A132	Loc. type Floor makeup fill to floor
Open 15/07/94	Date	High at 13.61 W	Low at 13.50 E	Seals: 18050
Close 20/07/94		SE 13.41	NW 13.38	Sealed by: W9704
Floor: type CIE		SE 13.41	NW 13.38	Loci W9704
Length 3.0	Width 0.5	Vol		above
Value S	Remove 18/07/94	Drawn? YES		Loci 18050
Photo # (1) 117475	Photo # (2) 117477			below
Written by: CAB	Checked by: JRZ			

Unit	Phase	Stage	Stratum	PoM
-------------	--------------	--------------	----------------	------------

Summary

Opened: Opened [L18038] after removing all remnants of W9704, under which was found [F9930 = F9703] which had extended directly under [W9704]. Assigned [L18038] to floor makeup and fill below of F9930 = F9703.

Limits (N) bordered by F/L9953, F/L9834, and F/L18042
(S) bordered by F/L9727
(E) bordered by haulk of AH32
(W) L18039 + L18028

Closed: Came down on [F18038] across entire area, opened [L18050] as floor makeup and fill to destruction layer.

Matrix: Compact ash grey flooring with grey-brown dirt below to another compact ash grey floor. Very few very small sherds and animal bones.

Relations: [L18038] was covered and sealed by [F9930/F9703] above, which was covered and sealed by [W9704], above F9930/F9703.

To the north [L18038] continues into 9834's debris; and is probably the continuation of F/L18037 underneath W9728 and the lower floor [F18042]** *note: F9834's elevation is 13.48-13.44 South and West, which is higher than [F18038] - but may be the same. F/L18038 also continues into F/L9953.

To the south, F/L18038 continues into F/L9727 and is probably the continuation of F9727 underneath W9704.

To the west, [L18038] continues into the unsealed fill of the combined loci [L18028] and [L18039]. F18038 may have extended into L18028 + L18039, but the continuation of F18038 ^{west is questionable} due to exposure of the western extension of [W9704] and subsequent erosion. [F18038] also reaches 18052 on the West.

To the east, [L18038] continues into unexcavated bank. [F18038] covers and seals [L18050] below, which is the floor makeup and fill below [L18038] to destruction.

** See section F18037 is a resurfacing of F18042 below. F18037 merge where they connect with F9727.

Additional photo: 117481
Additional Observations/Value: High value locus for confirming ^{the} conjecture that the surrounding floor loci (F9824, F9727, F9953 = F18037) had extended below the [W9704]. And, having all of these floors connecting up generally to seal and cover the very important destruction layer below - probably a leveling of the destruction debris and the subsequent construction of this floor (upon which W9704 and W9728 were built - without cutting the floor).



117431

Locus
L 18038

W9704 ABOVE
L18039
L18028
L/F18038
L18050 below

F9703/F9930 ABOVE
W9728
18039+18028 = 18052 below

* note: on photo F9727 = F18038.

Sketch plan 1:100

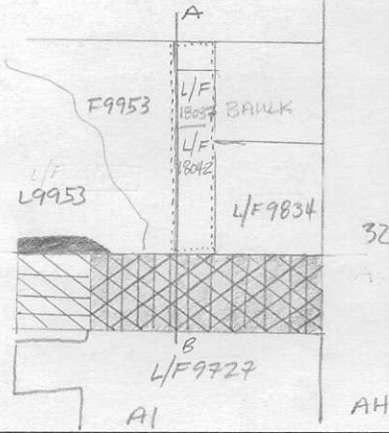

117475

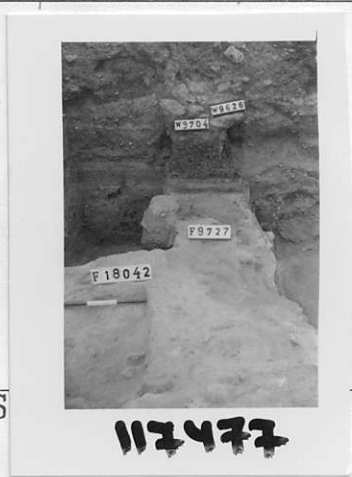

117477

Section

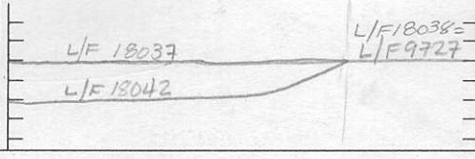

A from west to EAST B