

Locus L 18067	Dor 1994	Fld G ₁	Sq A, J, B,	Loc. type "Fish floor" Floor Make-up and fill to floor.
Open Date 2/2/94	High at 13.317	NW	Low at 13.311	W
Close Date 4/18/94	13.114	W	12.919	NE
Floor: type CIP	13.018	S	12.919	NE
Length 2.4	Width 2.3	Vol	Drawn? Y, E, E	
Value S	Remove	/ / /		
Photo #(1) 117-920	Photo #(2) 117-921			
Written by: J. K. E.	Checked by: J. R. Z.			

Unit	Phase 9	Stage	Stratum	PoM
------	---------	-------	---------	-----

Summary

Opened: Came down on F18021 which extended below L18040 and ^{much} W9886. L18067 opened below L18040, W9886 and southern edge of L18021 to include make-up of F18021 and fill below.

Limits (N) Bounded by L18032 to the North.

(S) Bounded by W9262 and pit L9168 to the South.

(E) Bounded by W9275 to the East.

(W) Bounded W9140 to the West.

Closed: Came down on [F18067].

Matrix: Slightly sandy compact brown mudbrick material with kurkar bits scattered small 5-10 cm fieldstones, much pottery, shell, and bone. The remains of 35-to fish were observed on F18067. F18021 is two resurfacings of a single floor, the upper being a dull grey dry ashy material, with the lower being a thin ashy plaster floor with charcoal flecks on it that was very easy to trace.

Relations: [L18067] is covered by the southern half of L18021, L18040 and W9886. F18021 and W9886 seal [L18067]. [L18067] reaches W9140 to the west, is cut by L9168 to the South, reaches W9262 to the South, and continues into the unexcavated material below W9275 to the east. To the North, [L18067] is cut by pit L9251 and is the continuation of the matrix of L18032 either side of L9251. [F18067] reaches W9262 to the South, was not traced to W9140, continues into the unexcavated material below W9275 to the East, and is cut by L9251. Floor F18067 was not found to continue into L18032. It is possible that F18032 is fallen wall or ceiling on [F18067], but further excavation in L18032 is required to further investigate this relationship. It is also possible that W9275 cuts the material of [L18067], but the material below W9275 will require excavation in order to compare matrices w/ [L18067] to determine this relationship.

Additional Observations/Value: Possible Phase 8 floor and sealed material above.
High Value.

Additional Photo #s: 117-922, 117-923

181089	AJ33	13.33	13.07
pottery - from TZ with pit 9251			
181090	AJ33	13.33	13.07
shell - from TZ with pit 9251			
181100	AJ33	13.23	13.07
pottery.			
181101	AJ33	13.23	13.07
bone.			
181102	AJ33	13.23	13.07
shell.			
181103	AJ33	13.23	13.07
flint. - V. TDP			
181129	AJ33	13.23	13.07
charcoal.			
181144	AJ33	13.20	13.07
pottery - TZ with L9251.			

Locus
L 1819167

Sketch plan
Scale 1:100

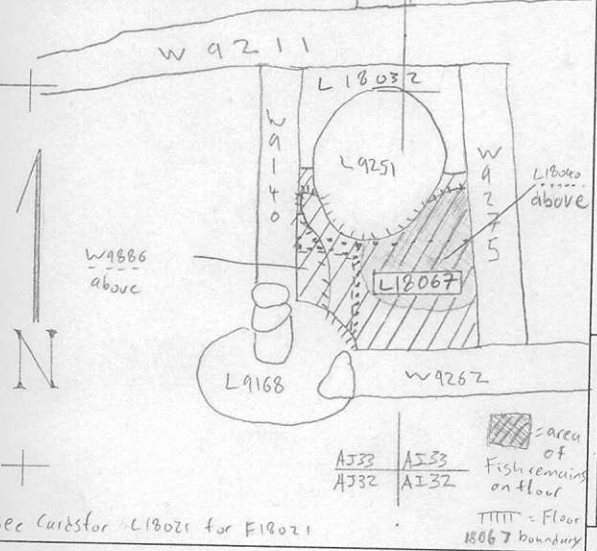

Photo

Photo

Section

Section

Area north of 18040... = L18021
 Area of 18067 minus NE portions of W9886 = F18021