

Locus L 1,8,0,9,1	Dor 19,4	Fld 6	Sq A, I, 3, 2	Loc. type FLOOR MAKEUP TO FLOOR
Open Date 05/08/94	High at 11.95	at N	Low at 11.83	at SW
Close Date 05/08/94	11.90	N	11.73	S
Floor: type C/P	11.79	C	11.73	SW
Length 3.6	Width 1.0	Vol	Drawn? NO	
Value S	Remove -/-/-/-			
Photo #(1) see JRM	Photo #(2) see JRM			
Written by: JCM	Checked by: JRM			

Unit	Phase	Stage	Stratum	PoM
------	-------	-------	---------	-----

Summary

Opened: DUG THROUGH F18070 AS [L18091].

- Limits (N) BAULK UNDER F9795
 (S) BAULK UNDER W9800
 (E) BAULK
 (W) BAULK BESIDE W9804

Closed: CAME DOWN ON [F18091] IN EASTERN PART OF SQUARE. (CULD NOT EXCAVATE THE WESTERN PART BECAUSE THE SEASON ENDED. Not closed)

Matrix: L18091 CONSISTS OF FIVE SURFACES INCLUDING F18070 - F18091 (1: 12.05 N - 11.83 S, 2: 11.90 N - 11.82 S, 3: 11.87 N - 11.76 S, 4: 11.82 N - 11.76 S, 5 (F18091): 11.79 C - 11.73 SW). THEY ALL ARE GREY ASHY SURFACES AND RATHER LOOSELY PACKED. SOIL BELOW F18091 APPEARS TO BE LIGHT AND SANDY

Relations: L18070, L18082 SEAL [L18091]. L18083 CONTINUES DOWN AS [L18091]. L18091 CONTINUES INTO THE NORTH BAULK UNDER F9795, SOUTH BAULK UNDER W9800, EAST BAULK, AND WEST BAULK UNDER W9804. [F18091] HAS THE SAME NORTH, SOUTH, AND EAST RELATIONS. [F18091] CONTINUES WEST UNDER THE FOUR SURFACES ABOVE.

Additional Observations/Value: SERIES OF OVERLAPPING FLOORS. MEDIUM VALUE

Locus

160817

Sketch plan

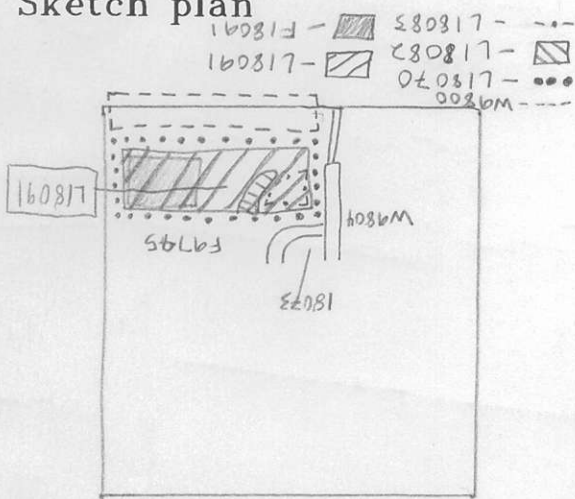

Photo

Photo

Section

Section