

Locus <u>L18214</u>	Dor <u>1997</u>	Fld <u>G</u>	Sq <u>A332</u>	Loc. type <u>Destruction Layer</u>
Open <u>10/27/97</u>	Date	High at <u>13.16</u>	Low at <u>13.13</u>	Seals: _____
Close <u>31/07/97</u>		<u>12.13</u>	<u>12.09</u>	Sealed by: _____
Floor: type <u>cf</u>		<u>12.13</u>	<u>12.13</u>	Loci <u>91407</u> <u>18219</u>
Length <u>2.5</u>	Width <u>1.0</u>	Vol _____		above _____
Value <u>4</u>	Remove <u>-/-/-</u>	Drawn? <u>No</u>		below _____
Photo #(1) _____		Photo #(2) _____		Loci <u>18344</u>
Written by: <u>SLM</u>		Checked by: <u>JRZ</u>		below _____
Unit _____	Phase <u>9</u>	Stage _____	Stratum _____	PoM _____

Summary

Opened: while excavating L18219, came down on destruction layer. Changed to L18214.

Limits (N) W18048

(S) Balk

(E) L9820 above and L9829 below.

(W) L9967 above, L18239 below.

Closed: Came down on fragmentary F18216. Ended excavations.

Matrix: Red/brown mudbrick debris with burnt red + orange mudbrick inclusions and chunks of ash. Not as intense as the destruction loci to the east.

Relations: Above: W9140 and L18219 cover but do not seal L18214

North: L18214 reaches W18048.

South: L18214 continues into the balk.

East: L18214 is cut by pit 29820 above, and continues into 19829 below.

West: L18214 continues into 19967 above, and L18242 below.

Below: L18214 comes down on a very fragmentary extension of L18216-9832. No Locus below, end of season.

F18214: Reaches W18048 on the North, <sup>probably</sup> continued into the balk on the south, (is continued to the east by F18215) and to the west by F18242.

L18214 is destruction material spilling into the room bounded by W9909, W18048, and W18250 proving this room is part of the destruction deposit.

Additional Observations/Value: High Value Destruction Material.

Ph. 9 continuation of L18242 in A132

LOCUS

U 18214

Sketch plan

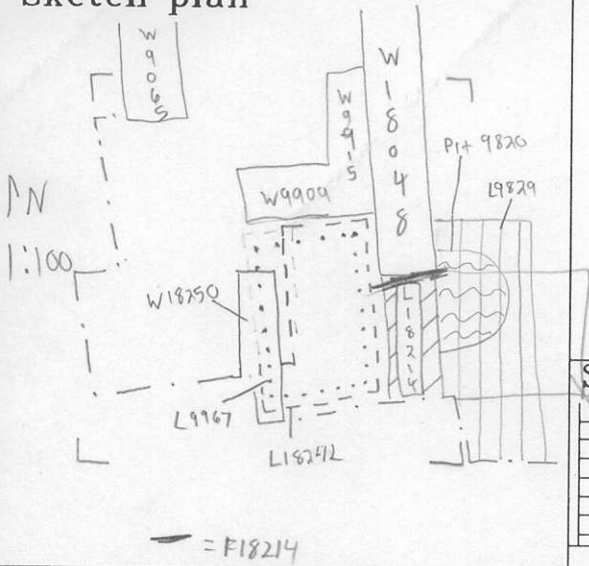

Photo

Photo

Section

Section

L18215

