

Locus L 18239	Dor 1917	Fld G	Sq AJ32	Loc. type Destruction Down to Floor
Open Date 17/07/97	High at 12.57	at NW	Low at 12.64	at SE
Close Date 08/07/97	High at 12.29	at C	Low at 12.31	at NW
Floor: type CP	High at 12.64	at E	Low at 12.21	at NW
Length 1.8	Width 1.8	Vol	Drawn? YES	
Value U	Remove			
Photo #(1) 166729	Photo #(2) 116730			
Written by: JCM	Checked by: JRZ			

Unit	Phase 9	Stage	Stratum	PoM
------	---------	-------	---------	-----

Summary

Opened: While clearing pit L18240, came down on handgenous material across entire room. Changed to L18239 to cover this entire area.

Limits (N) bulk under W9400
 (S) W9909, L18249
 (E) W9915
 (W) Bulk under W9065

Closed: Came down on floor with restorable vessels.

Matrix: Tan sandy matrix. Similar but more hard packed than L18231 above.

Relations: Above: L18239 covers L18239 but does not seal it. L18240 partially cuts L18239
 North: L18239 continues into the bulk under W9400
 South: L18239 reaches W9909 and is reached by the mudbrick debris and rubble collapse of L18249.
 East: W9915 is reached by L18239.
 West: L18239 continues under W9065 in the bulk
 Below: L18239 covers but does not seal L18306.
 Almost certainly contaminated by pit L18240 + L9997 for top few cm. However, material on floor is in situ and clean. This material should equal material from installation 9982 room in AT32, 18033 (et al) in AT31 and L18242 + L18249 (?) in AJ32.

L18240 is both west of L18239 and also covers the west part of L18239 because pit 18240 bottomed out almost as soon as it was opened.
 There is likely some mixing of material between L18239 and L18306 as it was difficult to travel L18239 just west of W9915. Our best guess is that the only restorable vessel belonging to 18239 is a krater/bowl; the rest probably belongs with 18306 below.
 L18239 reaches the mudbrick phase of W9915, the stone scale of W9909, continues below W9400 and W9065 and continues into/as L18249.
 Additional Photos: 166731-166737

Additional Observations/Value: Highest Value. Unburned Destruction deposit.
 2 of 3/4 vessels in this locus were upside down and associated with an another.



18239
Sketch plan

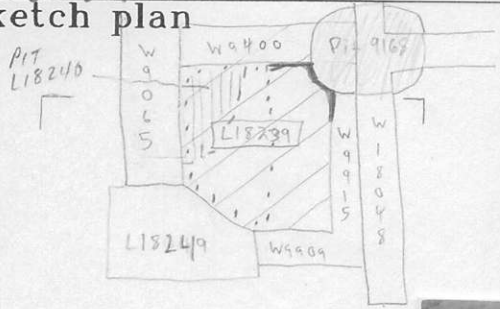

Photo



N ↑ 1:100
--- = L18240
= Section of F18239 seen only in Section
... = tracable extent of F18239 on the west,