

Locus L 18281	Dor 1997	Fld G	Sq A533	Loc. type Floor Makeup + Fill to Floor
Open 30/07/97	Date	High at 13.11	Low at 12.77	Seals: _____
Close 30/07/97		N.W	E	Sealed by: _____
Floor: type CP		12.97	12.84	Loci 18279 _____
Length 2.2	Width 0.3	N.W	E	above _____
Value ?d	Remove 30/07/97	Vol	Drawn? YES	Loci 18284 _____
Photo #(1) None	Photo #(2)			below _____
Written by: JKM	Checked by: JRR			

Unit	Phase 96/1071	Stage	Stratum	PoM
------	---------------	-------	---------	-----

Summary

Opened: While excavating L18279, came down on a floor. Changed to L18281 and continued down

Limits (N) Pit 9251

(S) L18246

(E) Bulk under West Face of Phase b. W9275

(W) W9140

Closed: Came down on F18281 = F18246 Changed to L18284 and continued down.

Matrix: F18279 = F18232 is a hard packed reddish brown surface about 3 cm thick. The matrix below is brown mudbrick debris.

Relations: Above: L18279 covers but does not seal L18281

North: L18281 is cut by pit 9251

South: L18281 continues into L18246

East: L18281 continues into the bulk under the west face of Phase b W9275

West: L18281 reaches W9140.

Below: L18281 covers but does not seal L18284.

F18281 = F18246 reaches W9140 and continues under W9262 and the west face of W9275 (Phase b)

L18281 may either reach or be cut by the stones of the east face of W9275 as the east face continues down 3 courses more than on the west.

Additional Observations/Value: Low Value.

Locus
L 18281

Sketch plan

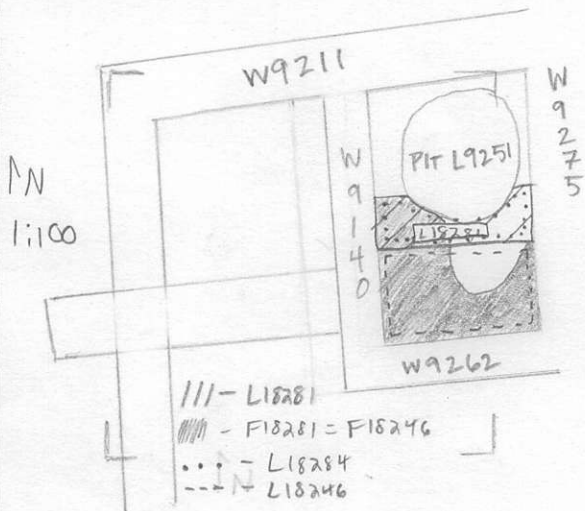

Photo

Photo

Section

Section