

<b>Locus</b> L 18282	<b>Dor</b> 1997	<b>Fld</b> G	<b>Sq</b> A332	<b>Loc. type</b> Floor Makeup/Collapse
<b>Open</b> 30/07/97	<b>High at</b> 12.37	<b>Low at</b> 12.31	<b>Seals:</b> _____	
<b>Close</b> 30/07/97	12.26	12.16	<b>Sealed by:</b> _____	
<b>Floor: type</b> _____	<b>Width</b> 9.5	<b>Vol</b> _____	<b>Loci</b> 18231 18240 18239	
<b>Length</b> 1.2	<b>Remove</b> 31/ / /	<b>Drawn?</b> Yes	<b>above</b> _____	
<b>Value</b> SL			<b>Loci</b> <del>18239</del>	
<b>Photo #</b> (1) _____	<b>Photo #</b> (2) _____		<b>below</b> _____	
<b>Written by:</b> JCM	<b>Checked by:</b> JRL2			

<b>Unit</b> _____	<b>Phase</b> 9	<b>Stage</b> _____	<b>Stratum</b> _____	<b>PoM</b> _____
-------------------	----------------	--------------------	----------------------	------------------

**Summary** \_\_\_\_\_

**Opened:** while excavating L18239 we came down on two floors, one at a higher level than the other. Because we had taken pictures of in situ objects on \*

**Limits (N)** Balk  
**(S)** L18239  
**(E)** L18239  
**(W)** Balk

**Closed:** Came down on the rest of F18239.

**Matrix:** Floor surface is white ashy material. Same matrix down to F18239.

**Relations:** Above: L18239 comes down on floor L18282 but does not seal it  
 North: Floor L18282 continues into the balk.  
 South: L18239 reaches [L18282]  
 East: L18239 reaches [L18282]  
 West: [L18282] continues into the balk.  
 Below: [L18282] comes down on F18239, but does not seal it

F/L18282 is likely simply an earlier surface of F18239

8/02 EB-5 likely collapse of 2<sup>nd</sup> storey or shelf (or both) onto F18370 below.

\*F18239, we gave the higher floor a phantom number to excavate it down to the level upon which the vessels rested.

**Additional Observations/Value:** Medium Value

**Locus**

4 18282

**Sketch plan**

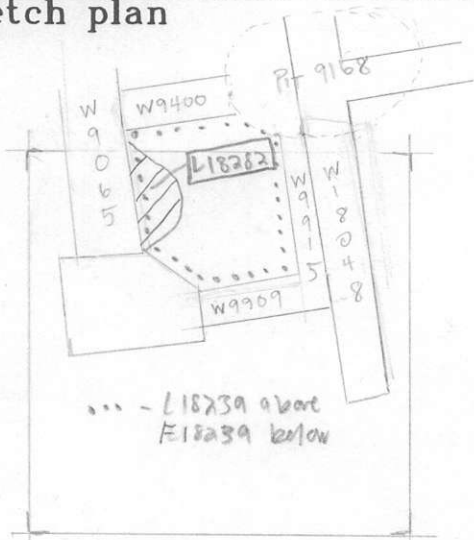

Photo

Photo

Section

Section

Note that F18289 in its eastern half was only found in a section below W9400, but it clearly reached W9915.