

|                            |                          |                           |                         |   |
|----------------------------|--------------------------|---------------------------|-------------------------|---|
| <b>Locus</b><br>L 18290    | <b>Dor</b> 1997          | <b>Fld</b> G <sub>L</sub> | <b>Sq</b> A132          | <b>Loc. type</b><br>Floor Makeup and Fill Below |
| <b>Open</b> 31/07/97       | <b>High at</b> 11.93     | <b>Low at</b> 11.72       | <b>Seals:</b> _____     |   |
| <b>Close</b> 08/08/97      | <b>High at</b> 11.81     | <b>Low at</b> 11.72       | <b>Sealed by:</b> _____ |   |
| <b>Floor:</b> type C1e     | <b>Width</b> 1.0         | <b>Vol</b> _____          | <b>Loci</b> 18091       |   |
| <b>Length</b> 3.0          | <b>Remove</b> _/_/_      | <b>Drawn??</b> _____      | <b>above</b> _____      |   |
| <b>Value</b> 5             |                          |                           | <b>Loci</b> 18322 18335 |   |
| <b>Photo #</b> (1) see Jsa | <b>Photo #</b> (2) _____ |                           | <b>below</b> _____      |   |
| <b>Written by:</b> JCM     | <b>Checked by:</b> JRZ   |                           |                         |   |
| <b>Unit</b> _____          | <b>Phase</b> _____       | <b>Stage</b> _____        | <b>Stratum</b> _____    | <b>PoM</b> _____                                |

**Summary**

**Opened:** While excavating on L18276, Carve level with no. L18091 from 1994 and found small patches of floor. The unsealed part became L18291 and the sealed part L18290.

**Limits (N)** Bulk under L18289  
**(S)** L18291, L18295  
**(E)** Bulk  
**(W)** W18275.

**Closed:** Came down on F18290 = F18295 = F18297. End of season.

**Matrix:** Loose medium brown, sandy soil with patches of mud/brick debris.

**Relations:** Above: L18091 <sup>covers and seals</sup> L18290  
 North: L18290 continues into the bulk under L18289.  
 South: L18290 continues into L18291 above and L18295 below.  
 East: L18290 continues into the bulk.  
 West: L18290 reaches W18275.  
 Below: L18290 comes down on F18290 = F18295 = F18297.

F18290 = F18295 = F18297 reaches W18296 and continues under W18275.

\*1998 - F18290 = F18322 see card L18322 for new relations

\* temporary bulk removed north of L18290, 6 Vansteenhuyse pits found in section with elevations relating to F18290. Pits at elevations of 11.89, 11.90, 11.63 and 11.70.  
 (See section drawing for F18322)

**Additional Observations/Value:** Medium Value.

**Locus**  
L 1,82,90

**Sketch plan**

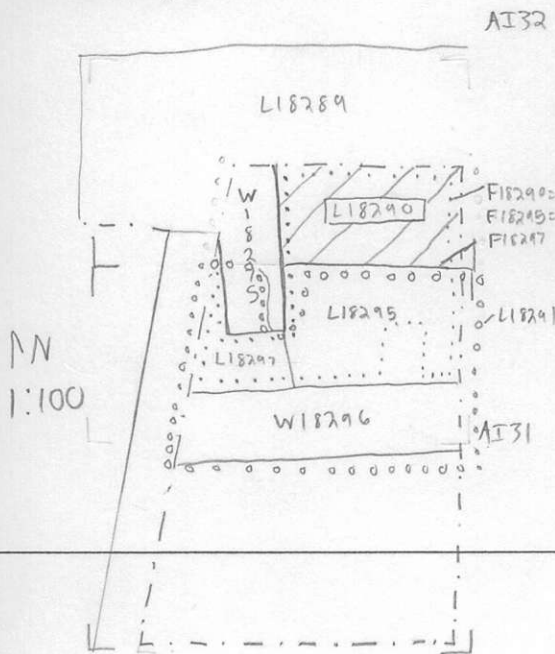

**Section**



**Section**

