

Locus L 18364	Dor 19 ⁹⁹	Fld G ₁	Sq AI 31	Loc. type Fill To Floor
Open	Date 06/07/99	High at 14.68 S	Low at 14.46 N	Seals: _____
Close	09/07/99	14.41 S	14.18 N	Sealed by: _____
Floor: type	cl	14.41 S	14.18 N	Loci L18362 L18363
Length 2.3	Width 0.6	Vol	Drawn? NO	above _____
Value u ₁	Remove			below _____
Photo #(1) None		Photo #(2)		Loci _____
Written by: K.V.		Checked by: J.R.Z.		below _____

Unit	Phase	Stage	Stratum	PoM
------	-------	-------	---------	-----

Summary

Opened: L18363 (TABUN) WAS REMOVED AND BOTH L18362 AND L18363 WERE LUMPED TOGETHER IN L18364 below

Limits (N) L9623
 (S) BALK UNDER L9025
 (E) 9050?, 9165?, 9259?, L9508?, L9539?
 (W) BALK

Closed: WE CAME DOWN TO FLOOR AND DECIDED TO STOP EXCAVATING THIS PART OF THE BALK

Matrix: GREY-TO DARK BROWN SOIL

Relations:

ABOVE: L18362 AND L18363 (TABUN) WERE COVERING L18364
 NORTH: / (SEE EAST)
 SOUTH: L18364 CONTINUES IN THE BALK UNDERNEATH L9025
 EAST: POSSIBLE MATCHES WITHIN THE RANGE OF OUR MEASUREMENTS ARE LOC 9050/9165/9259. HOWEVER L9508/9539/9623 MIGHT BE THE BEST CANDIDATES. L9508 (14.85-14.68) HAS A MATRIX OF HARD WHITISH GREY SOIL BUT NO FLOOR, L9539 (14.68-13.45) WHICH IS BELOW L9508 HAS LOOSER WHITE MATERIAL IN ITS EASTERN SIDE. L9623 WHICH IS WEST OF L9539 (14.28-14.23) HAS A FLOOR OUT OF GREY MATERIAL AND MAY BE BEST FITTING.
 WEST: L18364 CONTINUES IN THE BALK
 BELOW: L18364 HAS NO RELATIONS BELOW YET and never will as the rest of the over hanging balt of which it was a part was purposefully collapsed for safety reasons.

Additional Observations/Value: LOW VALUE; Essentially balt excavation

LOCUS
L 18364

N ↑

Sketch plan

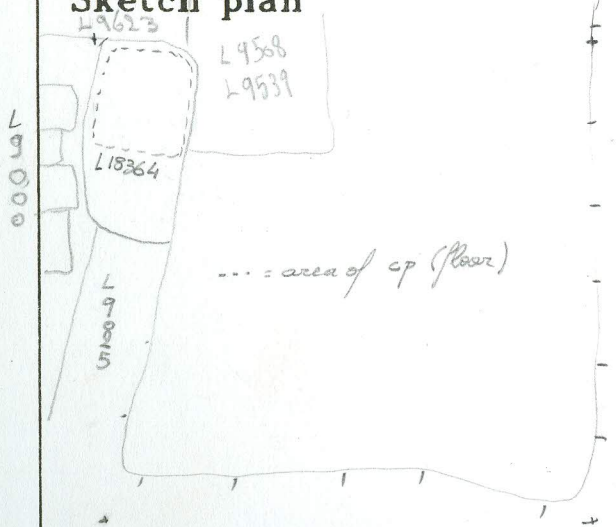

Photo

Photo

Section

Section

AI 31