

Locus L 18371	Dor 19 ₉₉	Fld G ₁	Sq A ₁ J ₁ 3 ₂ 111	Loc. type Fill to Floor
Open 08/07/99	Date 08/07/99	High at 1.2.16	Low at 1.1.88	Seals: _____
Close 019/017/99		1.2.03	1.1.98	Sealed by: _____
Floor: type c1		1.2.03	1.1.98	Loci 18249 _____
Length 0.8	Width 0.6		Vol _____	above _____
Value 4	Remove ___/___/___		Drawn? YES	below _____
Photo #(1) 184 523	Photo #(2) 184 524			Loci 18372 _____
Written by: KV	Checked by: JAZ			below _____
Unit _____	Phase 9	Stage _____	Stratum _____	PoM _____

Summary _____

Opened: START OF THE SEASON. WE WANTED TO EXCAVATE BELOW L18239 AND DECIDED TO REMOVE THE HIGHEST PART OF L18239 IN THE NORTH FIRST

- Limits (N) BALK below W9065
 (S) UNEXCAVATED PART OF L18339
 (E) W9909 AND BALK UNDER L18370
 (W) W9998 and rubble in balk

Closed: WE CAME DOWN ON A FLOOR AND LUMPED L18371 AND THE STILL UNEXCAVATED PART OF L18239 TOGETHER INTO L18372

Matrix: DARK BROWN SOIL DOWN TO FRAGMENTARY FLOOR OF WHITE PATCHES WITH POTTERY ABOVE IT.

Relations: ABOVE: L18249 COVERS L18371 but does not seal it.
 NORTH: L18371 CONTINUES IN THE BALK UNDER W9065 and may have continued into L182394
 SOUTH: L18371 CONTINUES IN THE UNEXCAVATED PART OF L18339. Possibly F18371 is a continuation of the multiple resurfacings of F18372.
 EAST: F18371 COULD NOT BE SHOWN TO REACH EITHER W9998 OR W9909 YET IT PROBABLY FORMS PART OF THE DOORWAY OF W9909 AND W9998 AND A REACH IS LIKELY. A SIMILAR SITUATION IS GOING ON WITH THE RELATION TO F18239 OR F18370: NO REACH COULD BE ESTABLISHED BUT IS LIKELY.
 WEST: THE FILL OF L18371 REACHES W9998 BUT NOT THE FLOOR could not be traced to the wall. A reach of floor to wall seems likely.
 BELOW: L18371 COVERS BUT DOES NOT SEAL PART OF L18372

* L18370 and L18375 which are a series of floor resurfacings 10+cm in thickness

Additional Observations/Value: LOW VALUE

Locus

18371

11V

Sketch plan

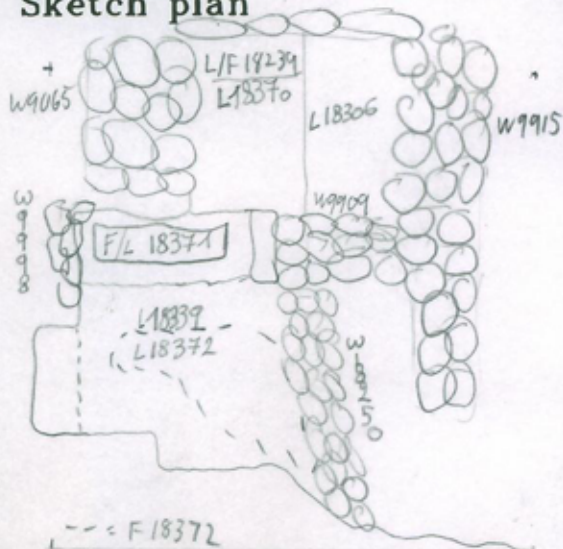

184524



184523



photo

Section



Section



L18249 directly above L18371