

Locus L 18373	Dor 19 ₉₉	Fld G ₁	Sq A.I. 32-33 ₁	Loc. type FILL to floor
Open Date 09/17/99	High at 11.68 S ₁	Low at 11.55 S ₁	Seals: 18418	Sealed by: 18389
Close Date 04/08/99	11.54 N ₁	11.43 S ₁	Loci 18349 18366	above
Floor: type CIP	11.54 M	11.43 S ₁	Loci 18418	below
Length 1.6	Width 1.6	Vol	Written by: KVL	Checked by: JRZ
Value 4	Remove	Drawn? YES		

Unit	Phase	Stage	Stratum	PoM
------	-------	-------	---------	-----

Summary

Opened: L18366 AND THE BALK UNDER W18349 WERE LUMPED TOGETHER AS L18373 TO BRING IT DOWN TO THE LEVEL OF ADJACENT L18365

Limits (N) BALK UNDER W9262

(S) BALK BETWEEN L18373 AND L18374 UNDER W18229

(E) BALK

(W) W18365

Closed: WE CAME DOWN ON F18373

Matrix: DARK GREY SOIL, MOST LIKELY SEVERAL PACKED RESURFACINGS ON TOP OF SOME DEGRADED WHITE FLOOR PATCHES

Relations: ABOVE: L18366 AND W18349 COVER L18373 but do not seal it

NORTH: F18373 CONTINUES IN THE BALK UNDER W9275 and W9262

SOUTH: F18373 CONTINUES INTO THE BALK UNDER W18299 AND, ACCORDING TO ELEVATIONS, POSSIBLY*

EAST: F18373 " " BALK

WEST: L18373 CONTINUES IN L18365. F18373 CONTINUES AS ALONE IN THE NORTH SECTION ABOVE L18365 TO JOIN F18403 IN THE WEST. HOWEVER, F18365 MOST LIKELY IS AN EARLIER**

BELOW: F18373 (= F18365) SEALS L18418

* EQUALS F18383

** RESURFACING OF F18373. I.e. F18373 = F18403, while F18365 is an earlier version of these two floors. THE FLOORS VISIBLE IN THE SECTION WERE NOT SEEN WHILE EXCAVATING L18365 BUT DO FALL WITHIN ITS RANGE.

F18373 IS BELOW THE BASE OF W18229 AND W9915

Additional Observations/Value: HIGH VALUE | SEALING LOCUS

184619



Locus

L 18373

N 1

Sketch plan

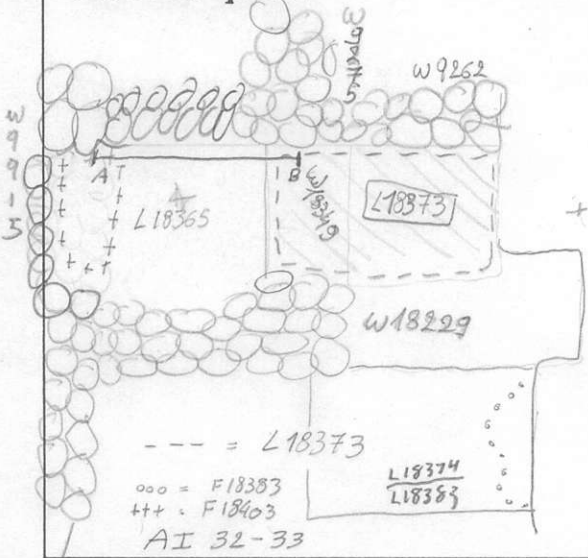

Photo

Photo

Section A-B

Lines of F 18350?

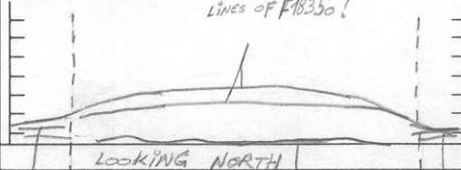

Section

F 18403

F 18365

F 18373

W 18048