

Locus <u>L 18388</u>	Dor <u>19₉₉</u>	Fld <u>G₁</u>	Sq <u>AJ 32</u>	Loc. type <u>FILL TO FLOOR</u>
Open <u>15/07/99</u>	High at <u>11.78</u>	Low at <u>11.71</u>	Seals: <u> </u> <u> </u> <u> </u> <u> </u>	Sealed by: <u> </u> <u> </u> <u> </u> <u> </u>
Close <u>21/07/99</u>	<u>11.76</u>	<u>11.66</u>	Locs <u>18376</u> <u>18377</u>	above <u> </u> <u> </u> <u> </u> <u> </u>
Floor: type <u>cl</u>	<u>11.76</u>	<u>11.66</u>	Photo # (1) <u>184814</u>	Photo # (2) <u>184815</u>
Length <u>2.0</u>	Width <u>1.4</u>	Vol <u>11.66</u>	Written by: <u>KV</u>	Checked by: <u>JRZ</u>
Value <u>u</u>	Remove <u> / / </u>	Drawn? <u>YES</u>	Locs <u>18395</u>	below <u> </u> <u> </u> <u> </u> <u> </u>

Unit	Phase	Stage	Stratum	PoM
------	-------	-------	---------	-----

Summary

Opened: L18376 AND TEST TRENCH L18377 WERE CLOSED, [L18388] WAS OPENED BELOW
L18376
 Limits (N) BALK UNDER W 9909
 (S) L18377
 (E) TEMPORARY BALK
 (W) W18250
 Closed: WE CAME DOWN ON [F18388], [L18388] AND L18377 WERE COLLAPSED INTO L18395

Matrix: DARK GREY TO BROWN SOIL DOWN TO FRAGMENTARY WHITE ASHY FLOOR WITH A POSSIBLE SHALLOW VANSTEENHOUSE PPT IN THE SOUTH. SOME FIST-TO HEADSIZ STONES APPEARED IN THE SOUTH AS RUBBLE

Relations: ABOVE: L18376 COVERS BUT DOES NOT SEAL [L18388]; L18377 CPTS. [L18388]
NORTH: [L18388] CONTINUES IN THE BALK UNDER W 9909 BUT NO FLOOR WAS UPSTAIR IN ITS SECTION
SOUTH: [L18388] CONTINUES IN THE FILL OF L 18377
EAST: [L18388] CONTINUES IN THE TEMPORARY BALK AND MAY EQUAL F ... ??
WEST: [L18388] REACHES W18250 BUT A REACH OF THE FLOOR COULD NOT BE ESTABLISHED, JUST BELOW [L18388], IN L18395, W18250 BEGINS TO FLOAT AND IT IS CLEAR THAT W18250 WAS BUILT ON EARLIER FLOORS OF X
BELOW: [L/F 18388] COVERS BUT DOES NOT SEAL L18395

* the floor sequence L18254 and below.

PHOTO'S: 184816 - 818
 Additional Observations/Value: MEDIUM VALUE, Part of series of multiple floors, Little pottery

18484



Locus
L 18388

Sketch plan

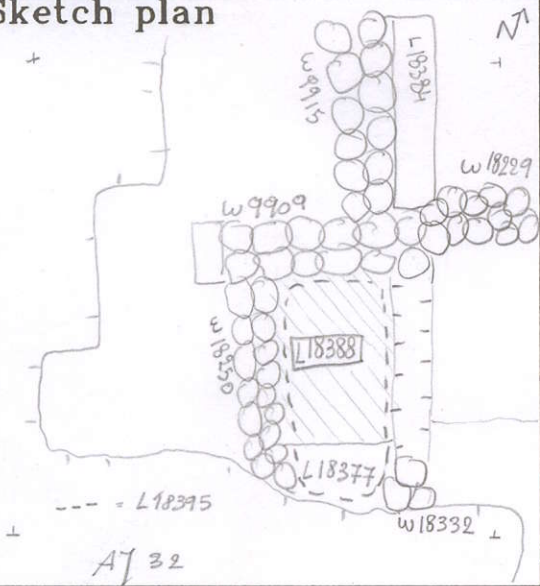

Photo

Section

Section

