

<b>Locus</b> L 18391	<b>Dor</b> 19 <sup>99</sup>	<b>Fld</b> G <sub>1</sub>	<b>Sq</b> A, I, 32,	<b>Loc. type</b> FILL
<b>Open</b> 1.6.17.99	<b>Date</b>	<b>High</b> at 11.46 M	<b>Low</b> at 11.35 CL	<b>Seals:</b>
<b>Close</b> 21.6.19		11.27 N	11.20 S/E	<b>Sealed by:</b>
<b>Floor:</b> type		.	.	<b>Loci</b> 18383
<b>Length</b> 2.6	<b>Width</b> 1.7	<b>Vol</b>   .		<b>above</b>
<b>Value</b> 4	<b>Remove</b>   /   /	<b>Drawn?</b> NO		
<b>Photo #</b> (1)		<b>Photo #</b> (2)		<b>Loci</b> 18396 18397
<b>Written by:</b> K.V.		<b>Checked by:</b> JRZ		<b>below</b>

<b>Unit</b>	<b>Phase</b>	<b>Stage</b>	<b>Stratum</b>	<b>PoM</b>
-------------	--------------	--------------	----------------	------------

**Summary**

**Opened:** L18391 WAS OPENED BELOW THE FRAGMENTARY FLOOR 18383

**Limits (N)** BALK UNDERNEATH W18229  
**(S)** L18334  
**(E)** BALK  
**(W)** L18378

**Closed:** THE MATRIX CHANGED FROM SAND TO BLACK SOIL IN WEST AND PATCHES OF SEVERAL KINDS OF SOIL IN THE EAST, THESE DISTINCTIONS BECAME L18396 (W) AND L18397 (E)

**Matrix:** YELLOW SAND AND SOME SOFT BLACK MATERIAL IN HORIZONTAL LAYERS AND PATCHES

**Relations:** ABOVE: L18383 COVERS BUT DOES NOT SEAL L18391  
 NORTH: L18391 CONTINUES INTO BALK UNDERNEATH W18229, Matrix roughly similar to L18373 N of W18229  
 SOUTH: L18391 CONTINUES INTO L18334  
 EAST: L18391 CONTINUES INTO BALK  
 WEST: L18391 CONTINUES INTO L18378 (= IN ITS FILL ABOVE F 18378)  
 BELOW: L18391 COVERS BUT DOES NOT SEAL L18396 (WEST) AND L18397 (EAST)

**Additional Observations/Value:** LOW VALUE, Unsealed deposit with relatively little pottery

Locus  
L 1839.1

Sketch plan

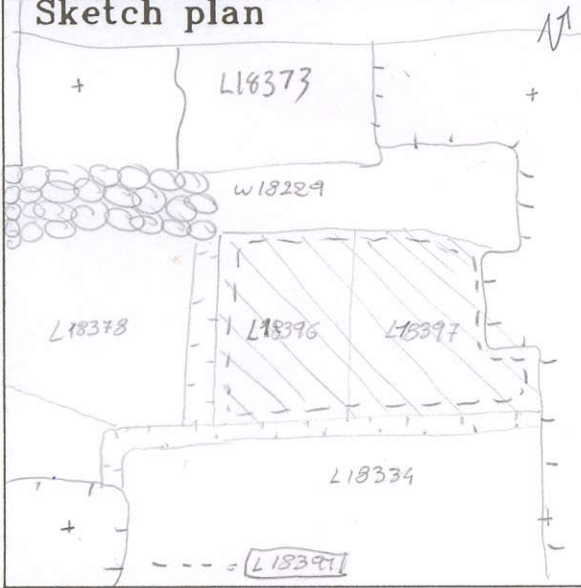

Photo

Photo

Section

Section

