

Locus L 18414	Dor 19 9,9	Fld 9,	Sq AI 31	Loc. type FILL TO FLOOR
Open Date 0.2/08/99	High at 0.9.85 S	Low at 0.9.77 N	Seals: _____	
Close Date 0.6/08/99	0.9.40 E	0.9.05 C	Sealed by: _____	
Floor: type c1e	0.9.15 CN	0.9.05 ME	Loci 18401	
Length 2.5	Width 2.1	Vol _____	above _____	
Value 4	Remove _____	Drawn? YES	below _____	
Photo #(1) _____	Photo #(2) _____	Loci _____		
Written by: KV	Checked by: JRZ	below _____		

Unit _____	Phase _____	Stage _____	Stratum _____	PoM _____
------------	-------------	-------------	---------------	-----------

Summary \_\_\_\_\_

Opened: L18401 CAME DOWN ON A BLACK ASH LAYER IN NE CORNER. WE CLOSED 18401 AND OPENED L18414 BELOW IT

Limits (N) UNEXCAVATED FILL  
 (S) BALK  
 (E) L18399  
 (W) BALK

Closed: WE CAME DOWN ON A SURFACE (FLOOR?) AND IT WAS THE END OF THE SEASON  
 (THIS SURFACE HAS NOT ENTIRELY BEEN TRACED AND CAN ONLY BE RECOGNISED THROUGH THE PANCAKE-METHOD)

Matrix: SEVERAL LENSES OF GRAVEL LIKE CERAMICS AND BIG BONES IN BETWEEN 5-10 CM THICK DARK- GREY-BROWN SAND DOWN TO A 7-10 CM THICK WET CLAYEY MUDBRICK MATERIAL ON TOP OF A SANDY SURFACE MIXED WITH GREY MUDBRICK. SINCE IT "PANCAKES" VERY EASY, THIS DEFINITELY MUST HAVE BEEN A SAND PLUS MANY SHERDS ARE ON TOP OF THE "FLOOR"

Relations: ABOVE: L18401 COVERS BUT DOES NOT SEAL L18414  
 NORTH: L18414 CONTINUES INTO UNEXCAVATED FILL  
 SOUTH: L18414 CONTINUES INTO THE BALK  
 EAST: L18414 IS CUT BY PIT L18399  
 WEST: L18414 CONTINUES INTO THE BALK  
 BELOW: NO RELATIONS (END OF SEASON)

Additional Observations/Value: HIGH VALUE: FIRST (and last?) LB FLOOR



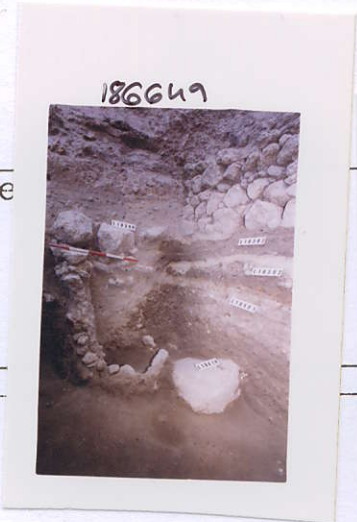

Locus  
L 18414

Sketch plan

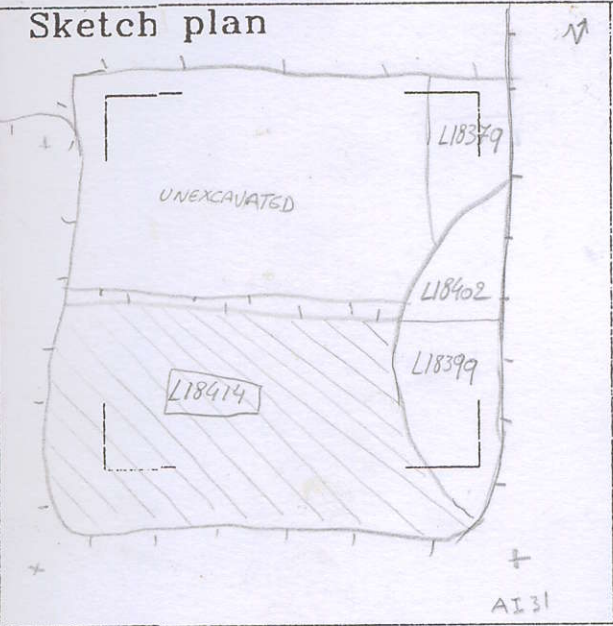

PHOTO