

Locus <u>L18420</u>	Dor 19 <u>99</u>	Fld <u>G</u>	Sq <u>AI, 3, 2, 1, 1, 1</u>	Loc. type <u>FILL</u>
Open	Date <u>05/08/99</u>	High at <u>1.0 · 5.3 S/E</u>	Low at <u>0.9 · 9.3 NW</u>	Seals: <u> </u> <u> </u> <u> </u> <u> </u>
Close	<u>09/08/99</u>	<u>1.0 · 0.0 E</u>	<u>0.9 · 8.5 N/E</u>	Sealed by: <u>18415</u> <u> </u> <u> </u>
Floor: type <u>1</u>	Length <u>2.3</u>	Width <u>1.7</u>	Vol <u> </u>	Loci <u>18415</u> <u> </u> <u> </u> <u> </u>
Value <u>5</u>	Remove <u>1/1/1</u>	Drawn? <u>N.O.</u>		above <u> </u> <u> </u> <u> </u> <u> </u>
Photo #(1) _____	Photo #(2) _____			Loci _____
Written by: <u>KV</u>	Checked by: <u>JRZ</u>			below <u> </u> <u> </u> <u> </u> <u> </u>

Unit _____	Phase _____	Stage _____	Stratum _____	PoM _____
------------	-------------	-------------	---------------	-----------

Summary

Opened: THE DESTRUCTION MATERIAL DISAPPEARED AND A SANDY SLOPE APPEARED (= L18420)

Limits (N)

(S) BALK
UNEXCAVATED FILL UNDERNEATH L18334

(E) BALK

(W) UNEXCAVATED FILL UNDERNEATH L18416

Closed: END OF SEASON (NOT CLOSED)

Matrix: BROWN SAND WITH SPORADIC LENSES OF DESTRUCTION MATERIAL

Relations: ABOVE: L18415 SEALS [L18420]; there were no intrusions through the redeposited destruction material*

NORTH: [L18420] CONTINUES INTO THE BALK

SOUTH: [L18420] CONTINUES INTO UNEXCAVATED FILL BELOW L18334

EAST: [L18420] CONTINUES INTO THE BALK

WEST: [L18420] CONTINUES INTO UNEXCAVATED FILL BELOW L18416

BELOW: NO RELATIONS (END OF SEASON); not closed

* of L18415

Additional Observations/Value:

High VALUE: Lb material sealed below destruction debris.

Locus
L1 18420

Sketch plan

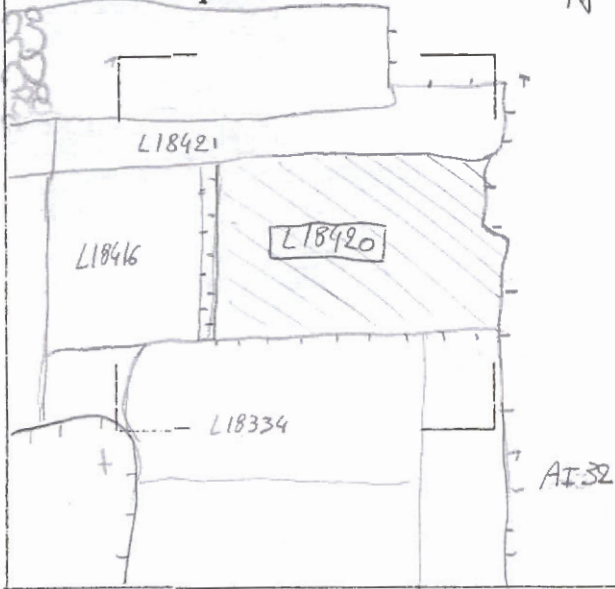

Photo

Photo

Section

Section

